



INSTRUCTION DE MONTAGE  
MONTAGEANLEITUNG  
INSTRUCTIONS FOR ASSEMBLY  
INSTRUCCIONES DE MONTAJE

# MOVENTIV<sup>®</sup> 80 GLASS

Poids maximal de la porte  
Maximales Gewicht der Tür  
Maximum weight of the door  
Peso máximo de la puerta

**80 KG**

PORTE D'INTÉRIEUR MOTORISÉE  
INNENTÜR MIT ELEKTRO-ANTRIEB  
INTERIOR AUTOMATIC DOOR  
PUERTA DE INTERIOR MOTORIZADA



**MOVENTIV<sup>®</sup> 80**  
by MANTION



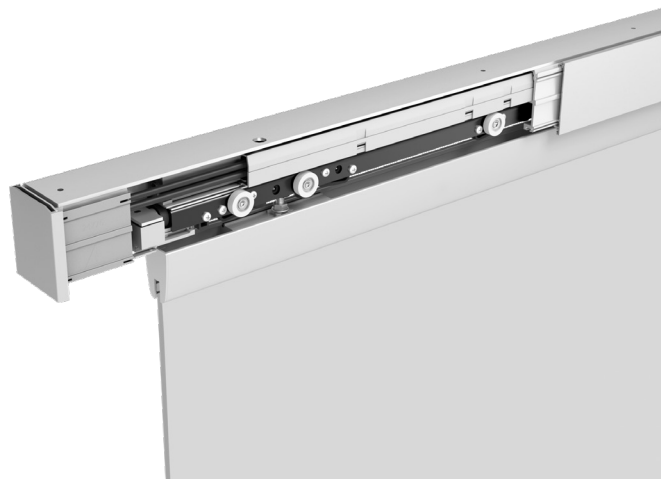
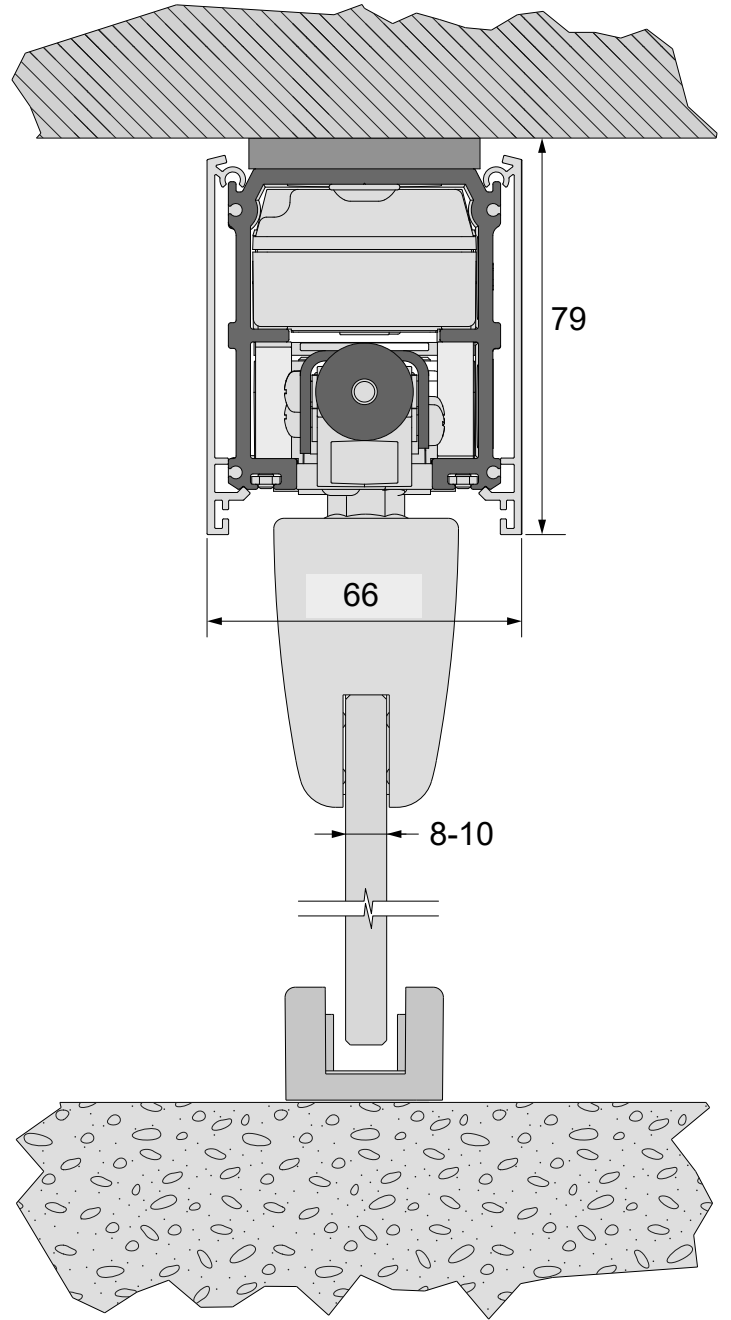
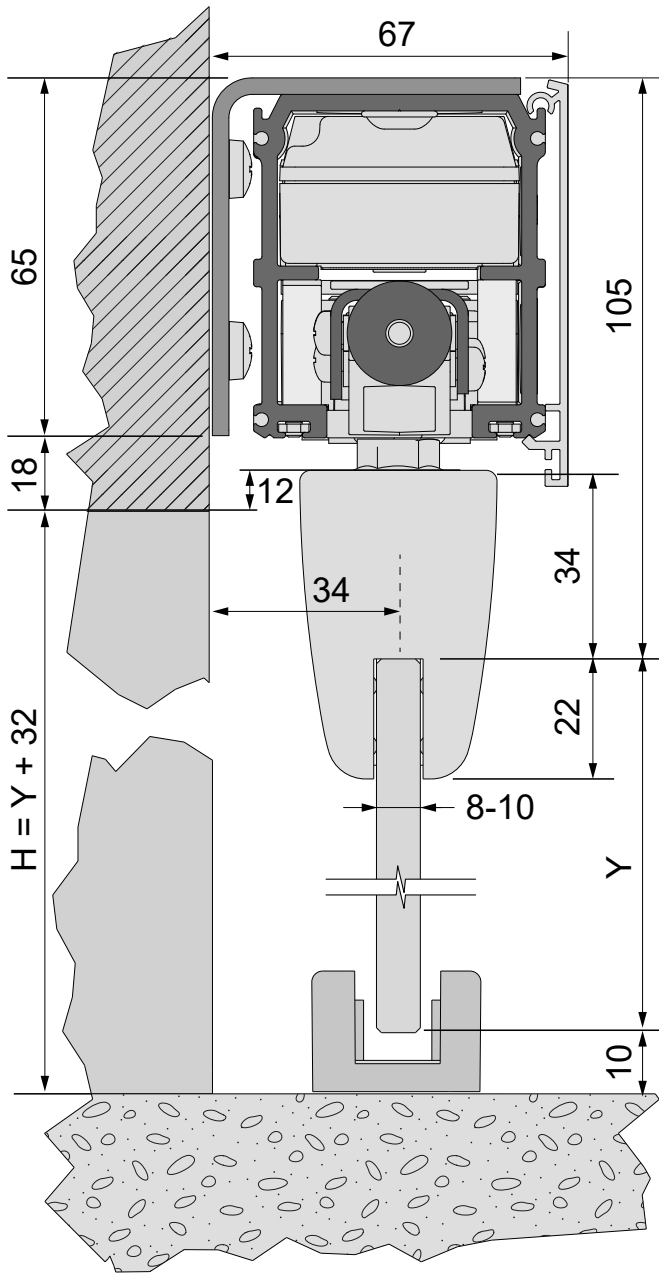

CONDITIONS DE POSE / MONTAGEBEDINGUNGEN / INSTALLATION REQUIREMENTS /  
CONDICIONES DE COLOCACION:

- Produit destiné à une utilisation en intérieur / Dieses Produkt ist nur für Innenanwendung geeignet / For indoor use only / Producto para utilización en interior
- Ne pas installer dans des endroits humides / Nicht in feuchten Atmosphären verwenden / Do not install in humid places / No instalar en lugares húmedos
- Le montage doit être effectué par des monteurs qualifiés / Die Montage muss von qualifizierten Handwerkern geführt werden / Instalation must be performed by skilled personnel / el montaje tiene que hacerse por instaladores cualificados

OUTILLAGE NÉCESSAIRE A LA POSE / BENÖTIGTE WERKZEUGE / REQUIRED TOOLS FOR  
ASSEMBLY / HERRAMIENTA NECESARIA PARA LA COLOCACIÓN:

- Mètre / Metermass / Measuring tape / Flexometro
- Visseuse/perceuse à percussion (selon type de support) / Einschraubmaschine / Schlagbohrer (je nach dem Wandmaterial) / Percussion drill (if needed) / Atornillador / taladro de percusión (en función del soporte)
- Niveau à bulle / Wasserwaage / Water level tool / Nivel de burbuja
- Clés BTR de 2.5 et 3 / Schlüssel / Allen wrenches (2.5 and 3 mm) / Llave Allen de 2.5 y 3

DIMENSIONS / MASSE / SIZING / DIMENSIONES (mm):

Epaisseur panneau / Paneelstärke / Panel thickness / Grueso del panel: **8-10 mm**

Poids panneau / Paneelgewicht / Panel weight / Peso panel: **80 Kg MAX**

Caractéristiques alimentation / Versorgung / Power supply output current rate / Características de la alimentación: **110/230V AC - 50/60 Hz**

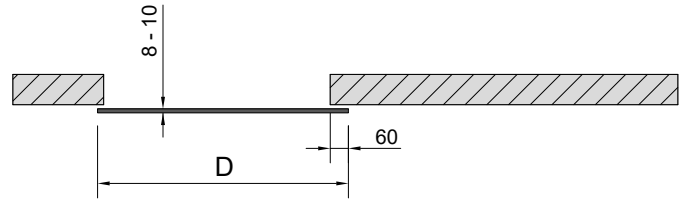
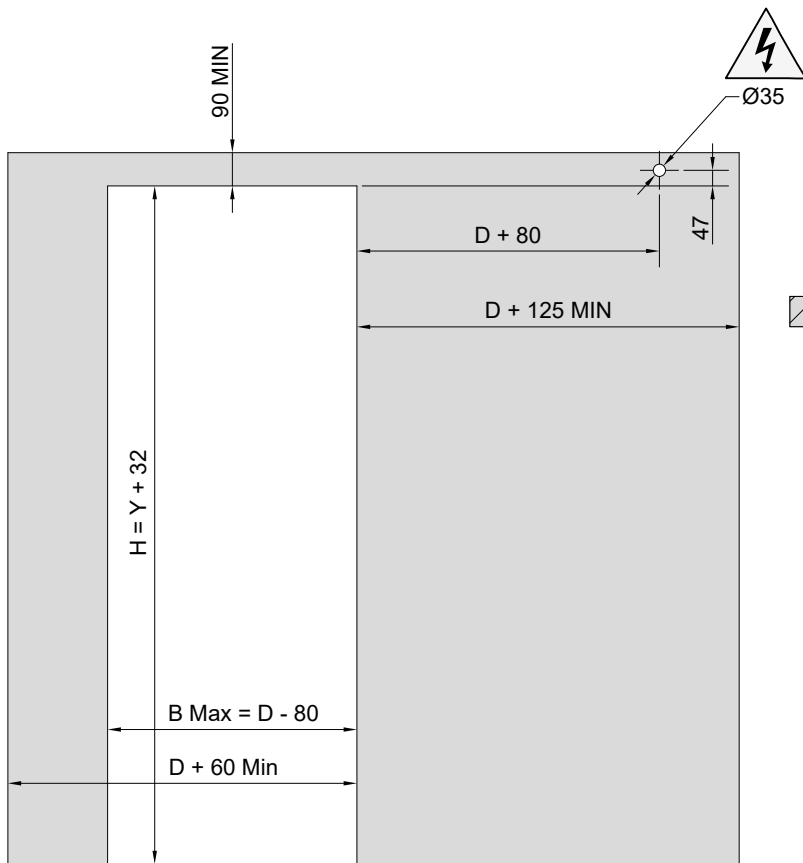

KIT	D (mm)	B Max (mm)
<b>K0001520</b>	830	750
<b>K0001530</b>	930	850
<b>K0001540</b>	1030	950
<b>K0001550</b>	1130	1050

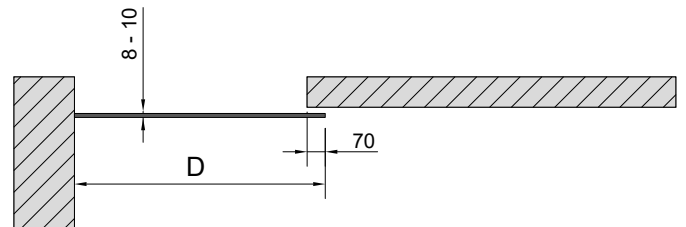
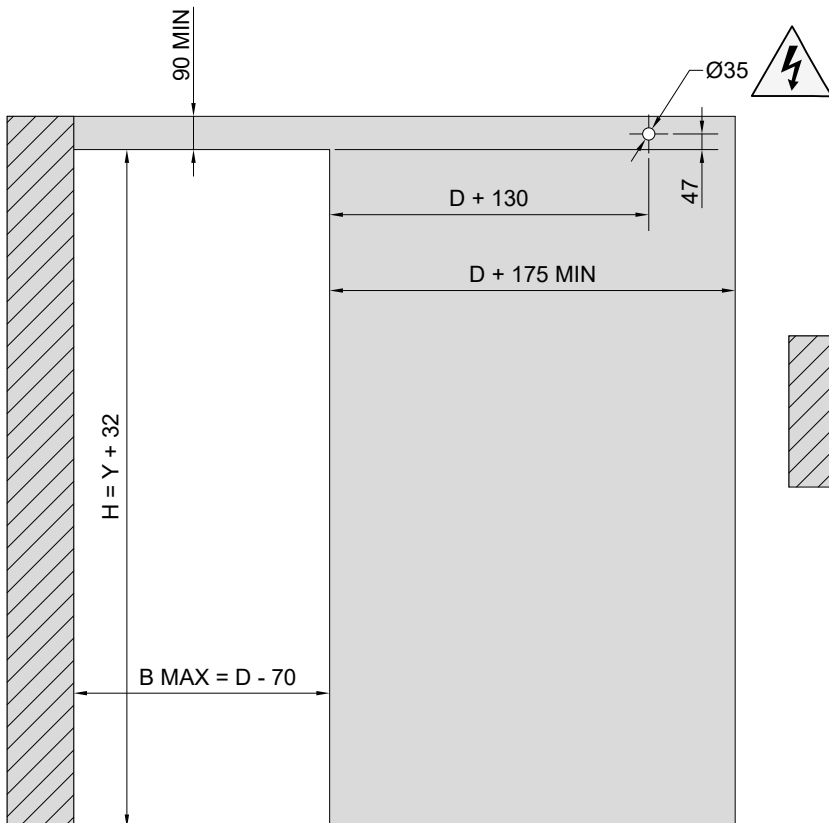
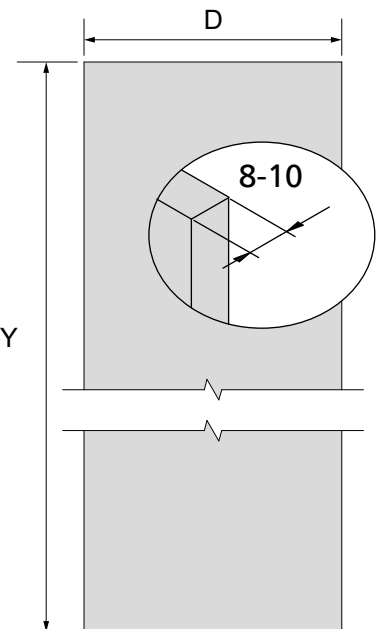
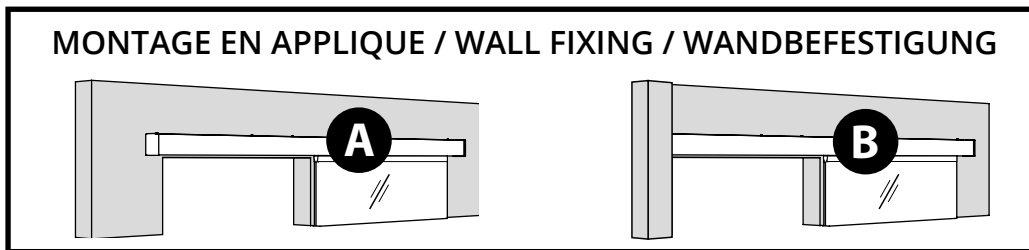

KIT	D (mm)	B Max (mm)
<b>K0001520</b>	840	770
<b>K0001530</b>	940	870
<b>K0001540</b>	1040	970
<b>K0001550</b>	1140	1070

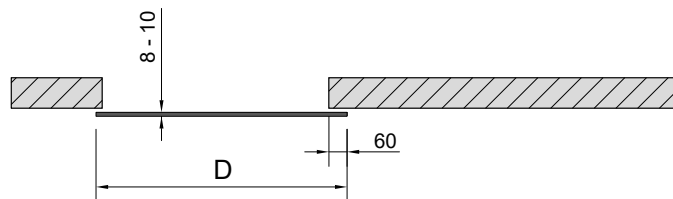
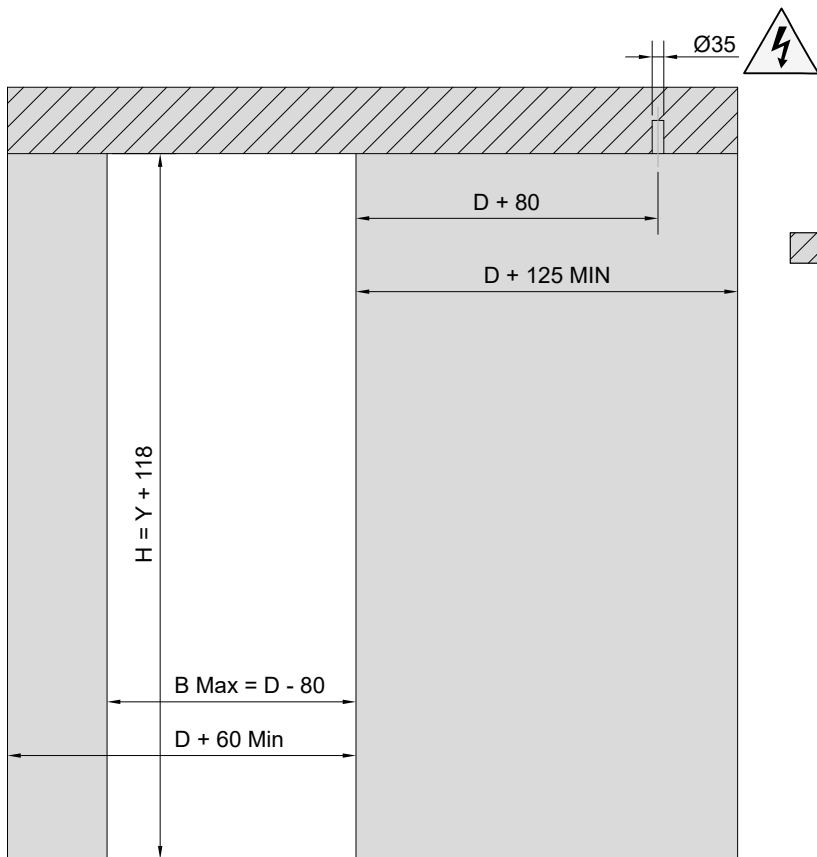

KIT	D (mm)	B Max (mm)
<b>K0001520</b>	830	750
<b>K0001530</b>	930	850
<b>K0001540</b>	1030	950
<b>K0001550</b>	1130	1050

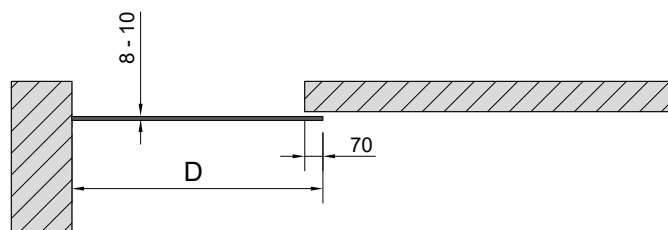
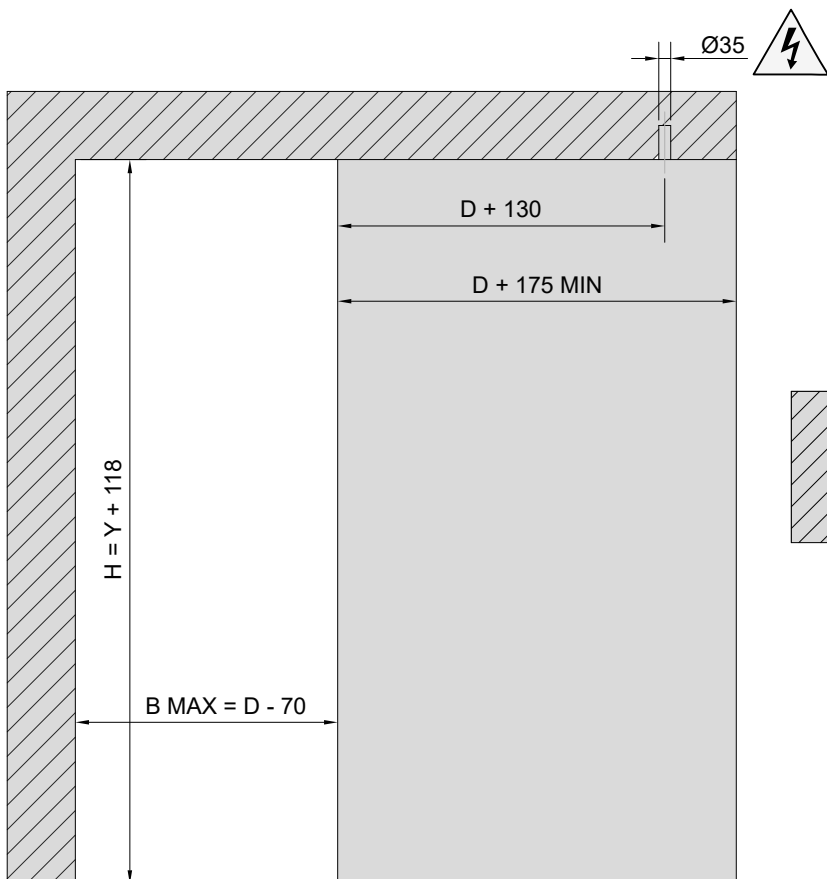
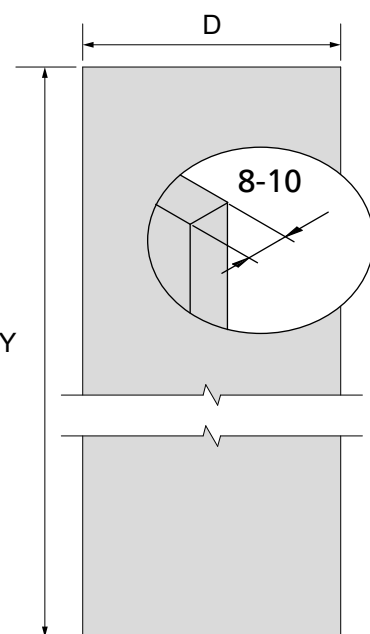
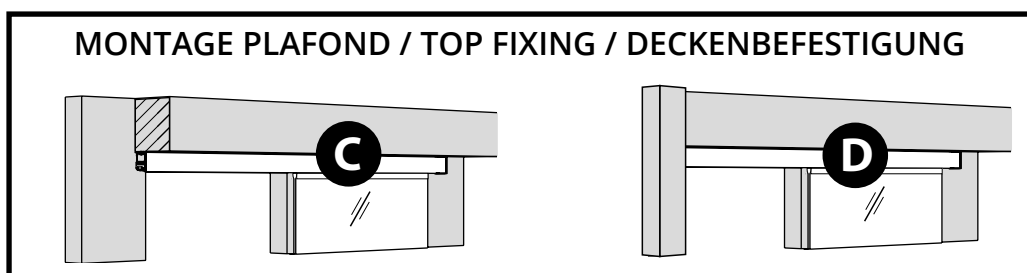

KIT	D (mm)	B Max (mm)
<b>K0001520</b>	840	770
<b>K0001530</b>	940	870
<b>K0001540</b>	1040	970
<b>K0001550</b>	1140	1070

# 1.

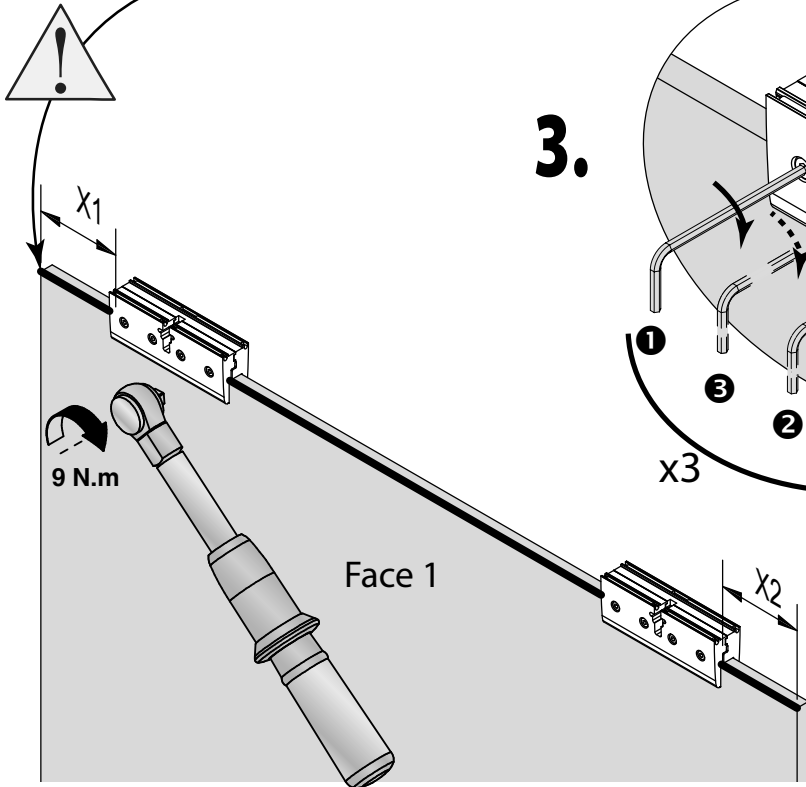
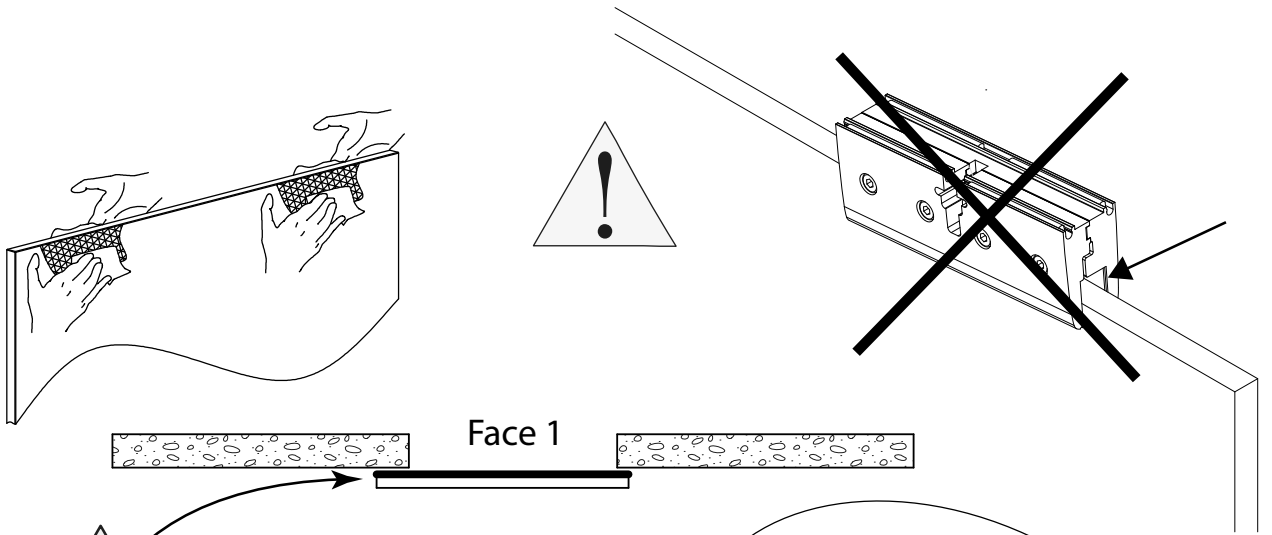

# 3.

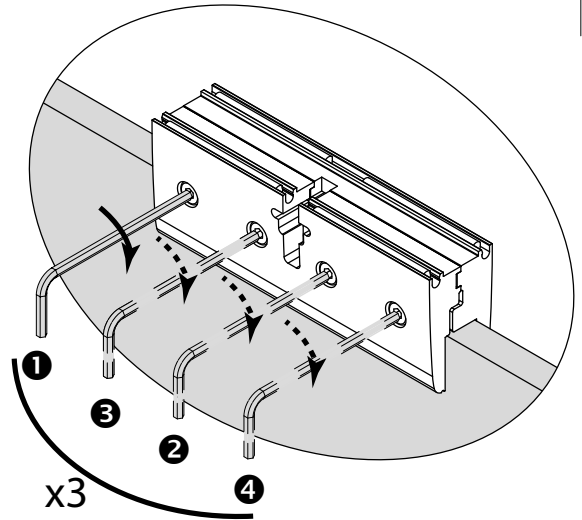

# 2.

## A & C

KIT	Y	X1	X2
<b>K0001520</b>	469	55,5	55,5
<b>K0001530</b>	565	57,5	57,5
<b>K0001540</b>	677	51,5	51,5
<b>K0001550</b>	773	53,5	53,5

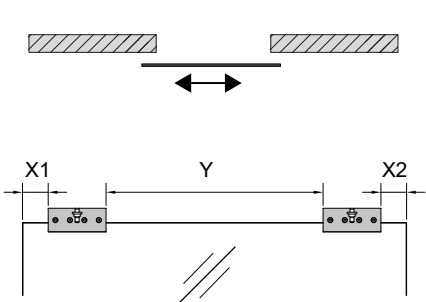

## B & D

KIT	Y	X1	X2
<b>K0001520</b>	469	20,5	100,5
<b>K0001530</b>	565	22,5	102,5
<b>K0001540</b>	677	16,5	96,5
<b>K0001550</b>	773	18,5	98,5

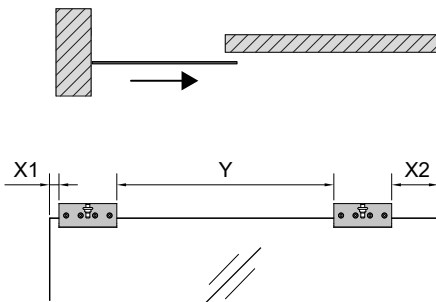

KIT	Y	X1	X2
<b>K0001520</b>	469	100,5	20,5
<b>K0001530</b>	565	102,5	22,5
<b>K0001540</b>	677	96,5	16,5
<b>K0001550</b>	773	98,5	18,5

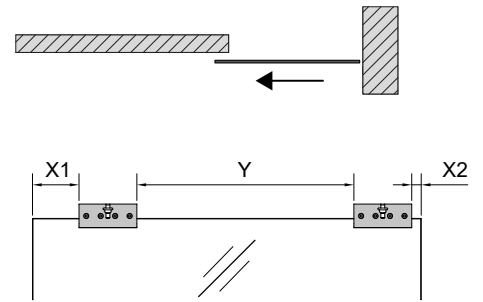

4.

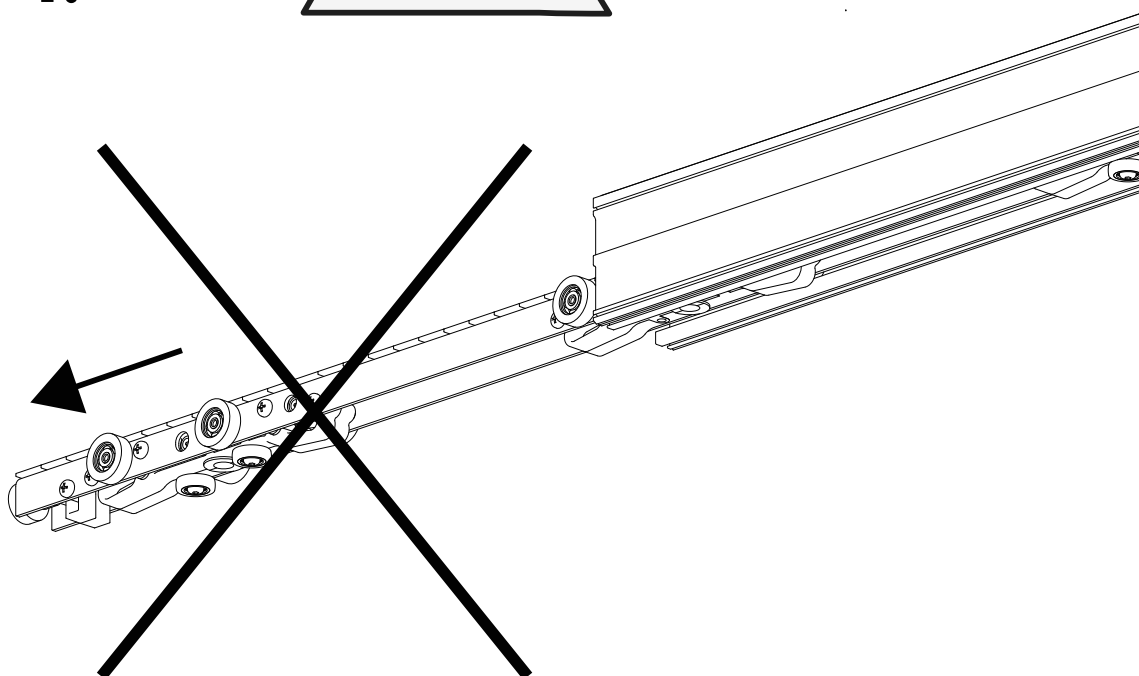

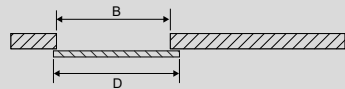
**A**

KIT	D (mm)	B Max (mm)
K0001520	830	750
K0001530	930	850
K0001540	1030	950
K0001550	1130	1050

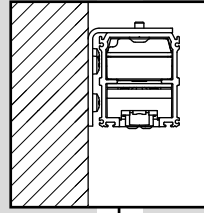
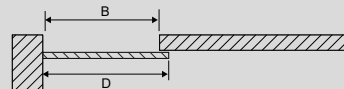
**B**

KIT	D (mm)	B Max (mm)
K0001520	840	770
K0001530	940	870
K0001540	1040	970
K0001550	1140	1070

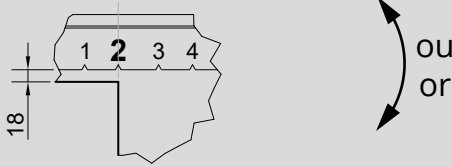
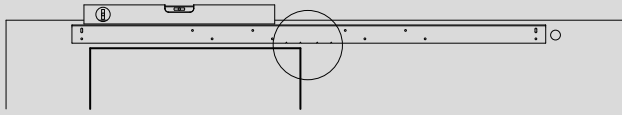
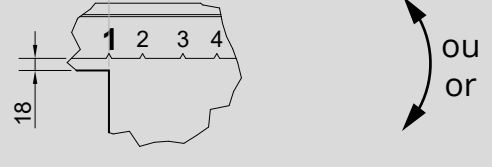
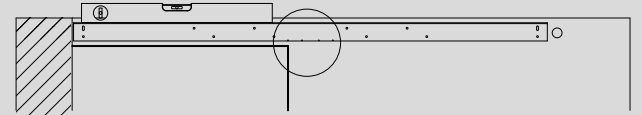
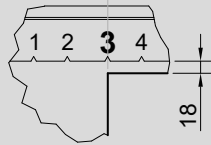
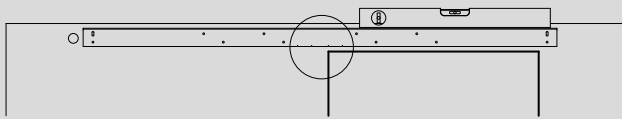
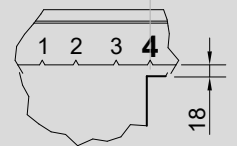
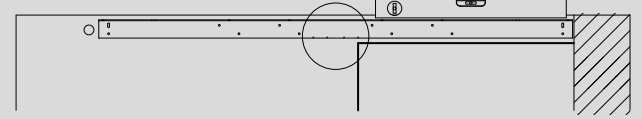
ou  
orou  
or**5.**

TR 6x30 (12x)

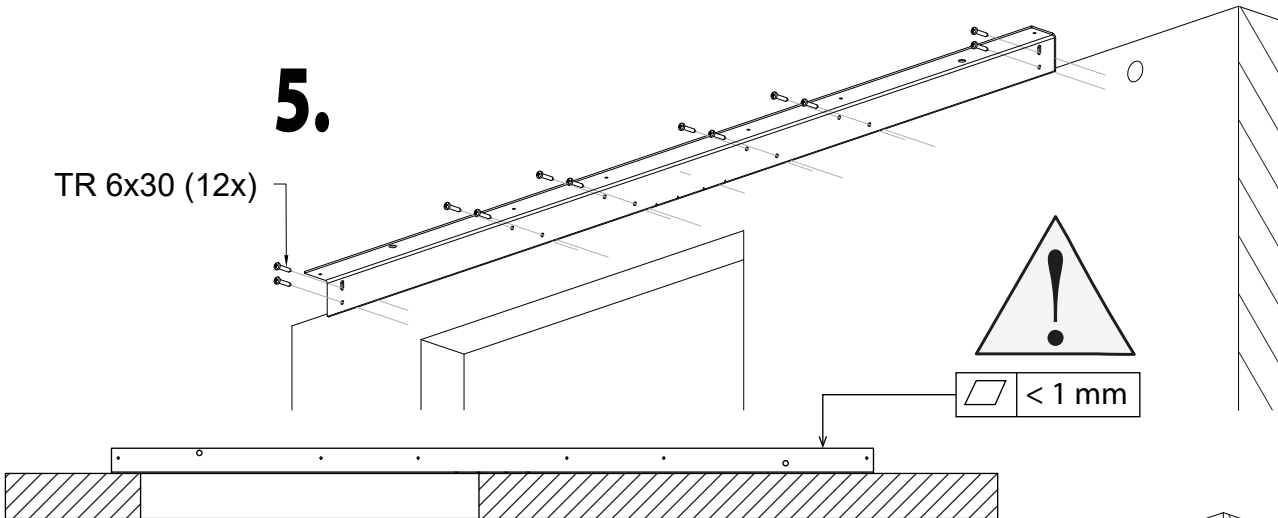
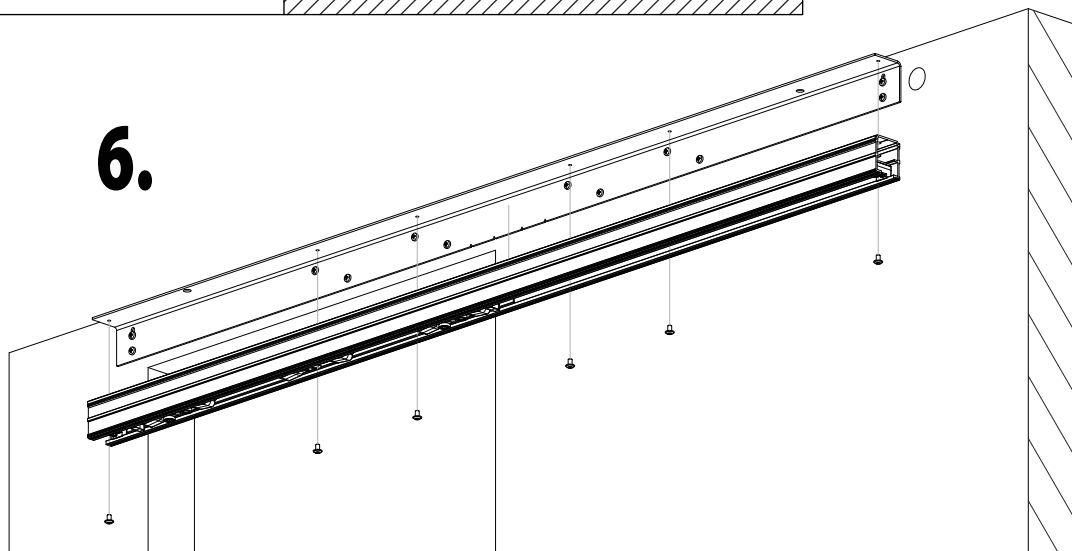
**6.**

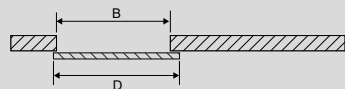

**C**

KIT	D (mm)	B Max (mm)
<b>K0001520</b>	830	750
<b>K0001530</b>	930	850
<b>K0001540</b>	1030	950
<b>K0001550</b>	1130	1050

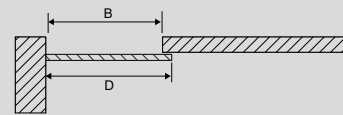
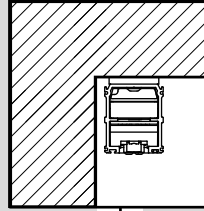

KIT	D (mm)	B Max (mm)
<b>K0001520</b>	840	770
<b>K0001530</b>	940	870
<b>K0001540</b>	1040	970
<b>K0001550</b>	1140	1070

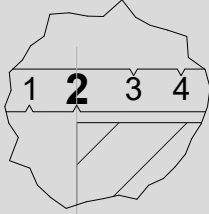
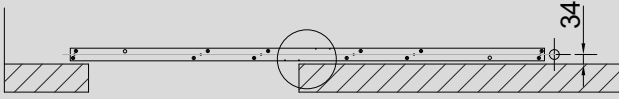
**D**

ou  
or

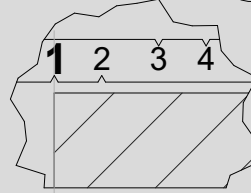
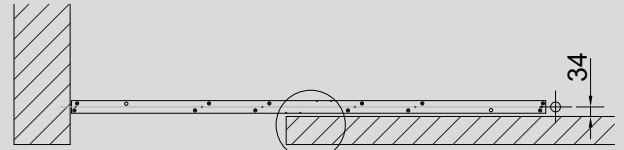
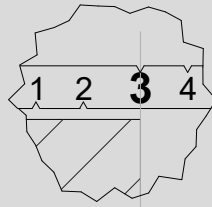
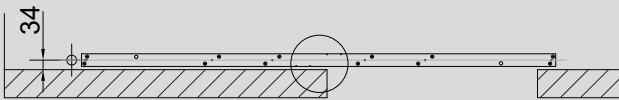

ou  
or

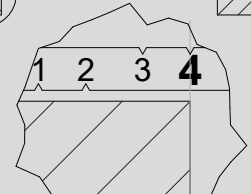
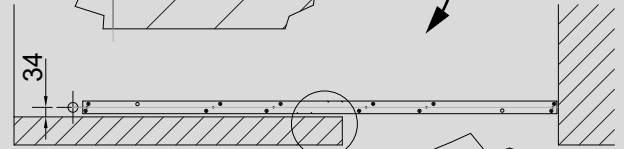
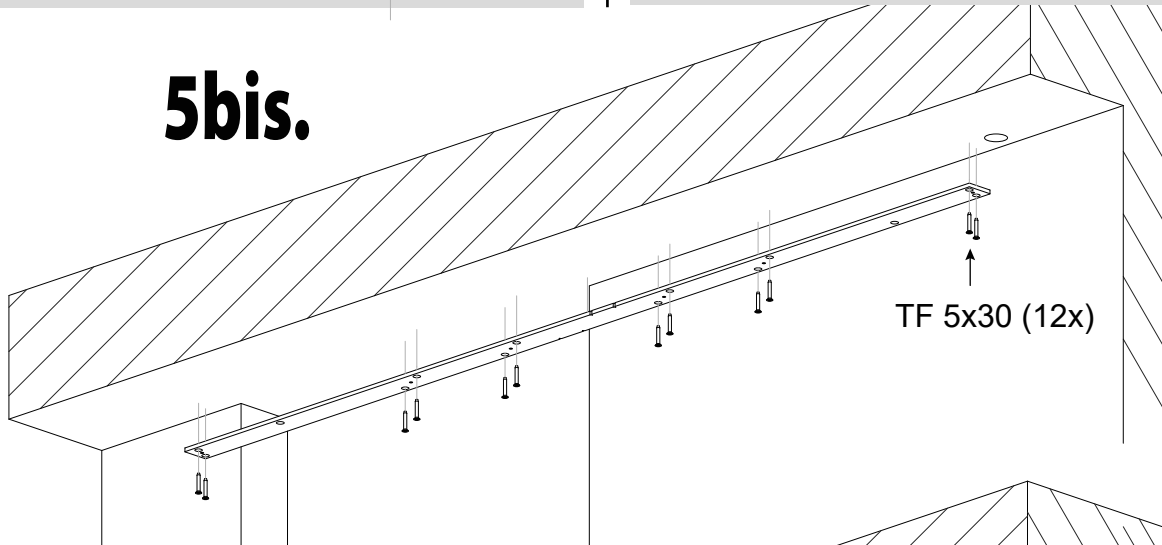
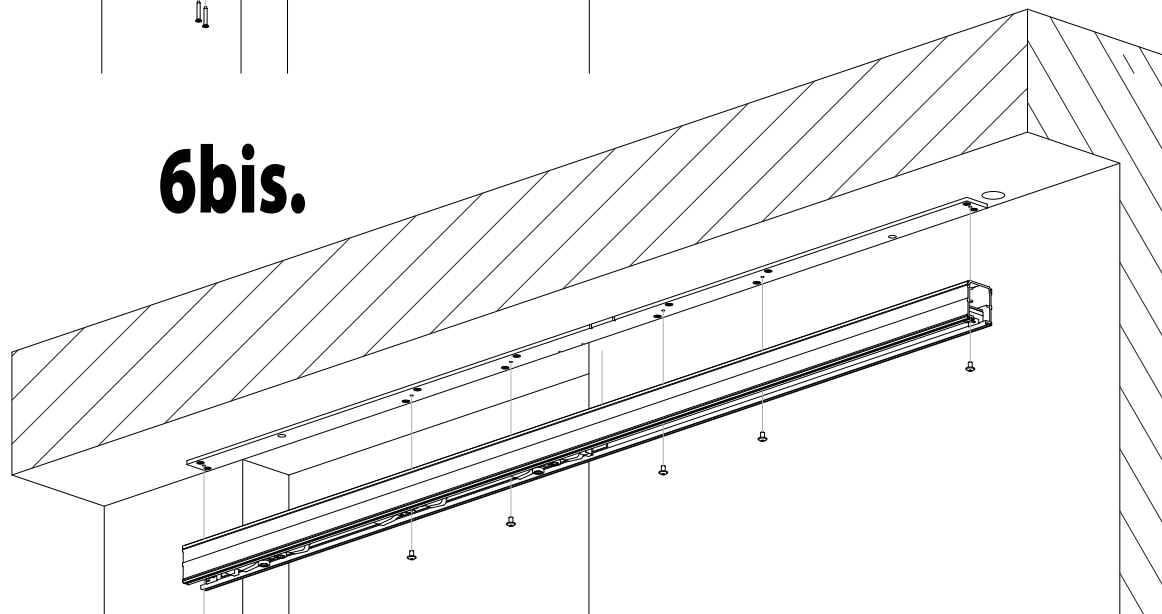
**5bis.****6bis.**

7.

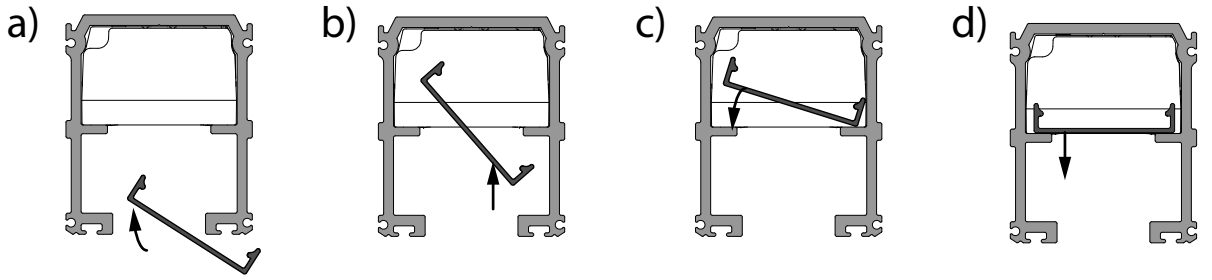
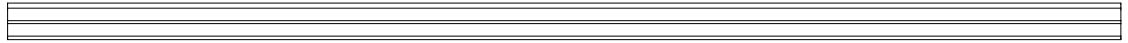

8.

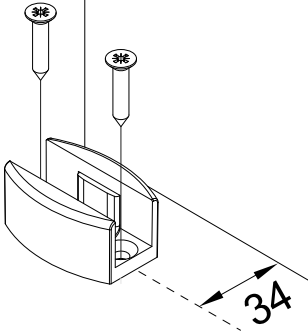

9.

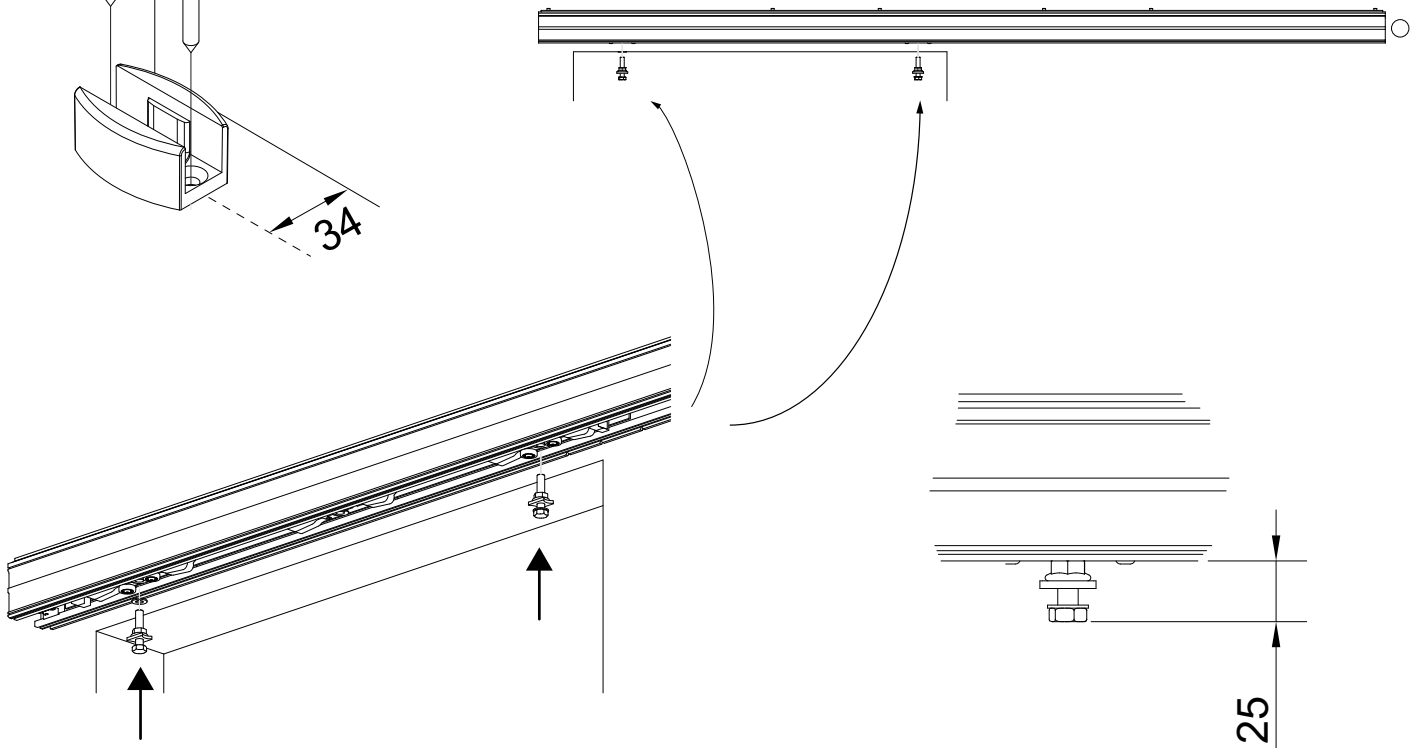

10.

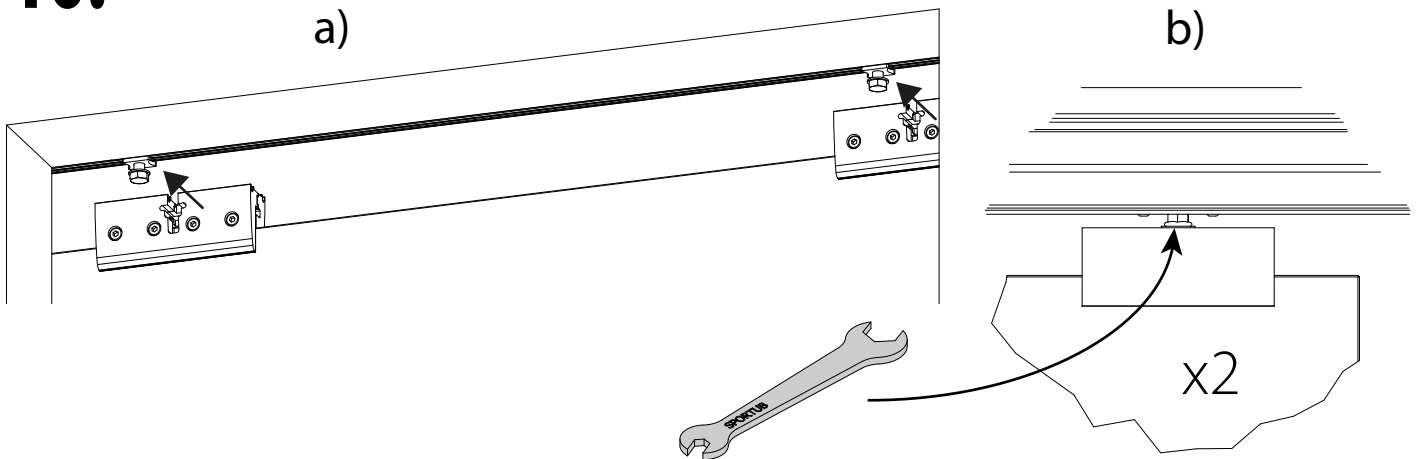

**11.**

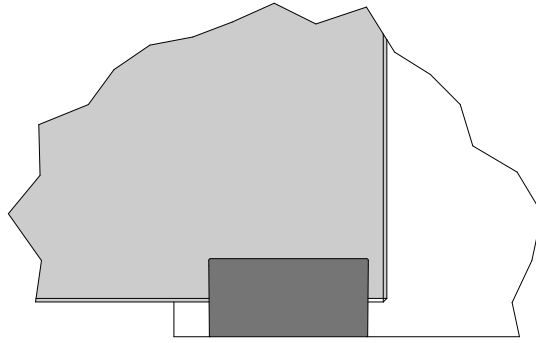

**12.**

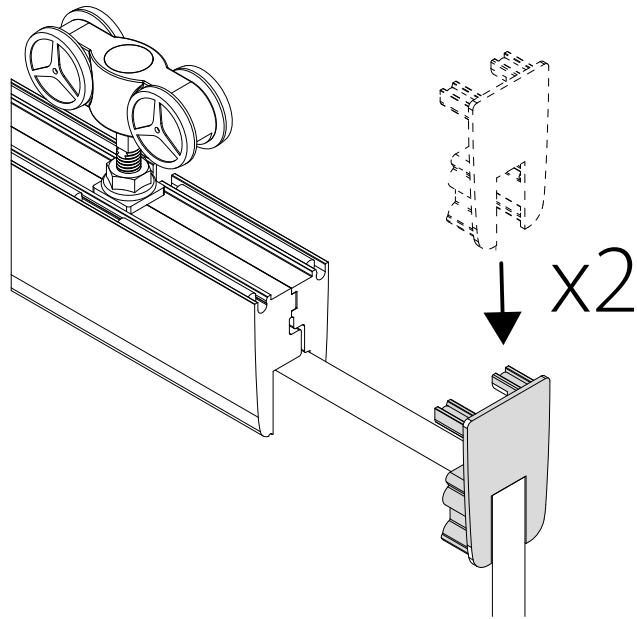

**13.**

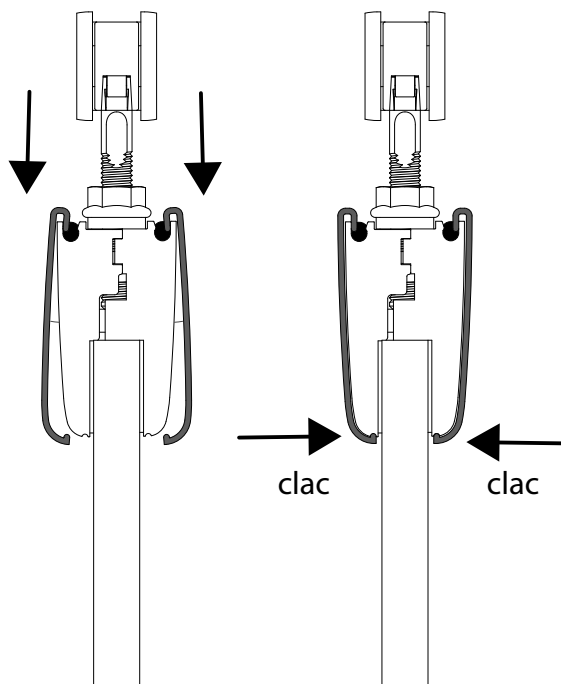

## 14.

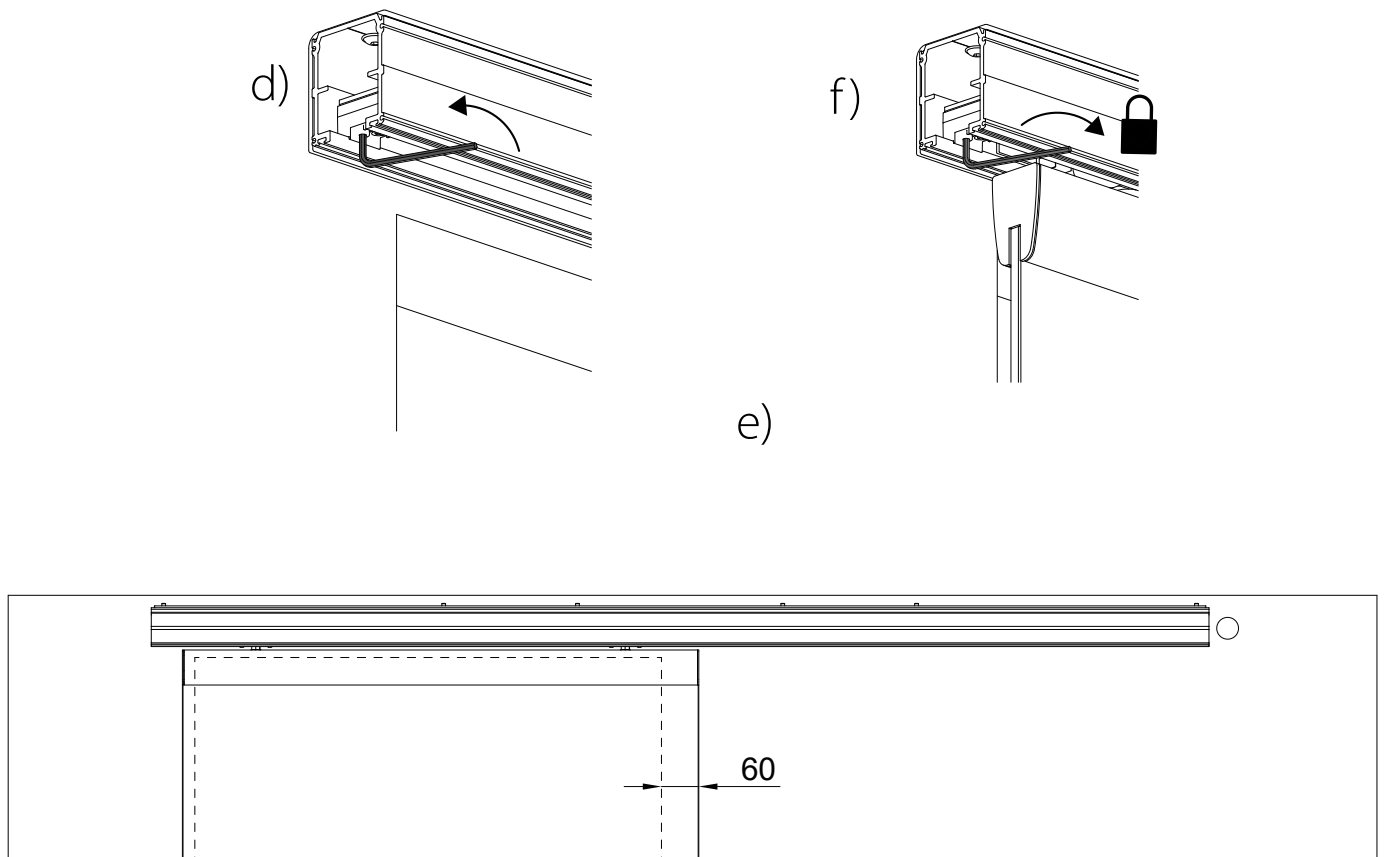
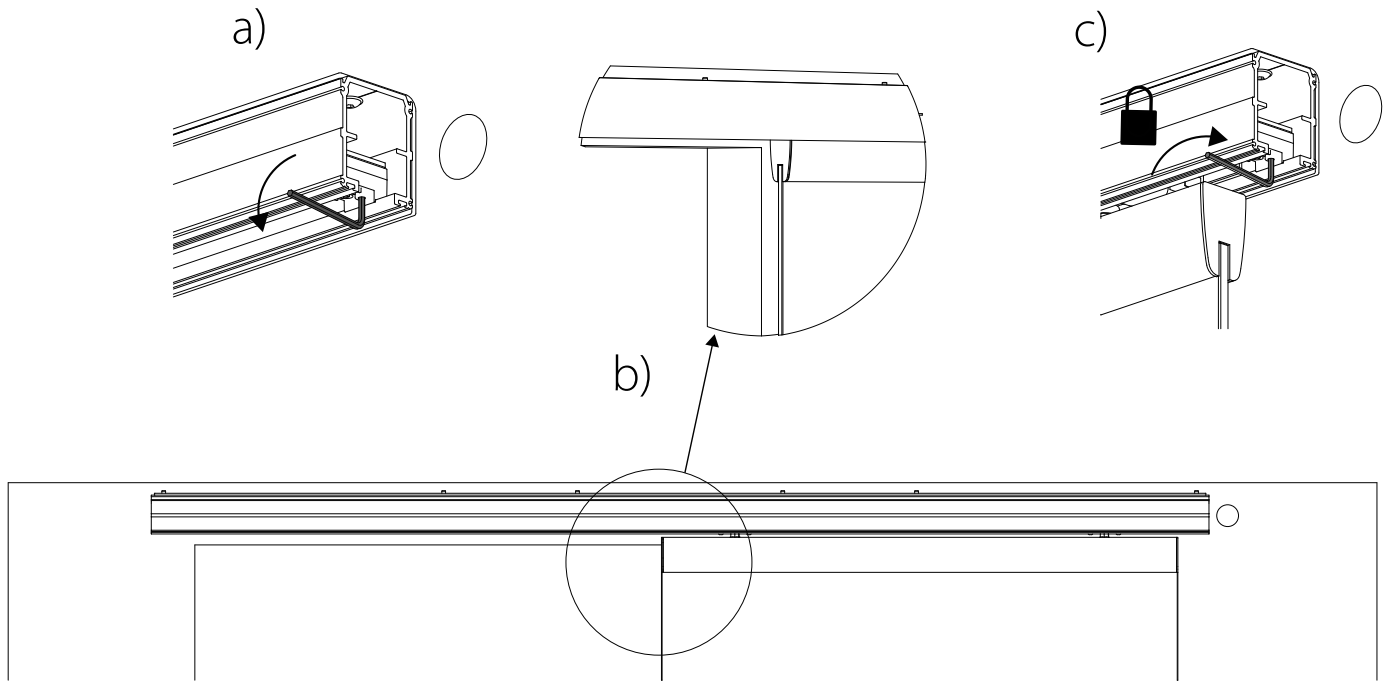

## 14bis.

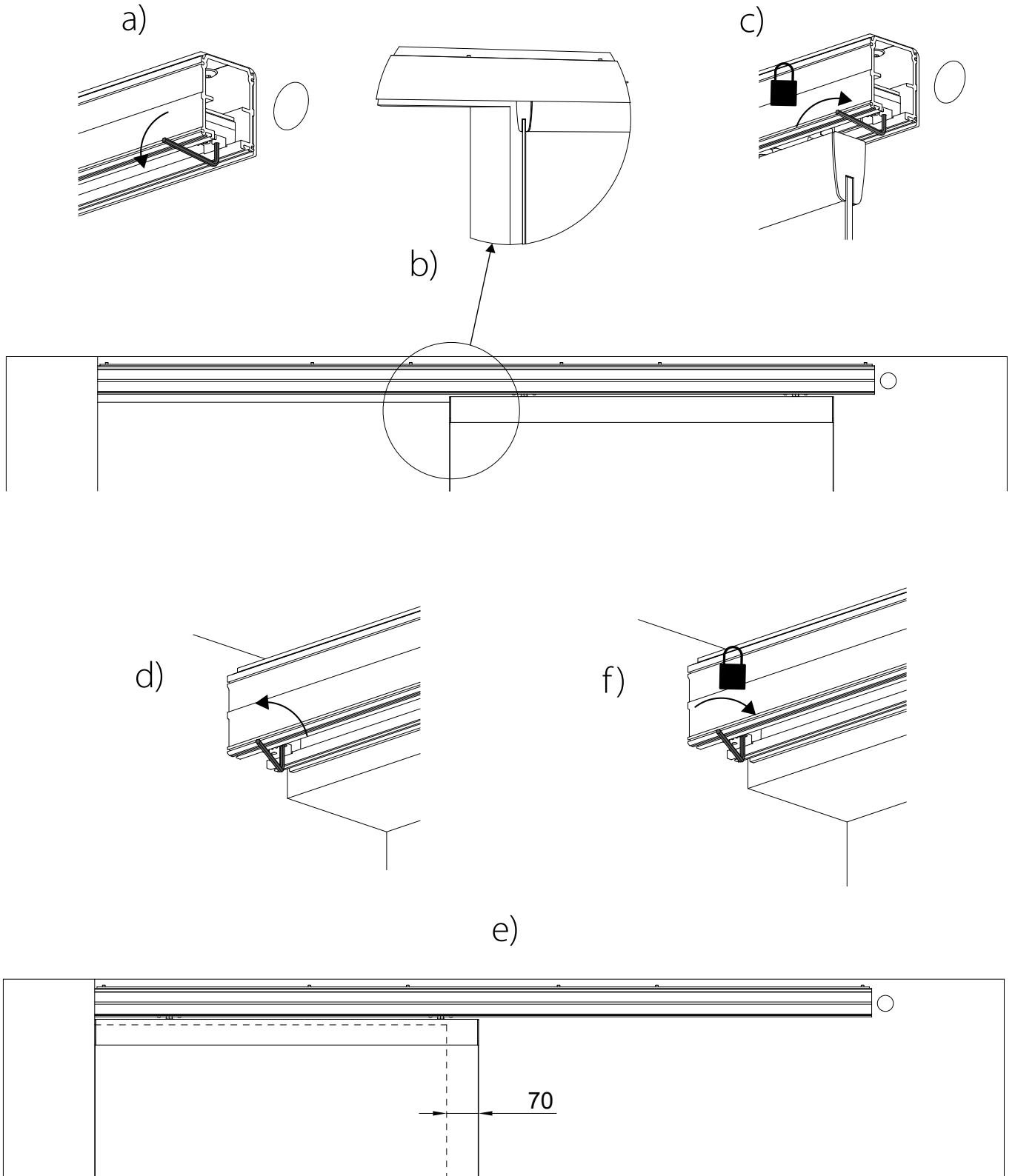

**15.**

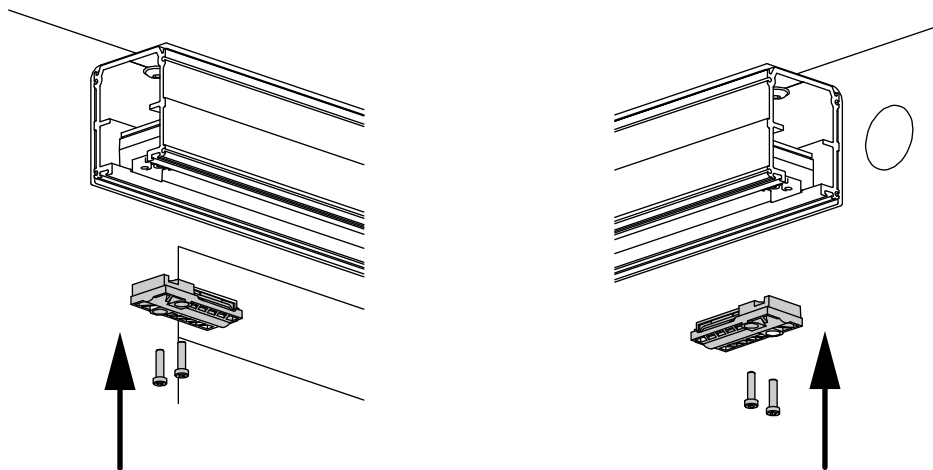

**16.**

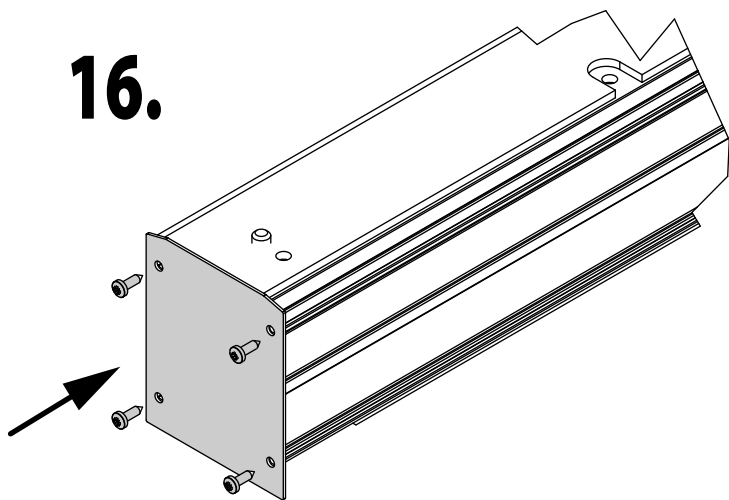

**17.**

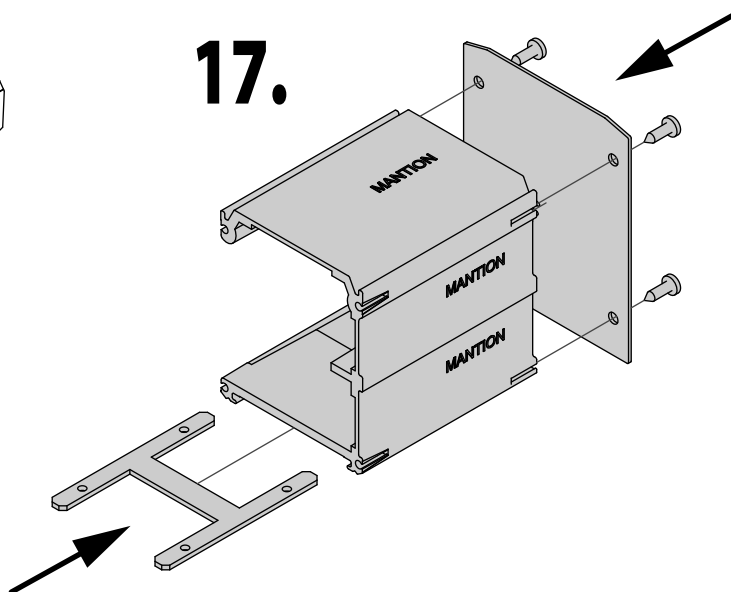

**18.**

VOIR MANUEL DE MISE EN SERVICE  
SEE OPERATING INSTRUCTIONS  
SIEHE BETRIEBSANLEITUNG  
VER LAS INSTRUCCIONES DE USO

**19.**

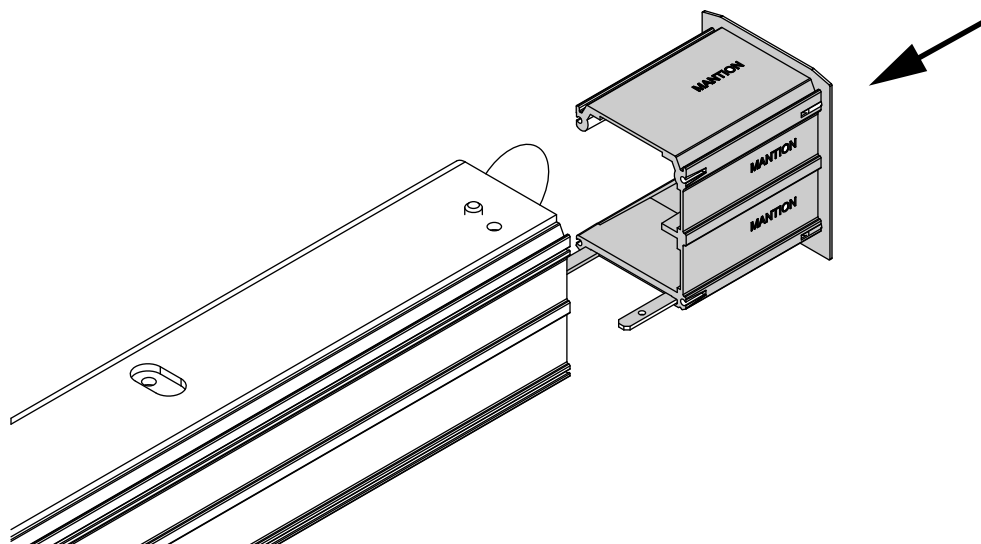

**20.**

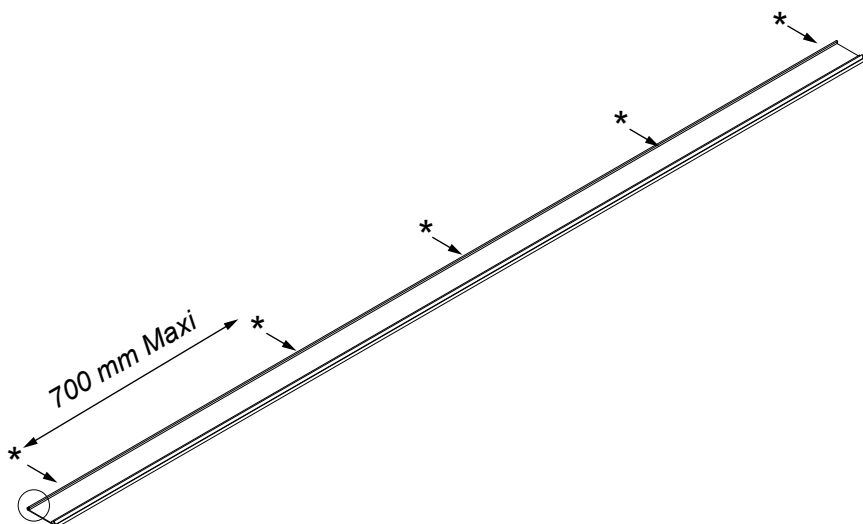
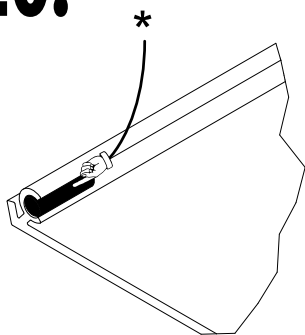

**21.**

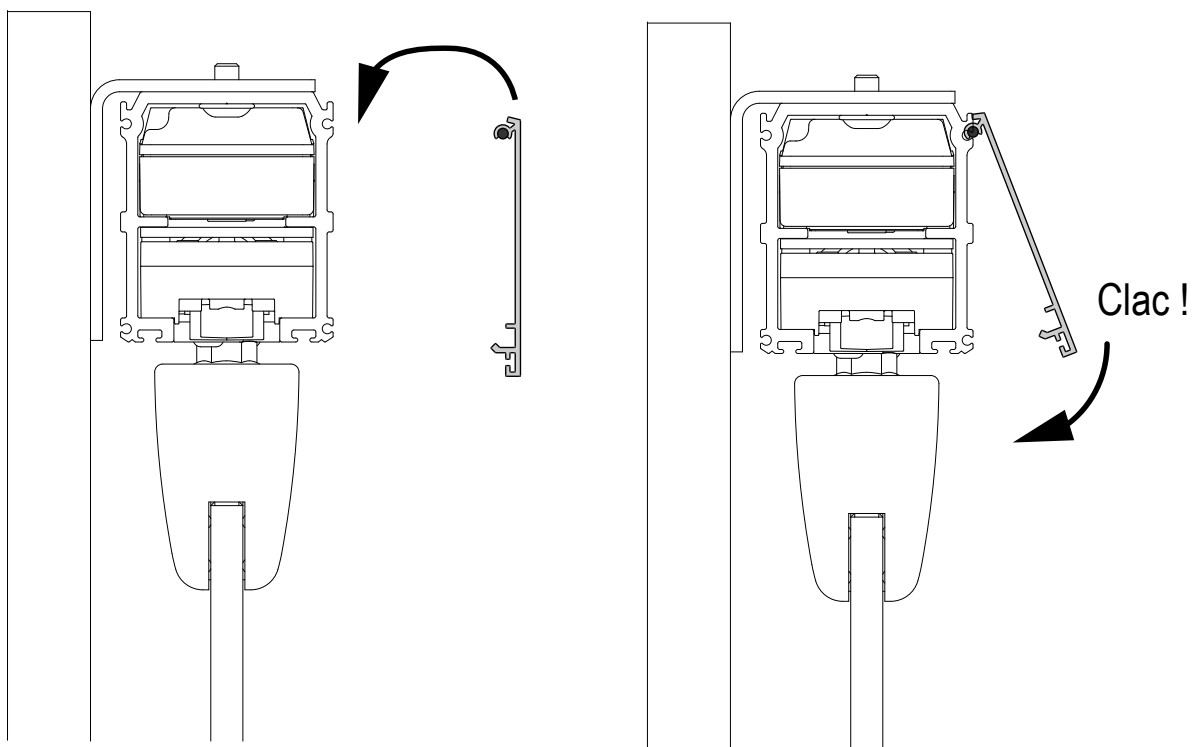

**22.**

