

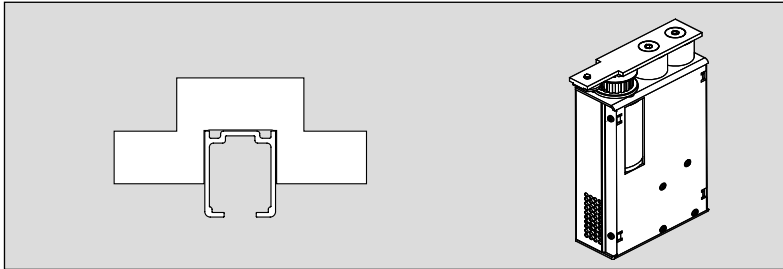

INSTRUCTION DE MONTAGE
MONTAGEANLEITUNG
INSTRUCTIONS FOR ASSEMBLY
INSTRUCCIONES DE MONTAJE

WIDOOR INSIDE porte en bois

PORTE ENTRE-CLOISONS: 1 VANTAIL MOTORISE
KASTENRAHMENSYSTEM FÜR SCHIEBETÜR : 1 HANDTÜRFLÜGEL
POCKETDOOR – 1 MOTORIZED LEAF
PUERTA ENTRE TABIQUE : 1 HOJA MOTORIZADA



Poids maximal des panneaux Maximales Gewicht Maximum weight Peso máximo por hoja	80 Kg
Epaisseur des panneaux Ladendicke Shutter thickness Espesor de las hojas	40 mm



COMPOSITION - ZUSAMMENSETZUNG - COMPOSICIÓN

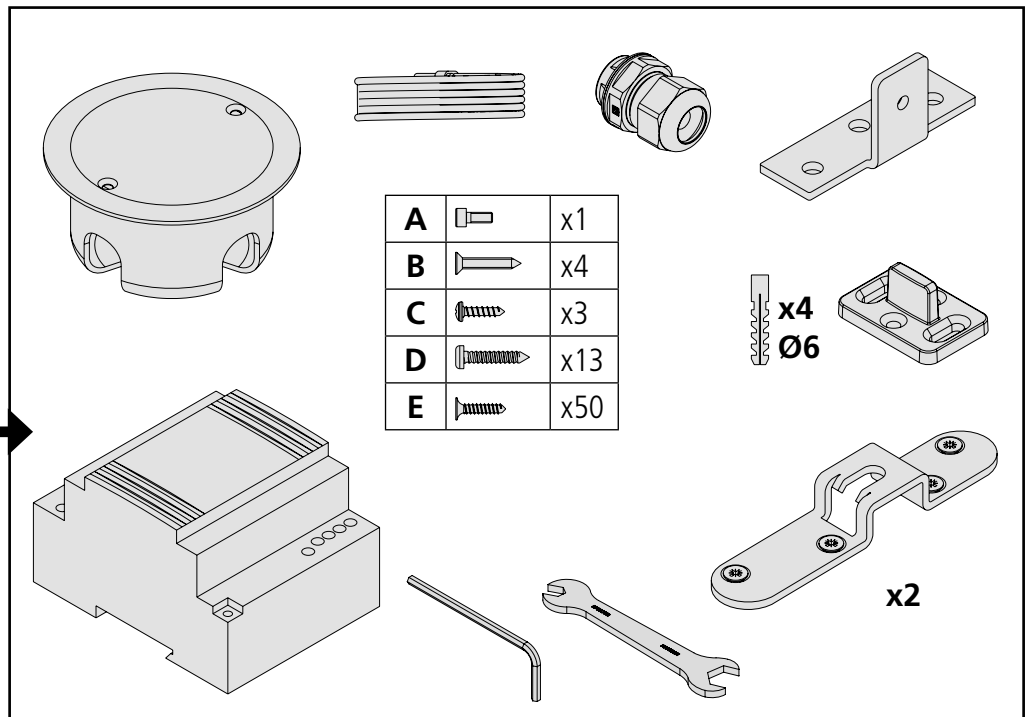
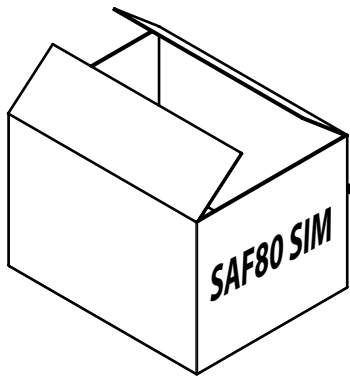
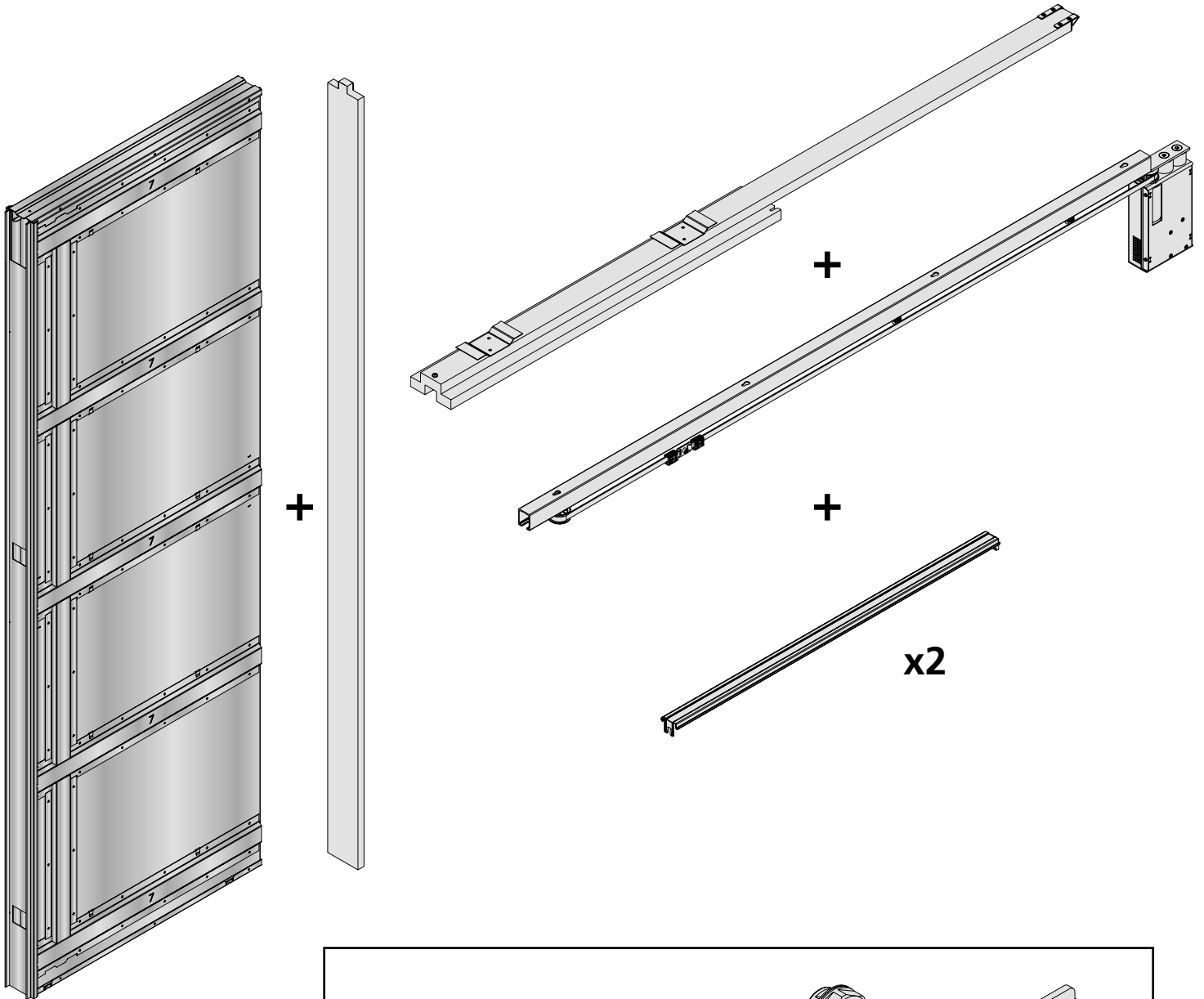

ENCOMBREMENT / ABMESSUNGEN DIMENSIONS / VOLUMEN

Ref. / Art.Nr Item Nr	LT (mm)	LO (mm)
SAF-INSIDE70M	1610	695
SAF-INSIDE80M	1810	795
SAF-INSIDE90M	2010	895

dimensions des portes Abmessungen von Türen dimensions of doors Dimensiones de las puertas	
L (mm)	W (mm)
730	2040
830	2040
930	2040

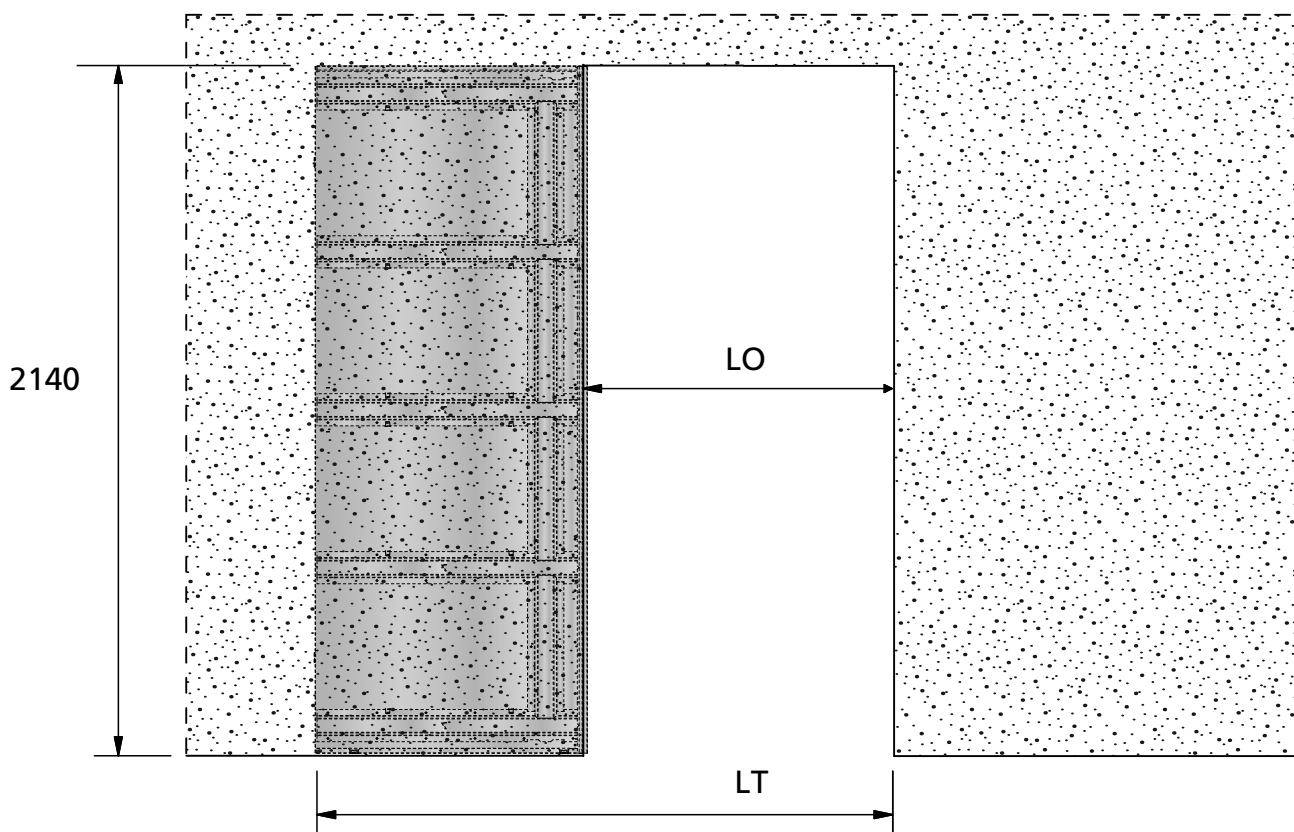
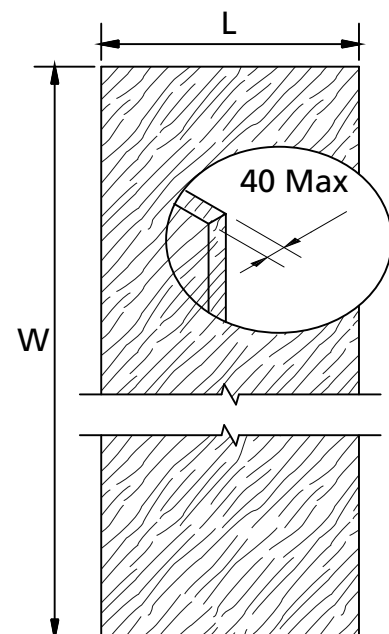

IMPORTANT: Produit destiné à une utilisation en intérieur. Ne pas installer dans des endroits humides.
WICHTIG: Dieses Produkt ist nur für Innenanwendung geeignet.
 Nicht in feuchten Atmosphären verwenden
WARNING: For indoor use only. Do not install in humid places
IMPORTANTE: Producto con destinación en el interior. No instalar en lugares húmedos

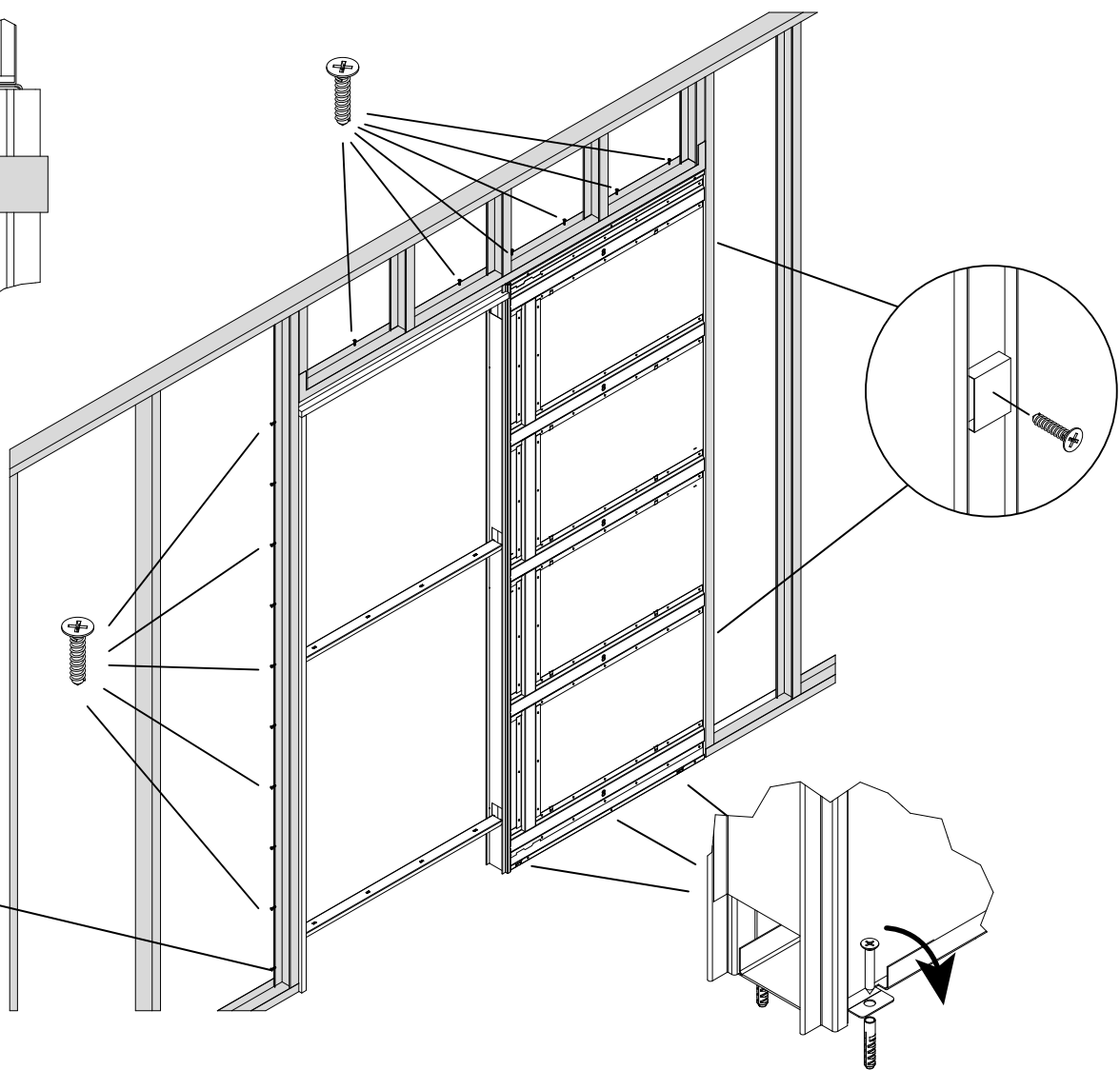
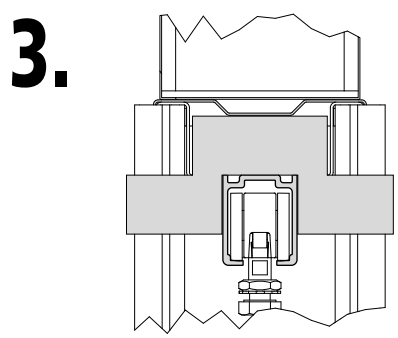
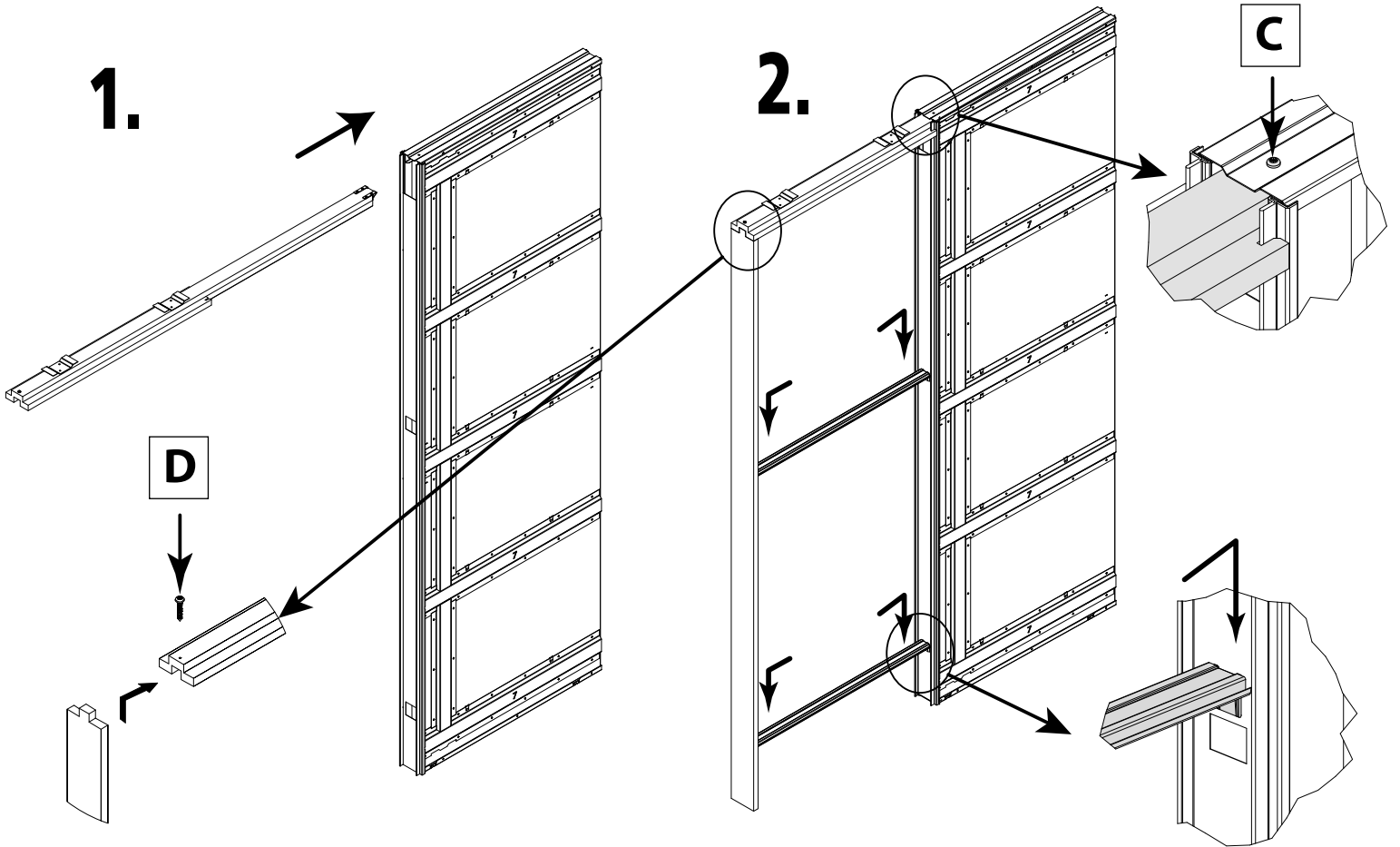

Accessoires de fixation non fournis
 Fixing accessories not supplied
 Befestigungszubehör nicht geliefert
 Accesorios de fijación no suministrados

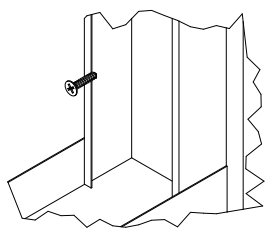

4.

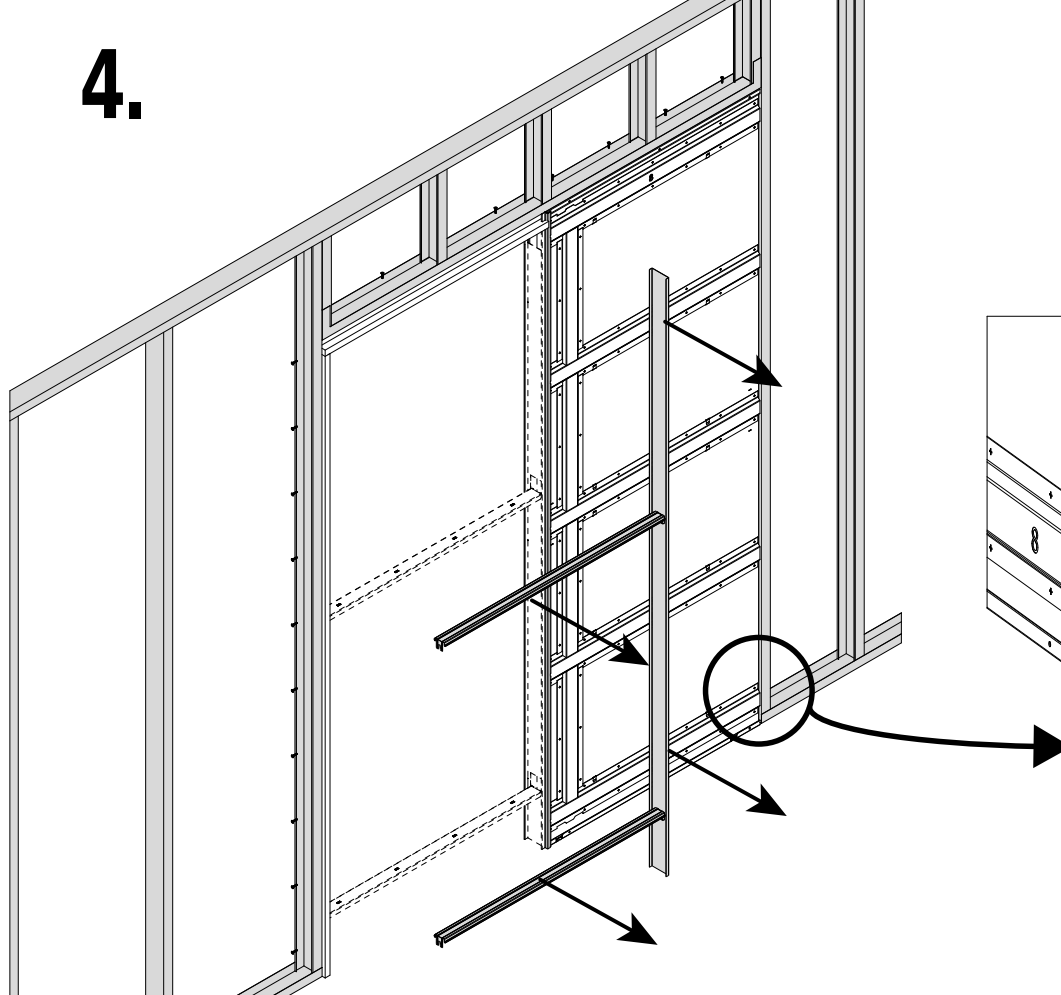

5.

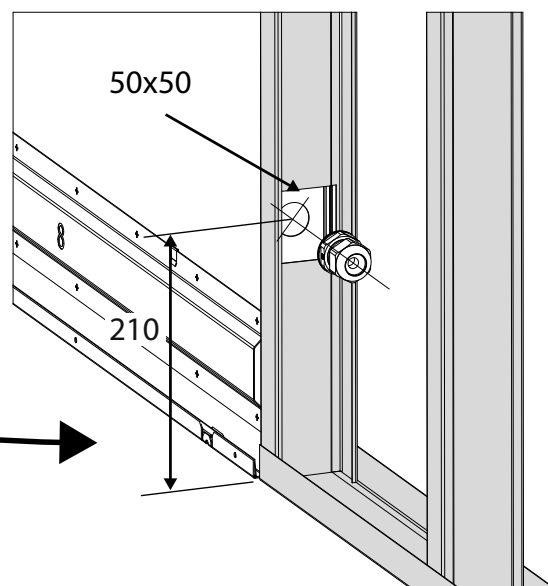

5.1

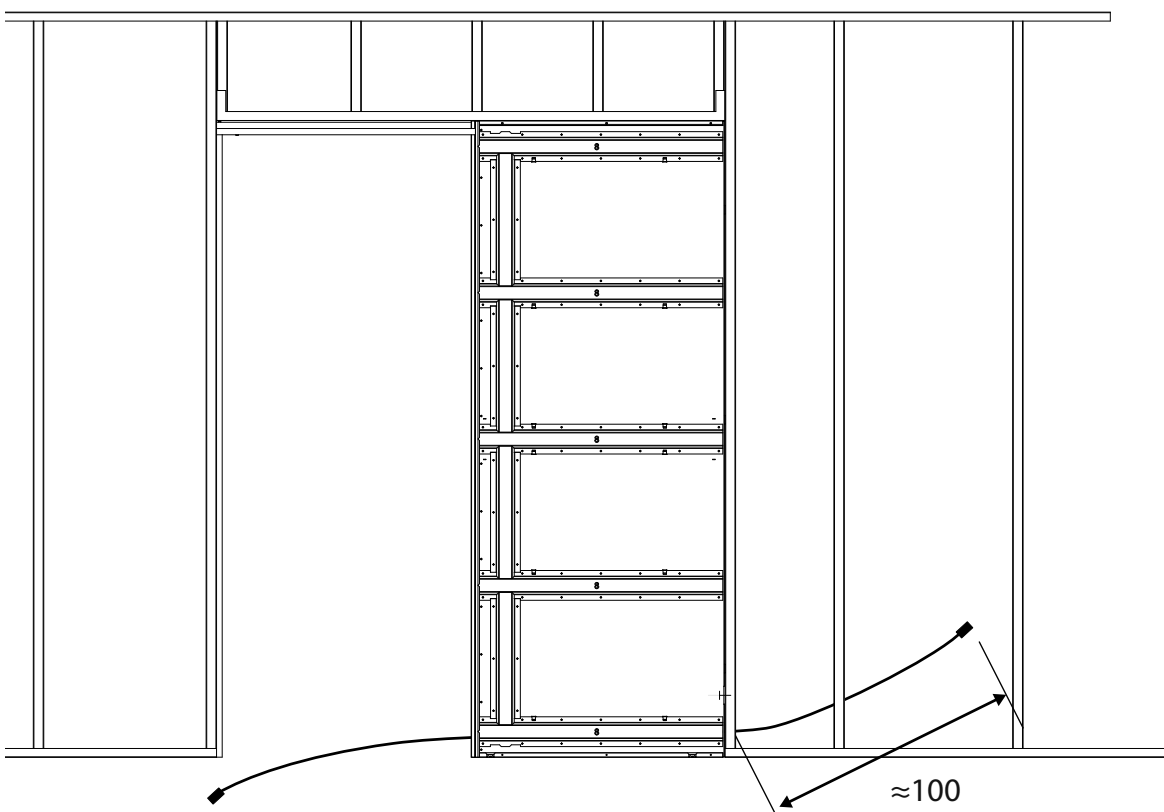

5.2

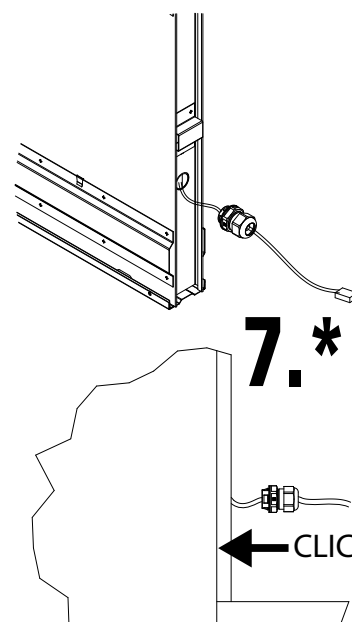

6.

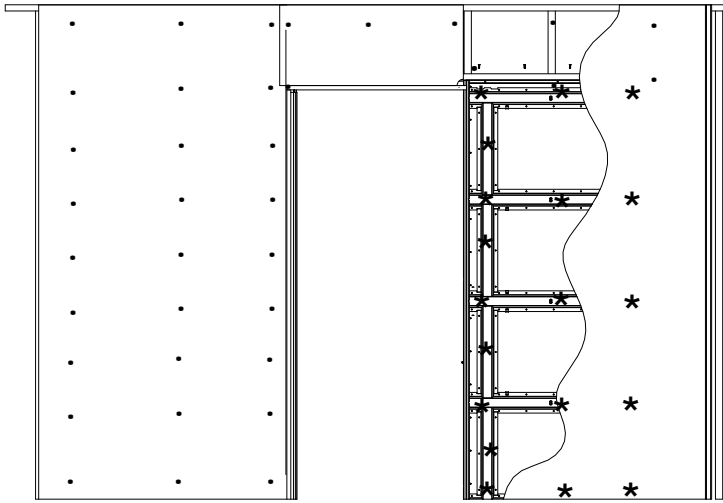

E x50

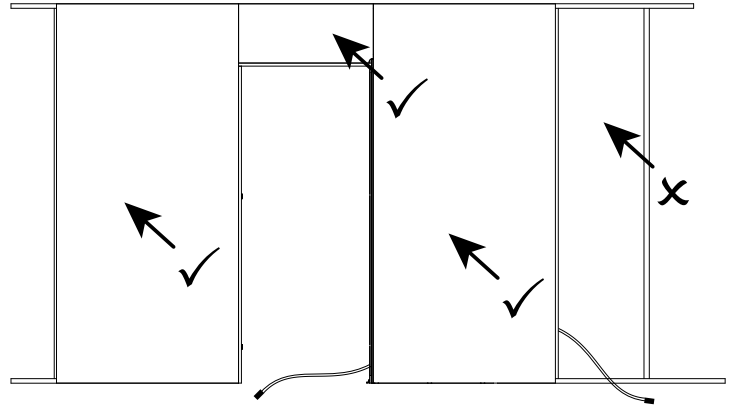

6.1



IMPORTANT: Retirer intégralement les cales collées à l'intérieur du caisson.

WICHTIG: Take back all the wedges fixed inside the frame.

WARNING: Anheben die ganze beklebt Keile in dem Rahmen.

IMPORTANTE: Quitar integralmente los calces pegados en el interior del cajón.

7.

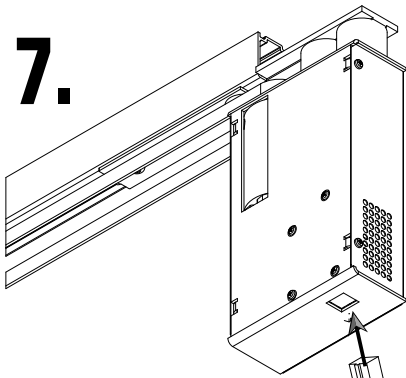

7.1

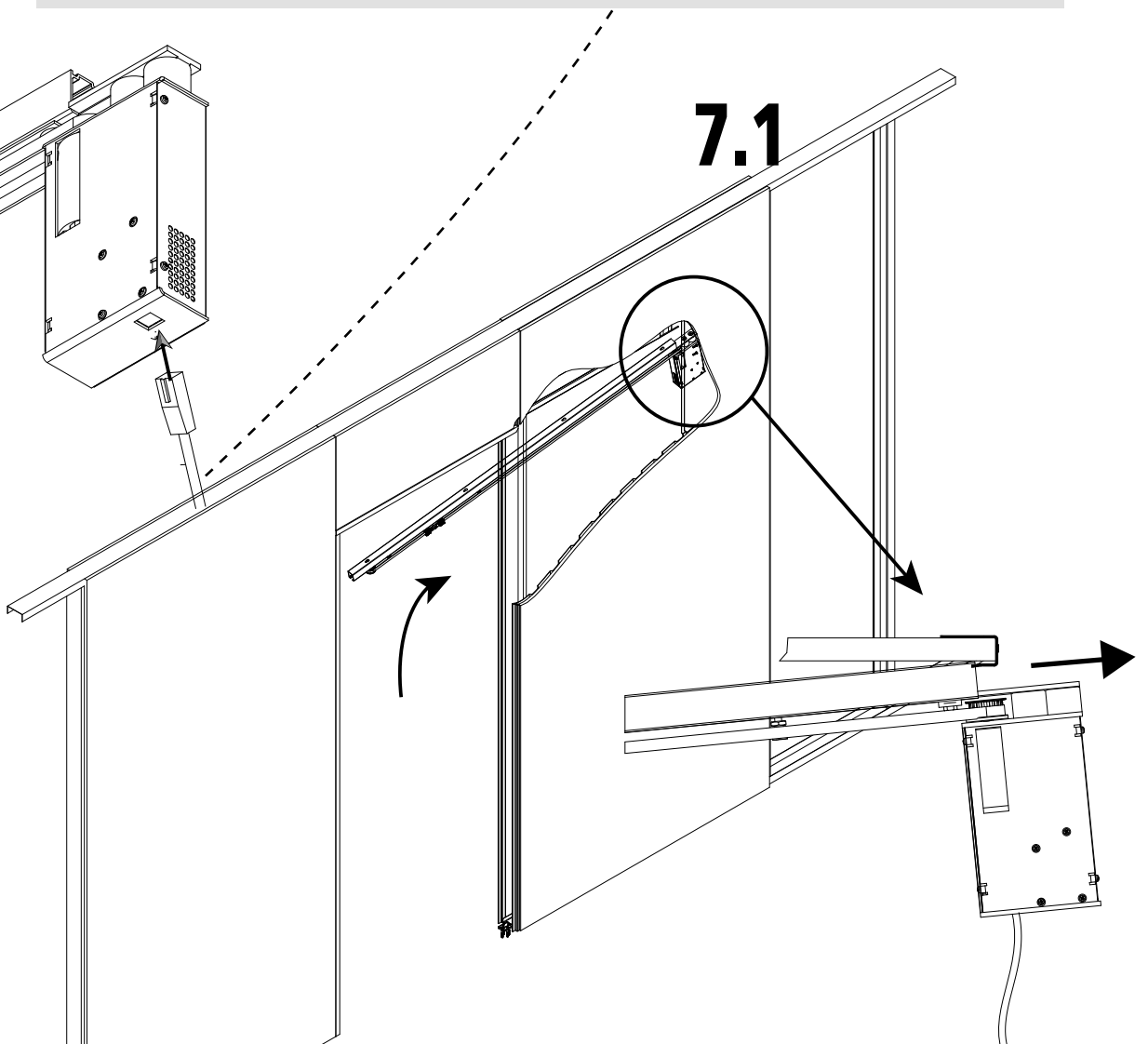

8.

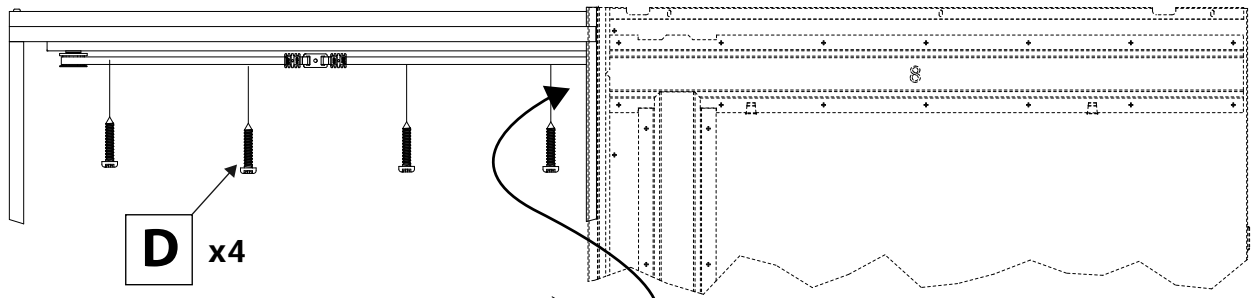

9.

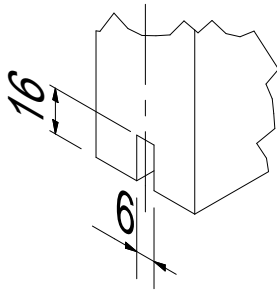
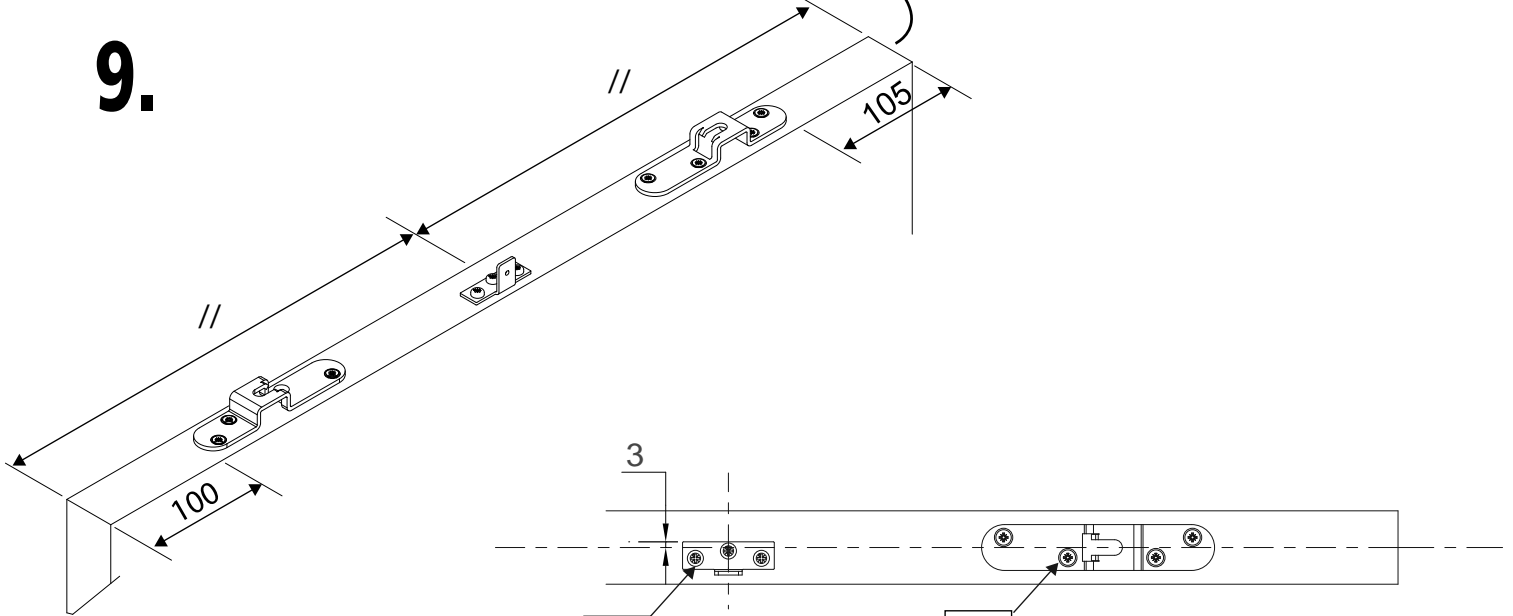

10.

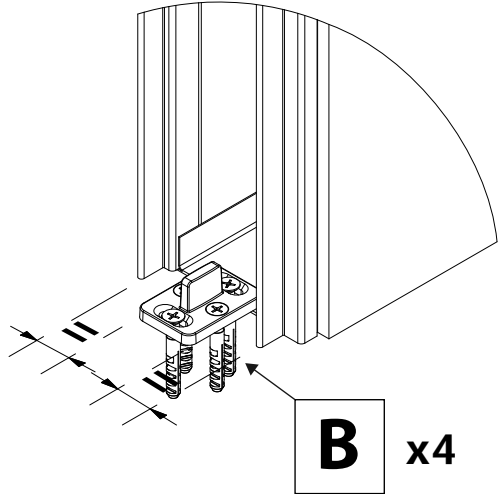

11.

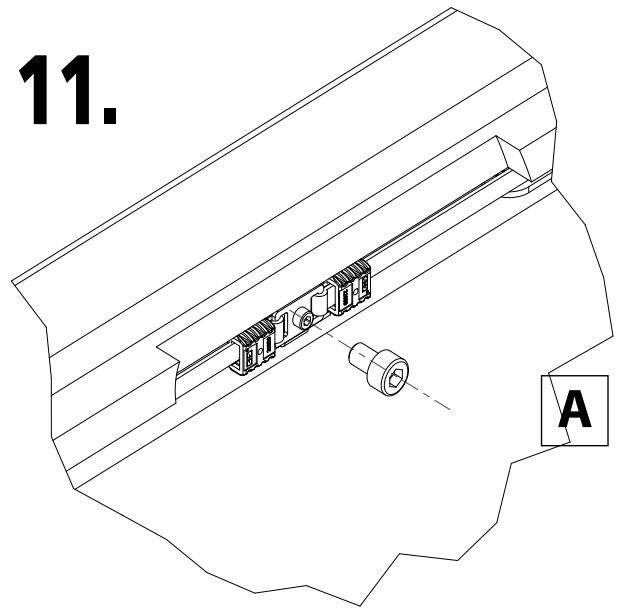

12.

