



INSTRUCTION DE MONTAGE
MONTAGEANLEITUNG
INSTRUCTIONS FOR ASSEMBLY
INSTRUCCIONES DE MONTAJE

SAF-INSIDE

NM SI80GM

PORTE ENTRE-CLOISONS: 1 VANTAIL MOTORISE
KASTENRAHMENSYSTEM FÜR SCHIEBETÜR : 1 HANDTÜRFLÜGEL
POCKETDOOR – 1 MOTORIZED LEAF
PUERTA ENTRE TABIQUE : 1 HOJA MOTORIZADA

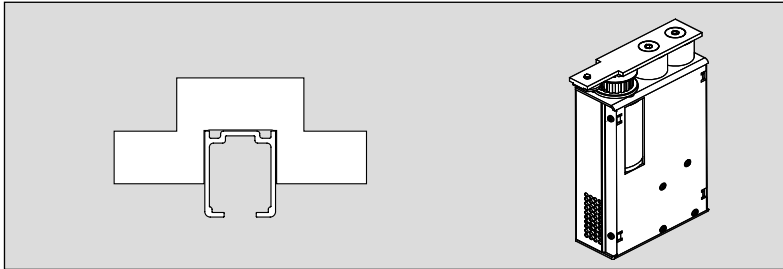

| | |
|-------------------------------------------------------------------------------------------|--------------|
| Poids maximal des panneaux Maximales Gewicht Maximum weight Peso máximo por hoja | 80 Kg |
| Epaisseur des panneaux Ladendicke Shutter thickness Espesor de las hojas | 8 mm |



ENCOMBREMENT / ABMESSUNGEN DIMENSIONS / VOLUMEN

| Ref. / Art.Nr Item Nr | LT (mm) | LO (mm) |
|--------------------------|---------|---------|
| SAF-INSIDECO70M | 1610 | 695 |
| SAF-INSIDECO80M | 1810 | 795 |
| SAF-INSIDECO90M | 2010 | 895 |

| dimensions des portes Abmessungen von Türen dimensions of doors Dimensiones de las puertas | |
|-----------------------------------------------------------------------------------------------------|--------|
| L (mm) | W (mm) |
| 735 | 2005 |
| 835 | 2005 |
| 935 | 2005 |

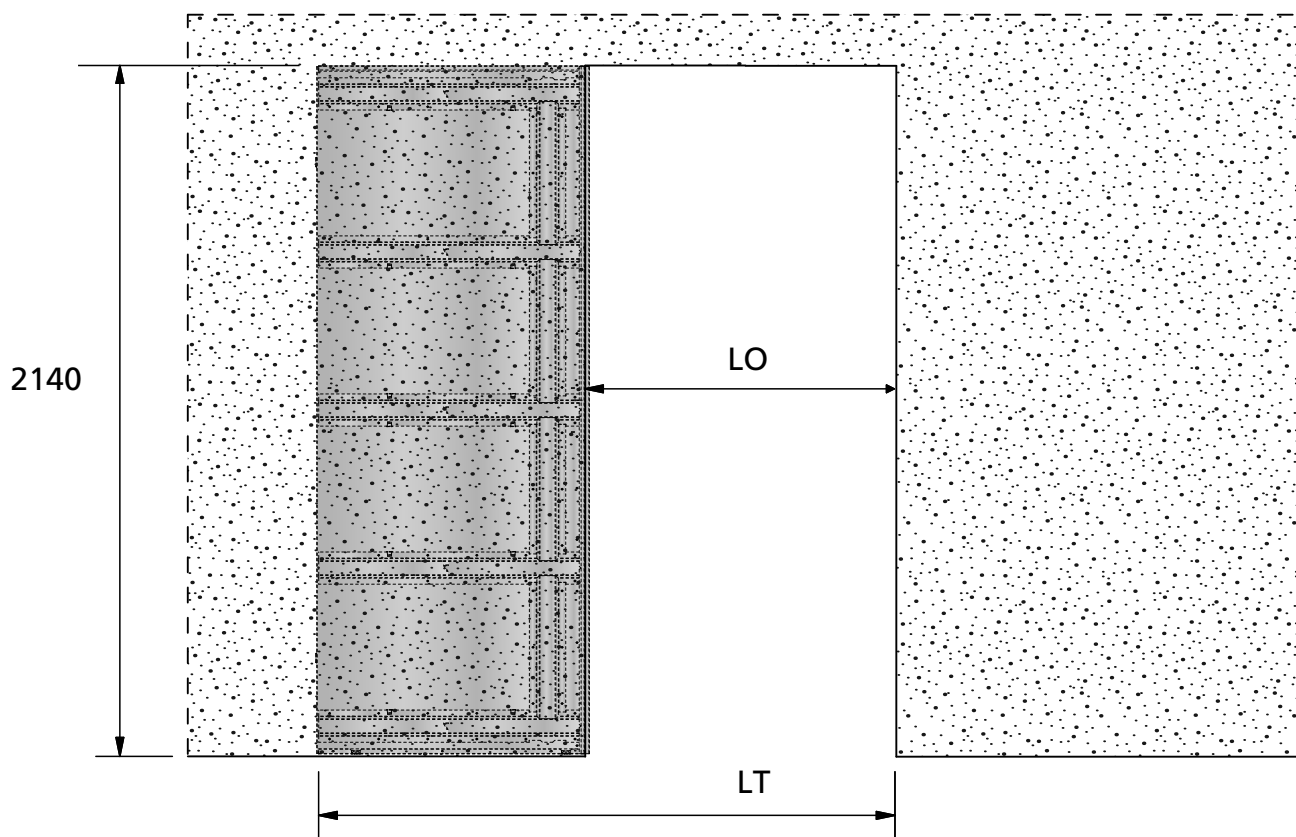
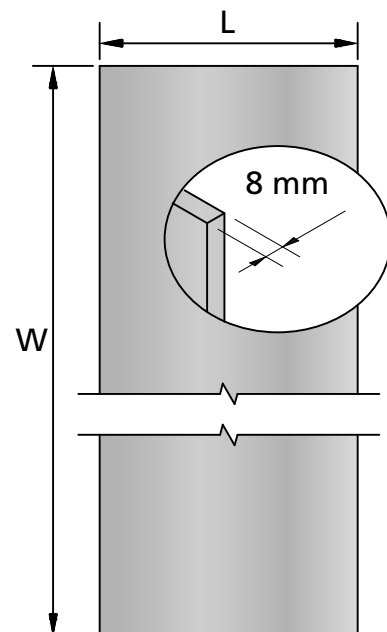

IMPORTANT: Produit destiné à une utilisation en intérieur. Ne pas installer dans des endroits humides.
WICHTIG: Dieses Produkt ist nur für Innenanwendung geeignet.
 Nicht in feuchten Atmosphären verwenden
WARNING: For indoor use only. Do not install in humid places
IMPORTANTE: Producto con destinación en el interior. No instalar en lugares húmedos

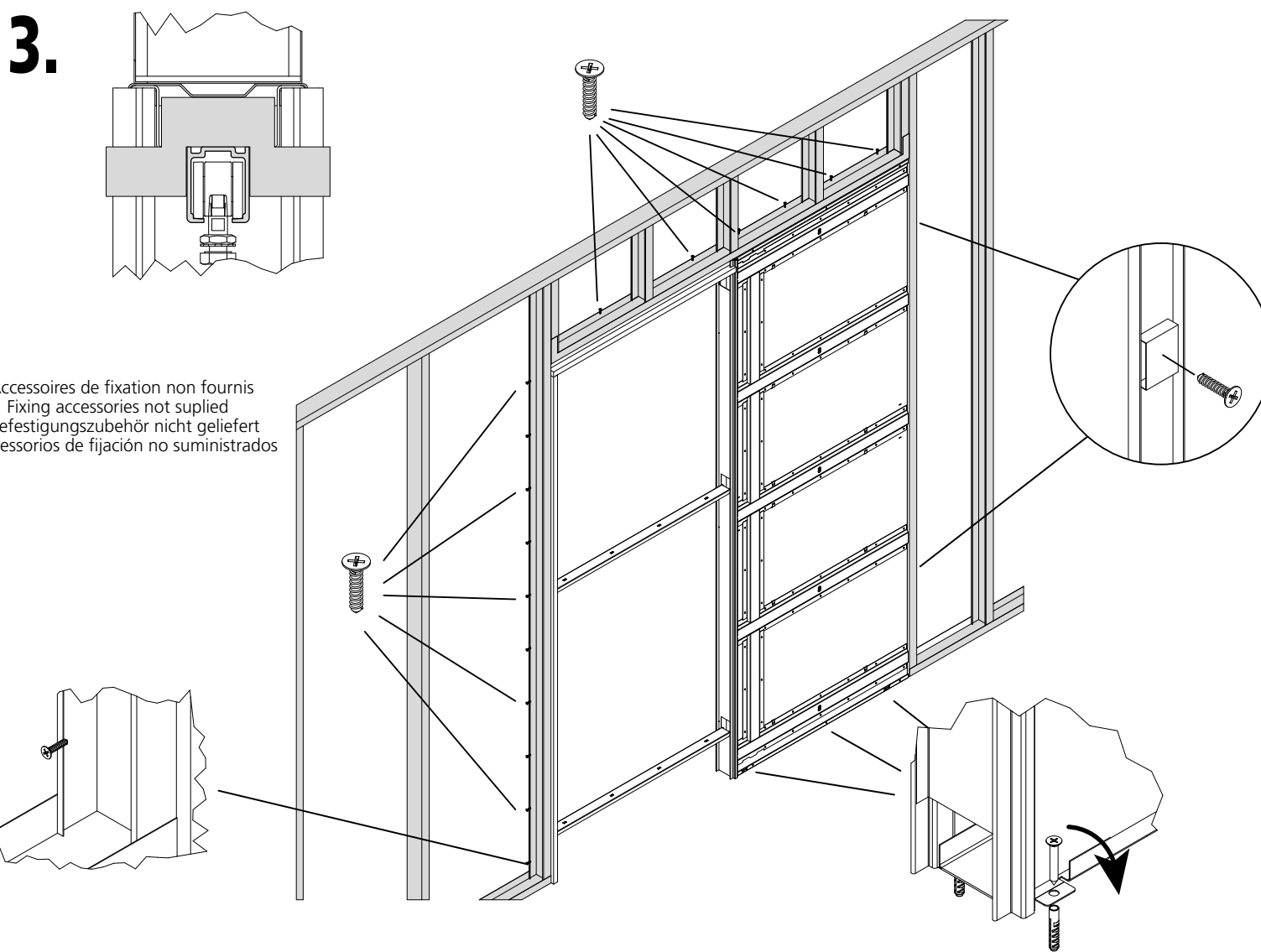
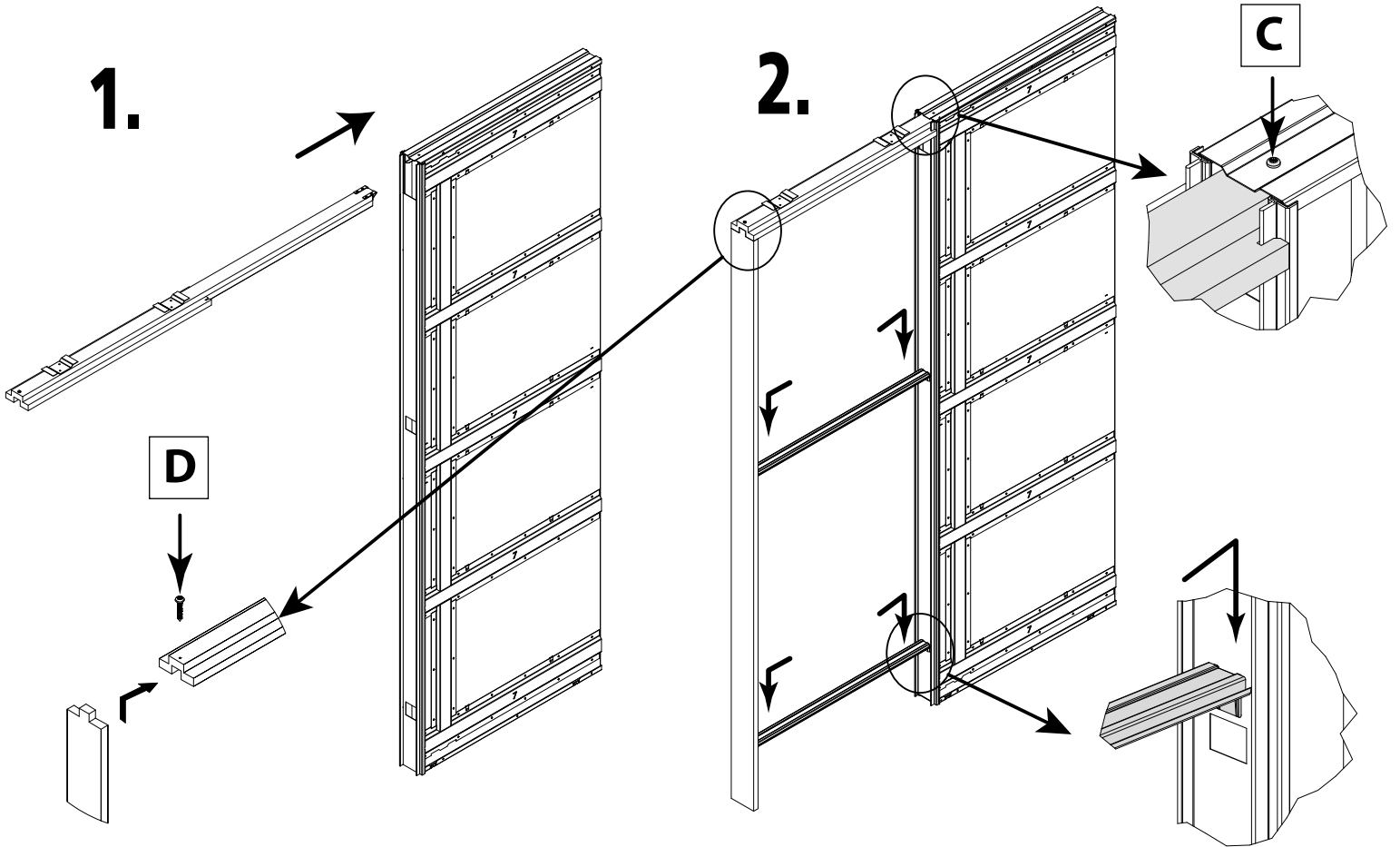

Accessoires de fixation non fournis
 Fixing accessories not supplied
 Befestigungszubehör nicht geliefert
 Accesorios de fijación no suministrados

4.

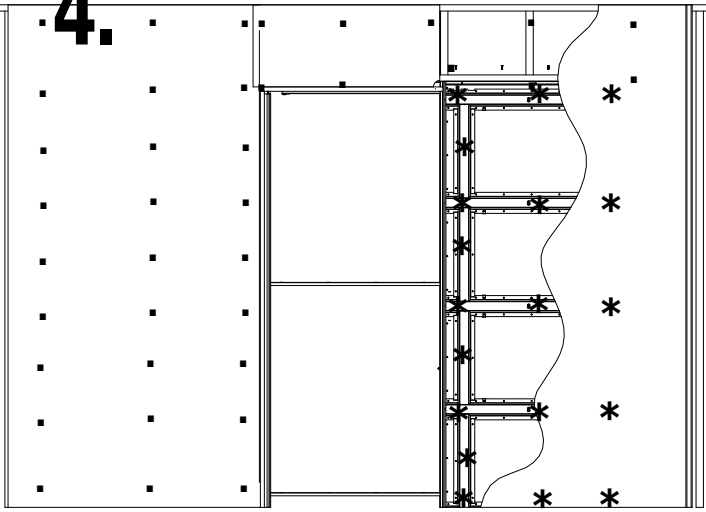

E x50



→ 7.*

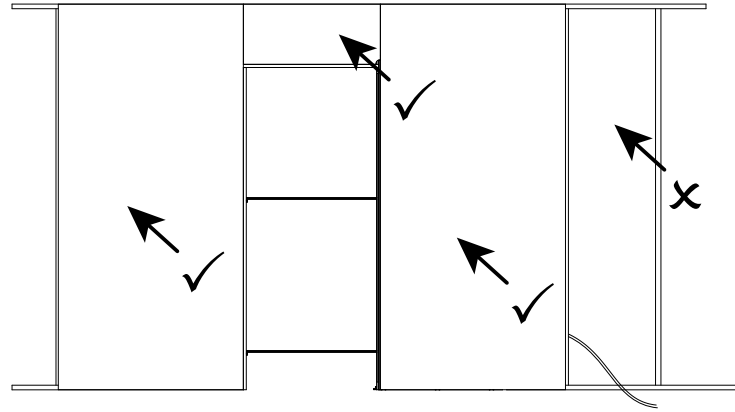

5.

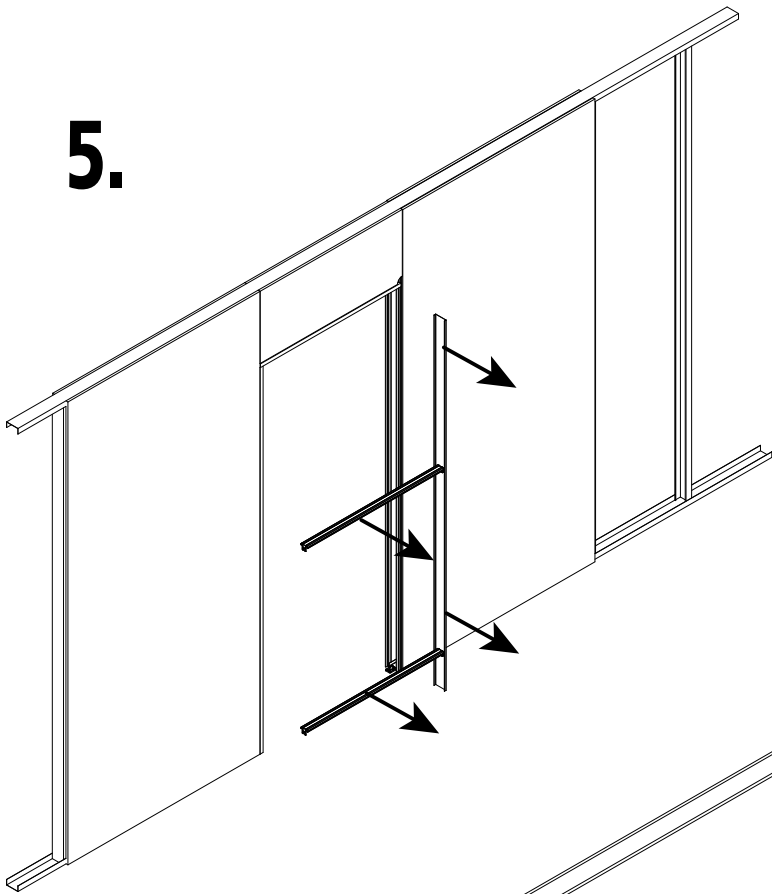

6.

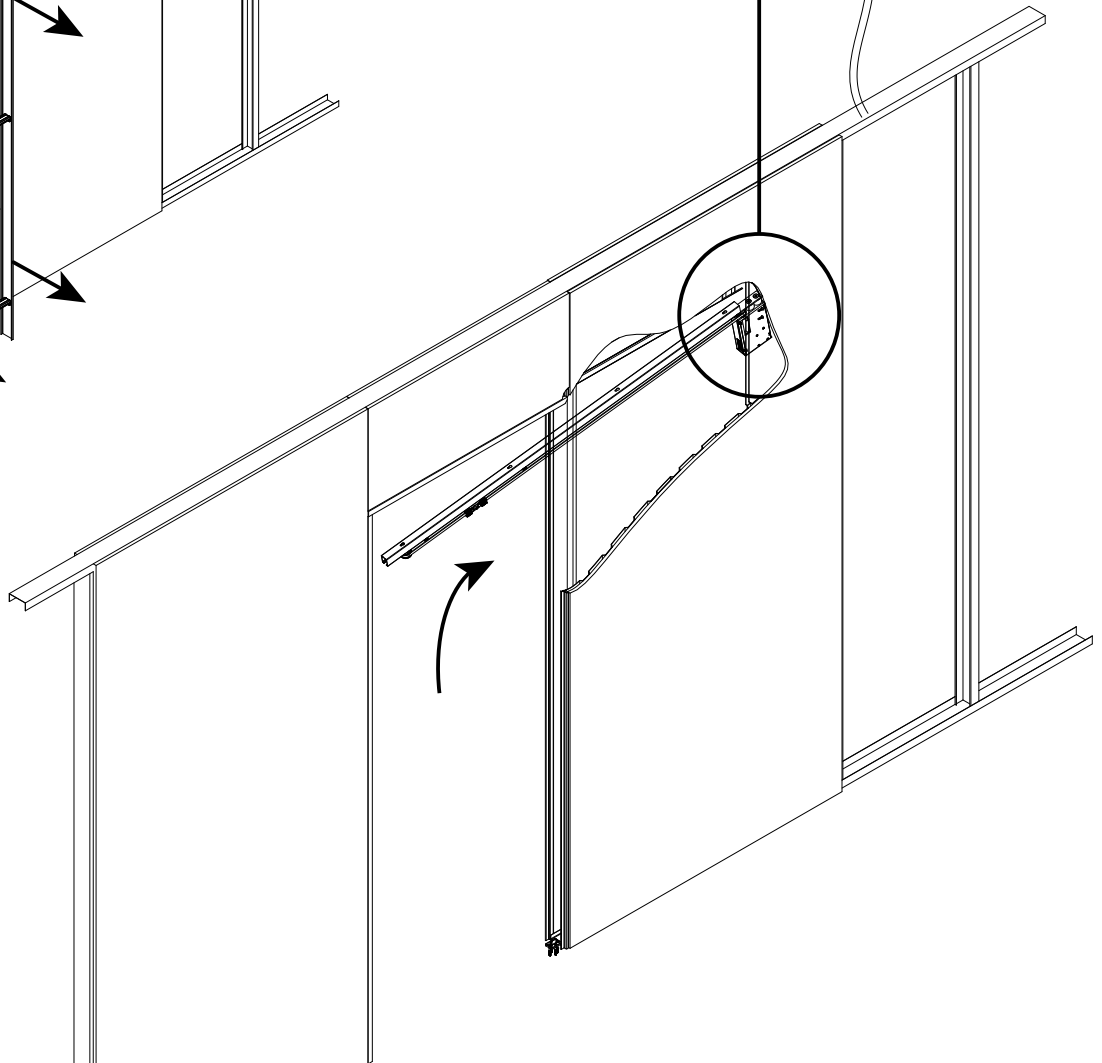
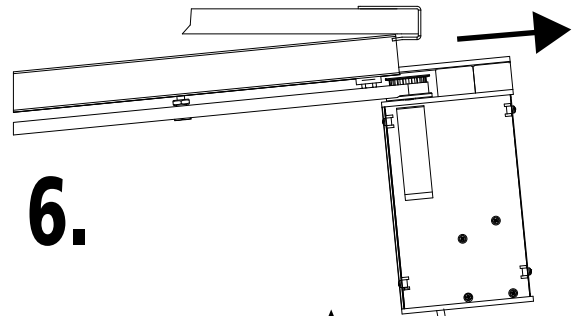

7.

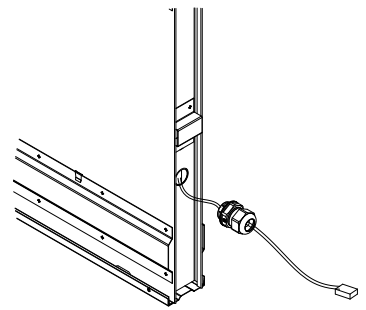
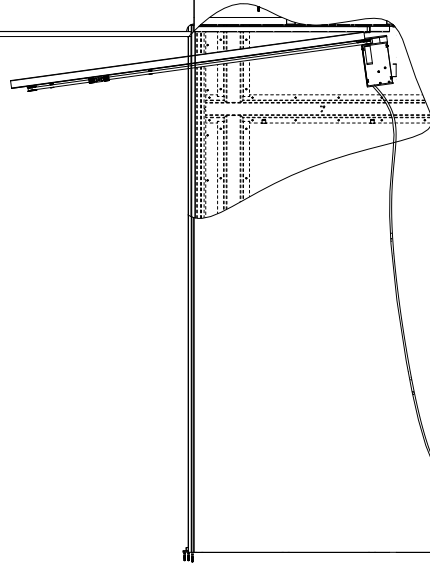

7.*

CLIC

8.

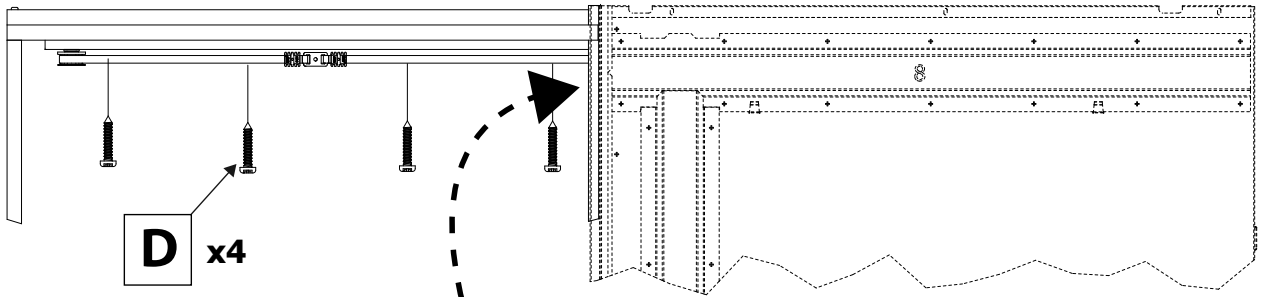

9.

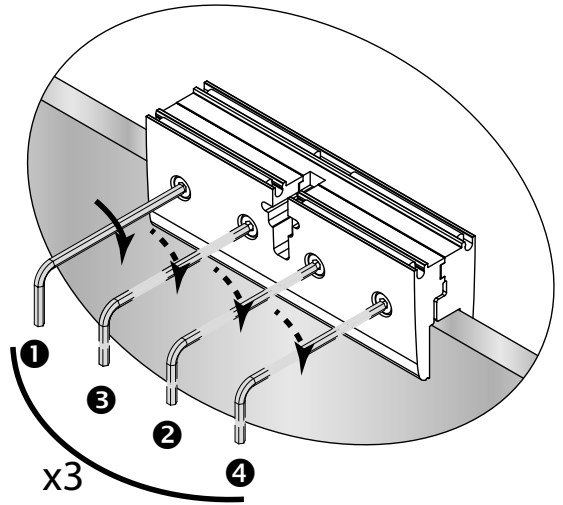
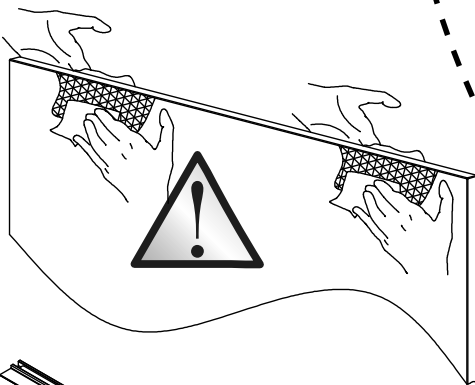

82
9 N.m

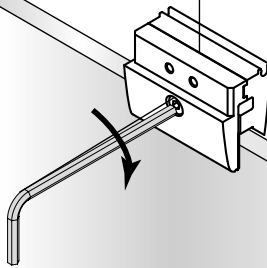
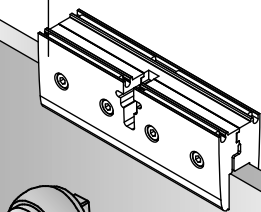

L/2

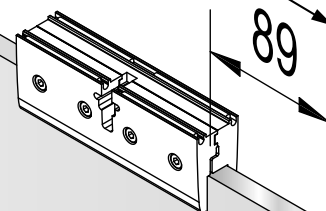

89

10.

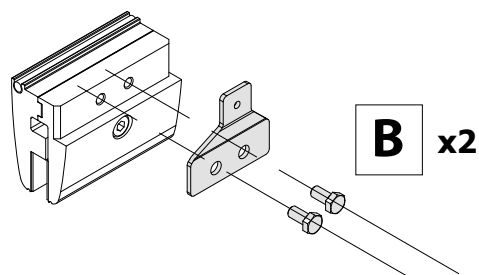

11.

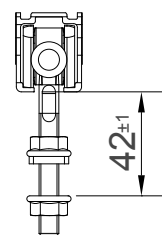
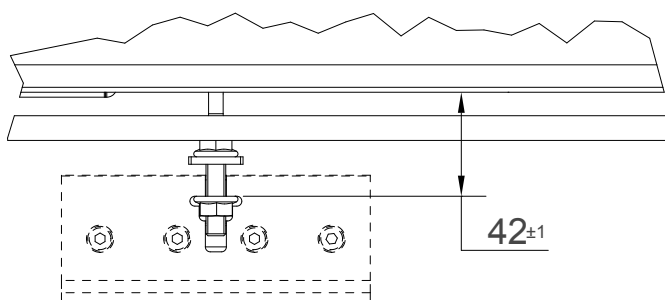

12.

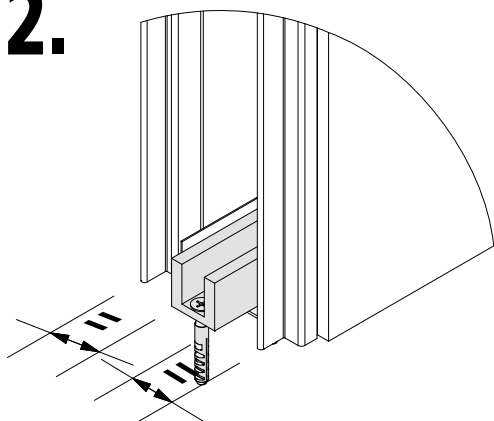

13.

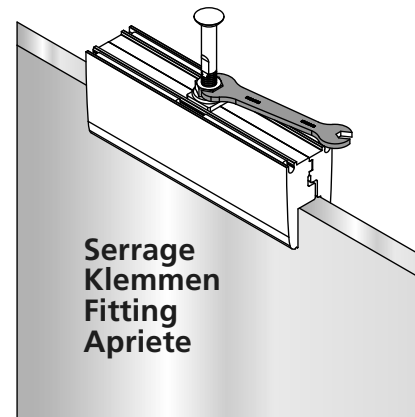
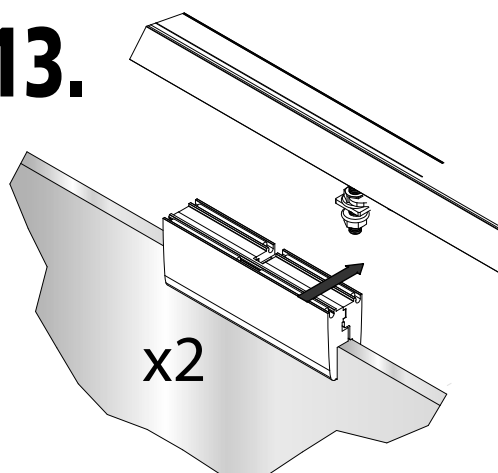

14.

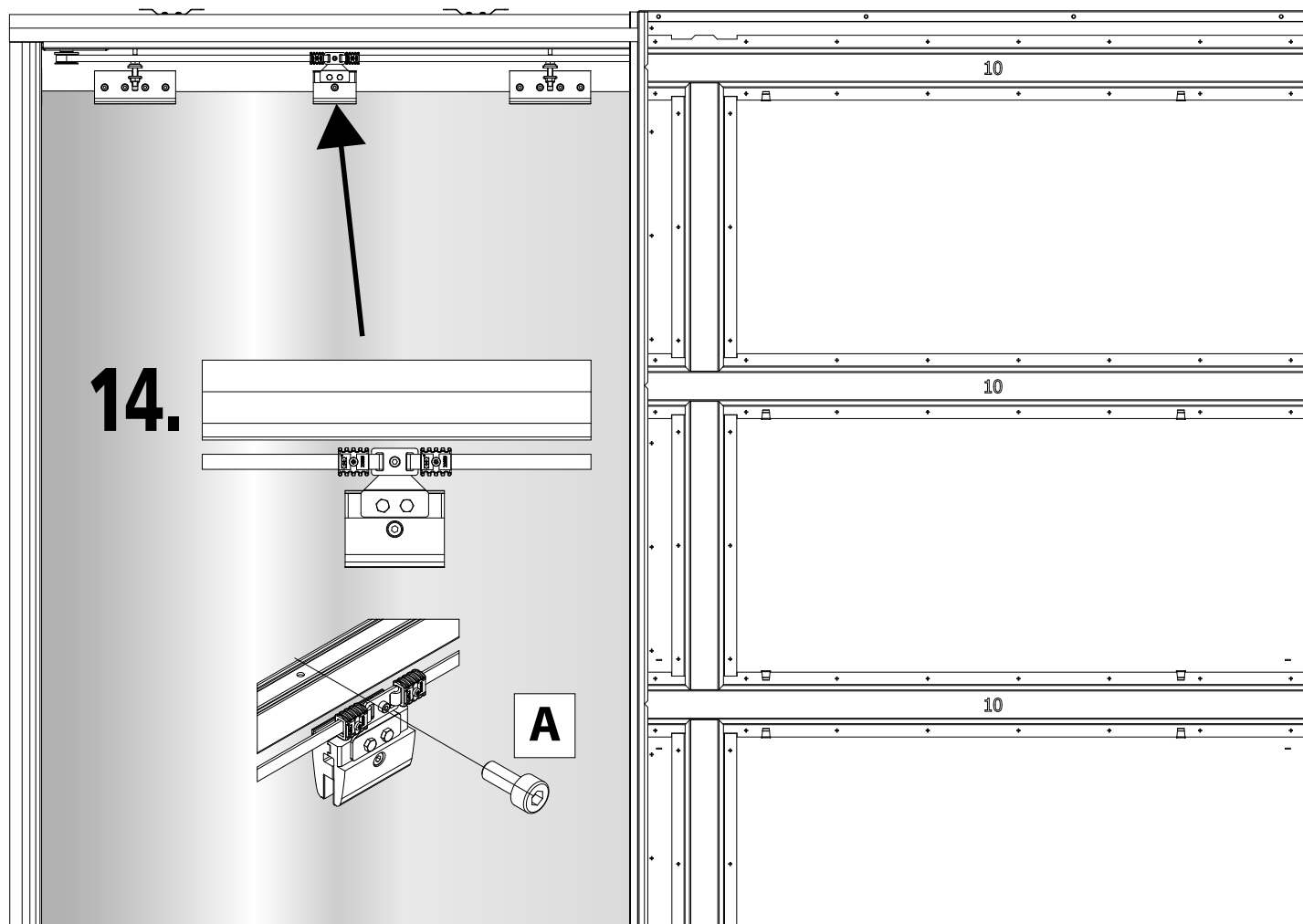

15.

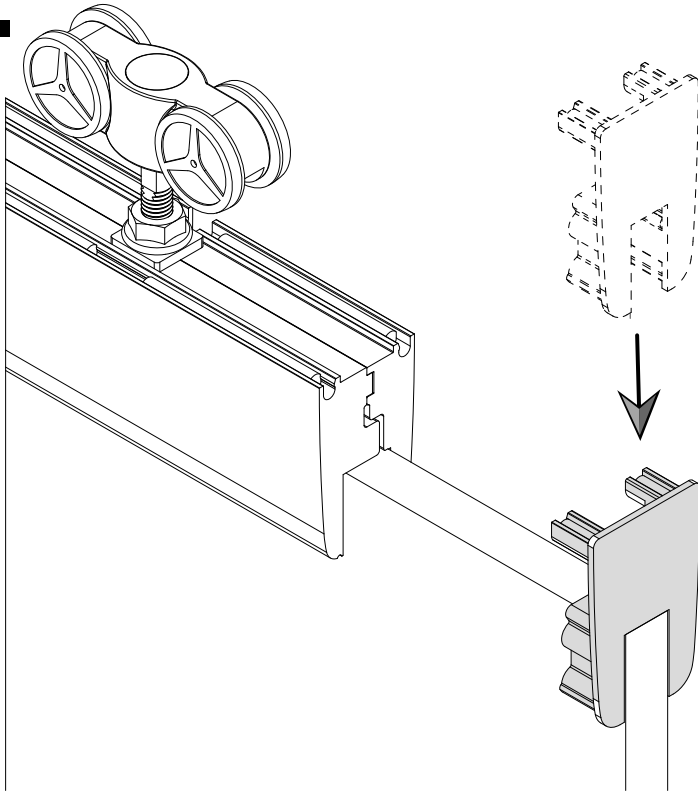

16.

