



INSTRUCTION DE MONTAGE  
MONTAGEANLEITUNG  
INSTRUCTIONS FOR ASSEMBLY  
INSTRUCCIONES DE MONTAJE

# SAF-INSIDE

## NM SI80M

*PORTE ENTRE-CLOISONS: 1 VANTAIL MOTORISE*  
*KASTENRAHMENSYSTEM FÜR SCHIEBETÜR : 1 HANDTÜRFLÜGEL*  
*POCKETDOOR – 1 MOTORIZED LEAF*  
*PUERTA ENTRE TABIQUE : 1 HOJA MOTORIZADA*

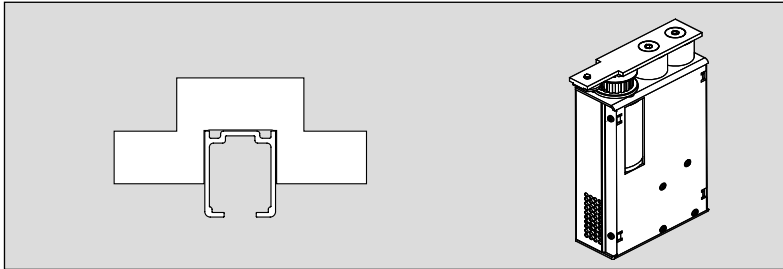

Poids maximal des panneaux Maximales Gewicht Maximum weight Peso máximo por hoja	<b>80 Kg</b>
Epaisseur des panneaux Ladendicke Shutter thickness Espesor de las hojas	<b>40 mm</b>

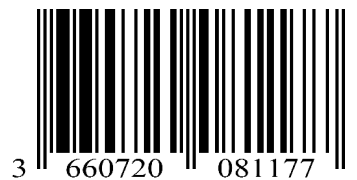

# COMPOSITION - ZUSAMMENSETZUNG - COMPOSICIÓN

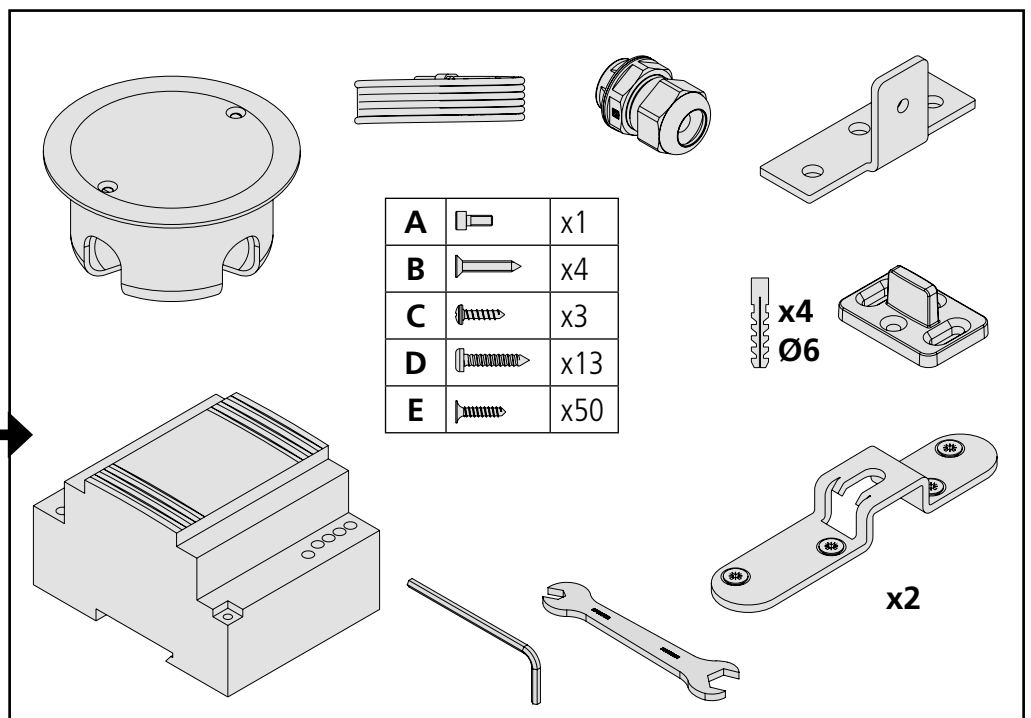
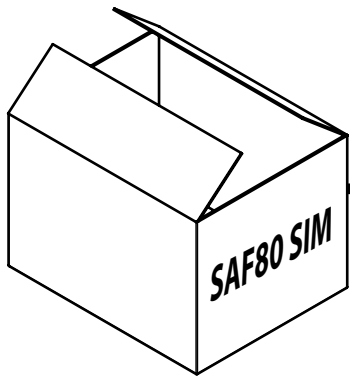
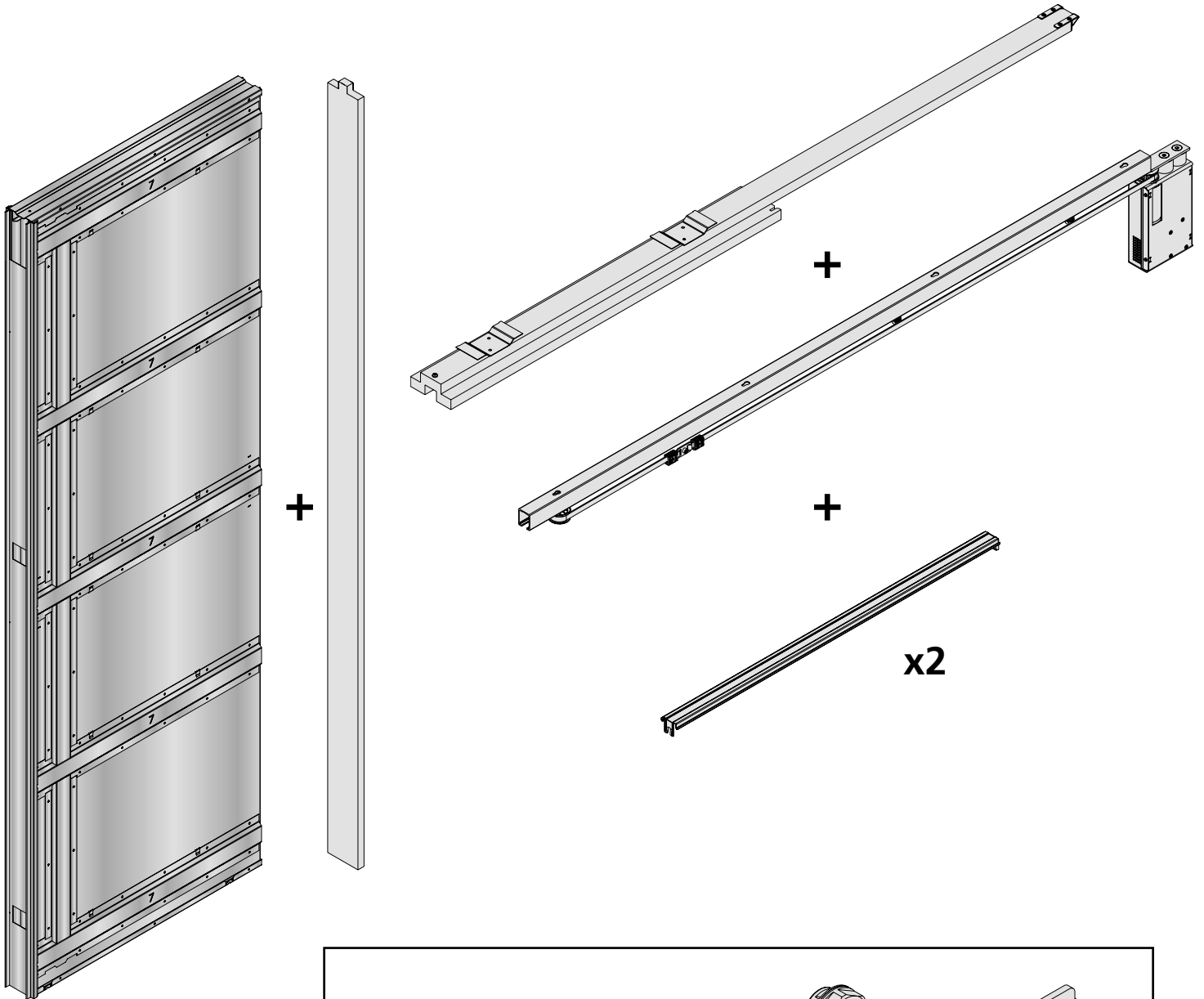

# ENCOMBREMENT / ABMESSUNGEN DIMENSIONS / VOLUMEN

Ref. / Art.Nr Item Nr	LT (mm)	LO (mm)
SAF-INSIDE70M	1610	695
SAF-INSIDE80M	1810	795
SAF-INSIDE90M	2010	895

dimensions des portes Abmessungen von Türen dimensions of doors Dimensiones de las puertas	
L (mm)	W (mm)
730	2040
830	2040
930	2040

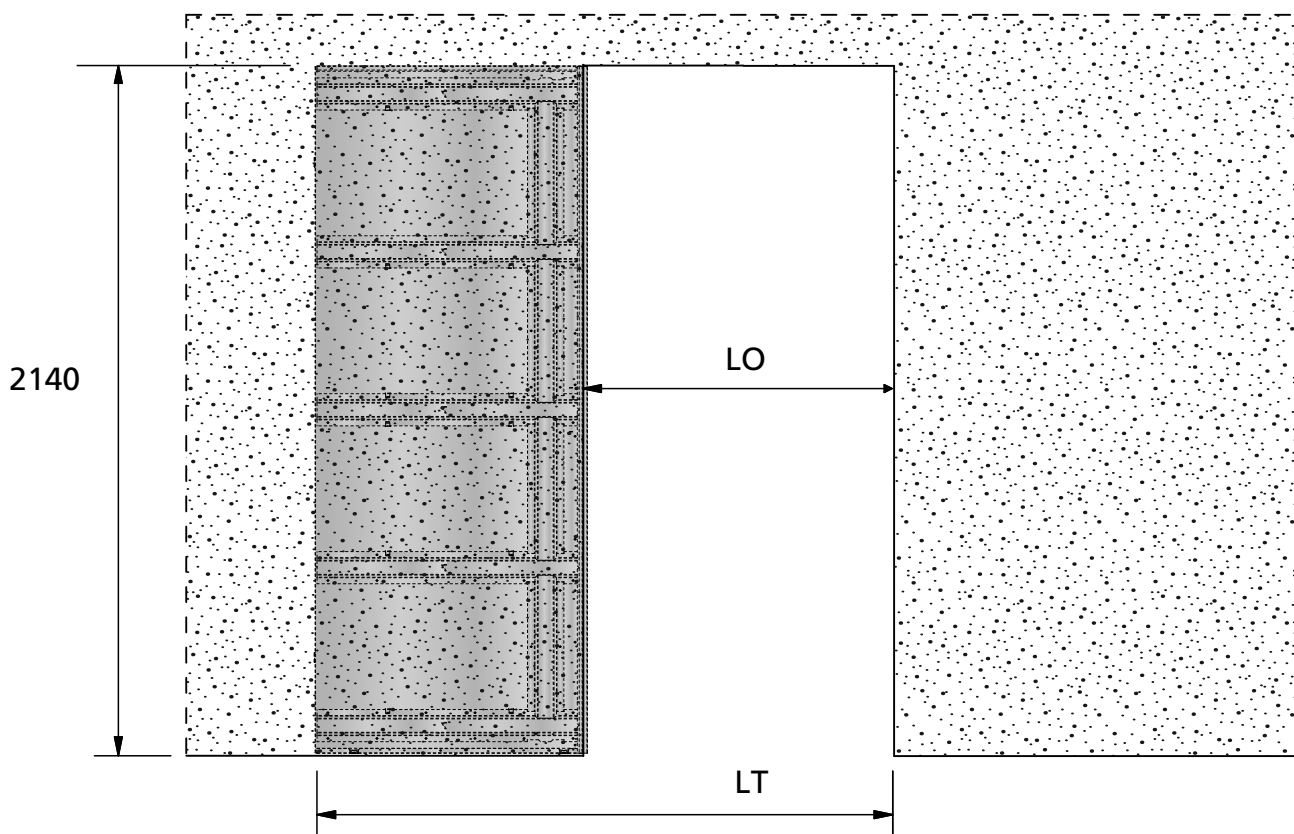
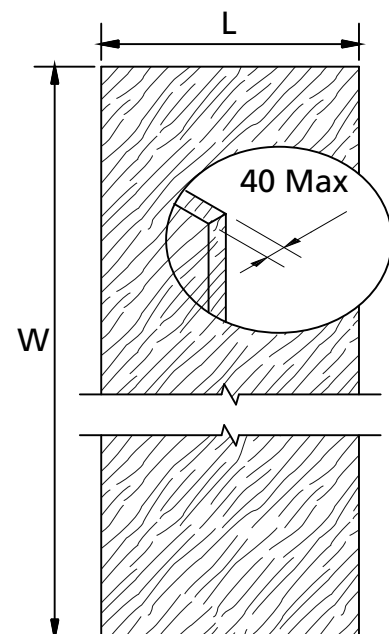

**IMPORTANT:** Produit destiné à une utilisation en intérieur. Ne pas installer dans des endroits humides.  
**WICHTIG:** Dieses Produkt ist nur für Innenanwendung geeignet.  
 Nicht in feuchten Atmosphären verwenden  
**WARNING:** For indoor use only. Do not install in humid places  
**IMPORTANTE:** Producto con destinación en el interior. No instalar en lugares húmedos

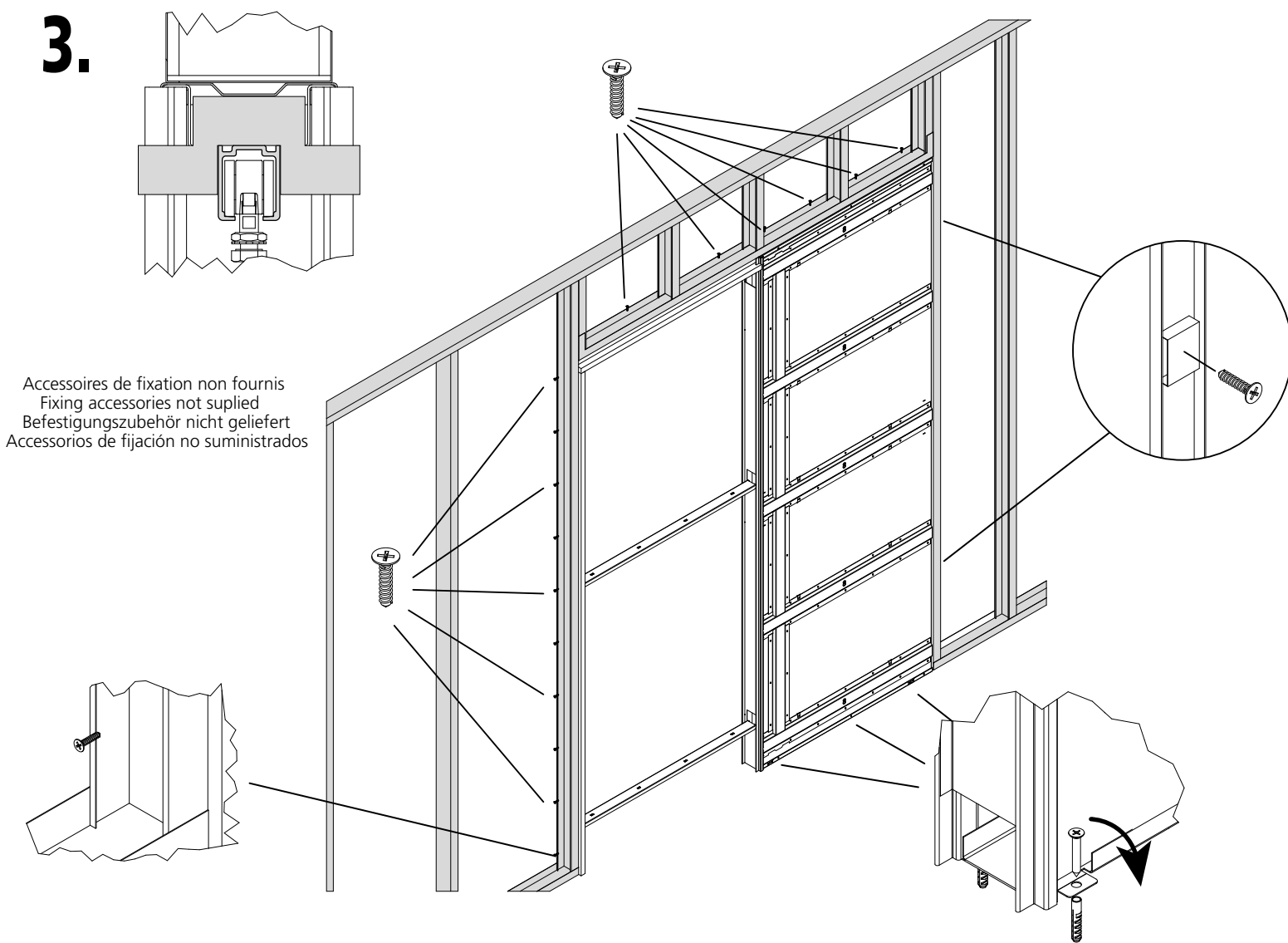
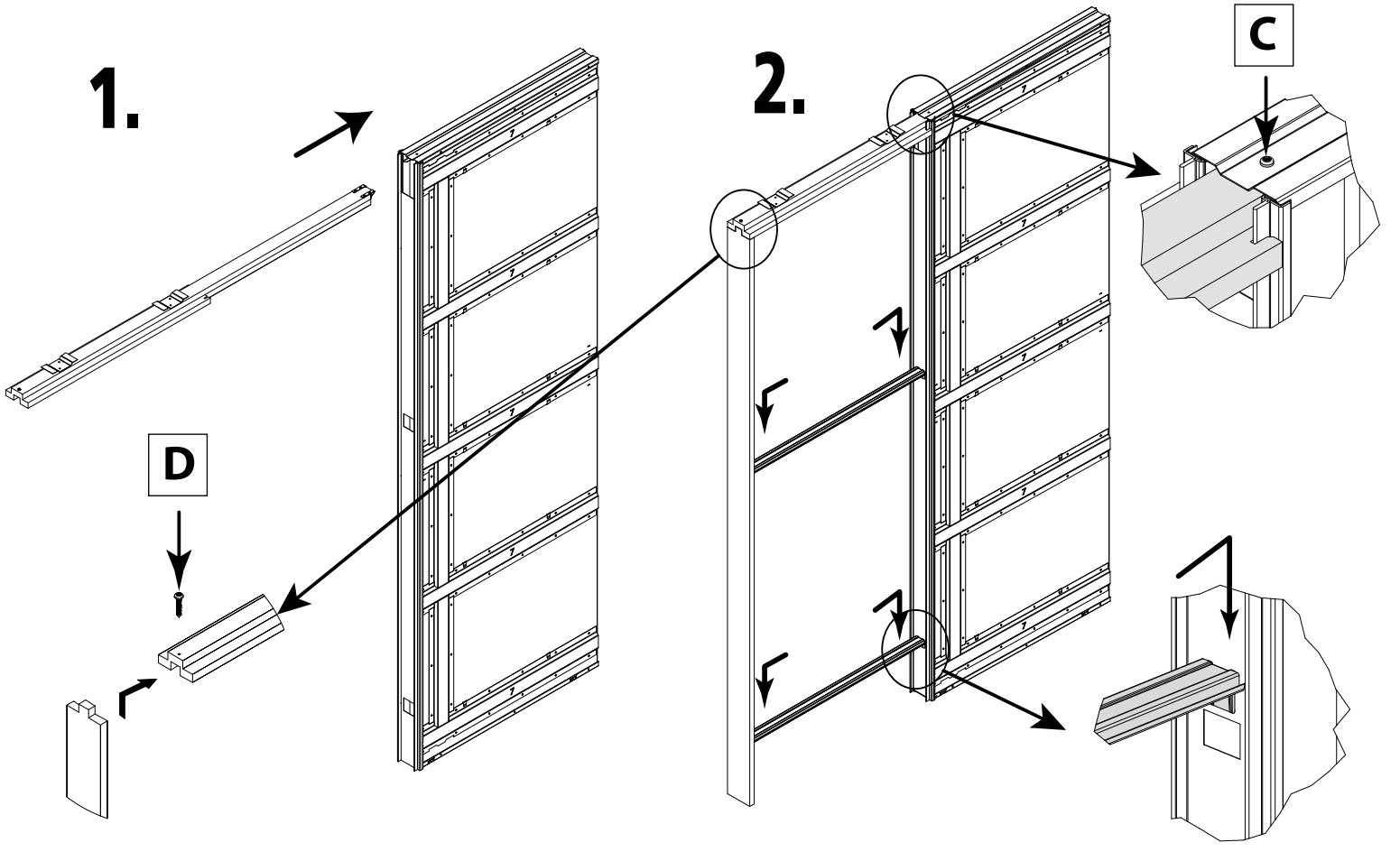

Accessoires de fixation non fournis  
 Fixing accessories not supplied  
 Befestigungszubehör nicht geliefert  
 Accesorios de fijación no suministrados

4.

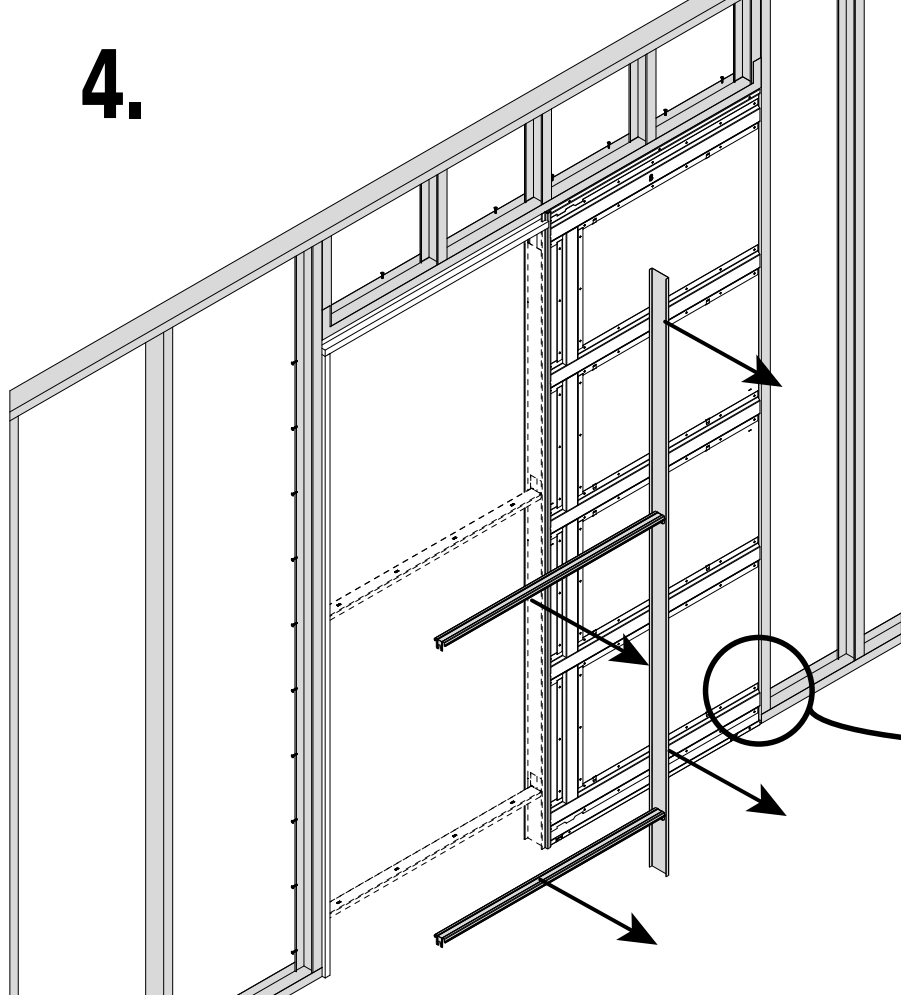

5.

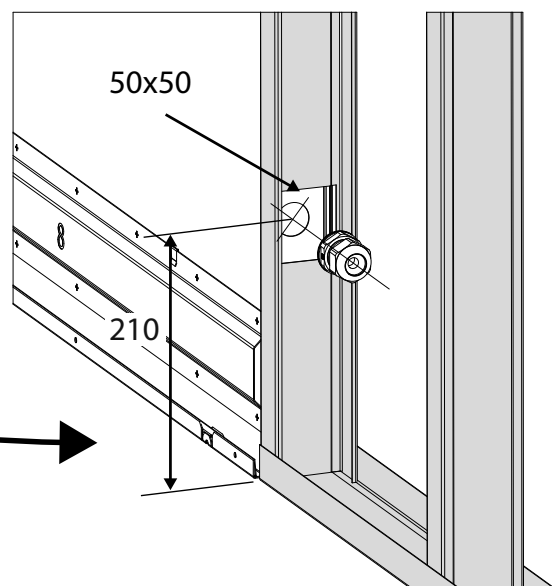

5.1

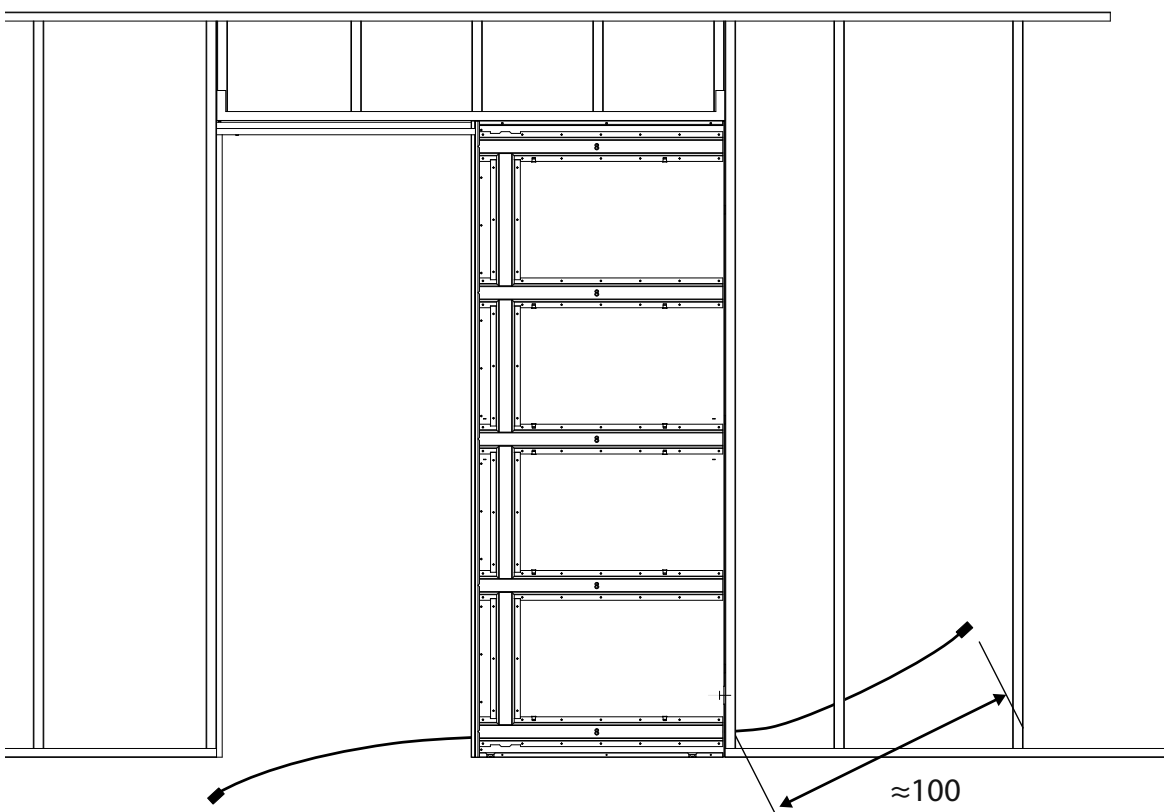

5.2

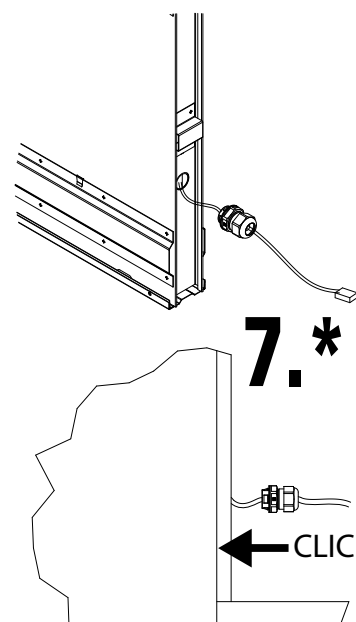

7.\*

CLIC

# 6.

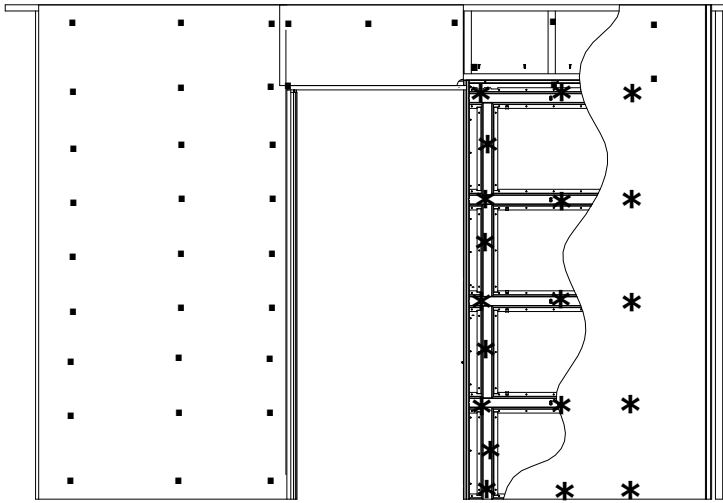

**E** x50

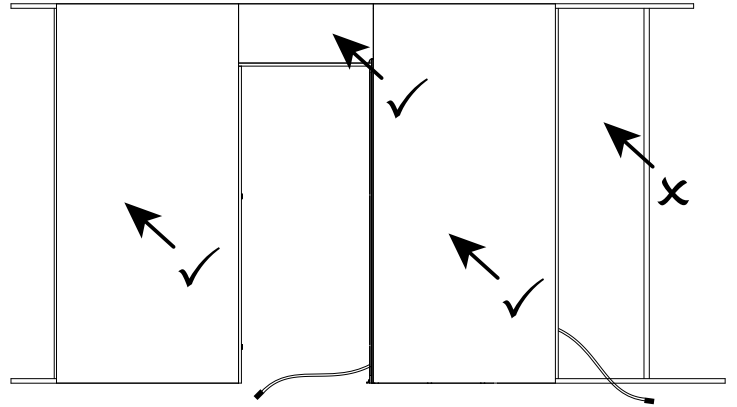

## 6.1



**IMPORTANT:** Retirer intégralement les cales collées à l'intérieur du caisson.

**WICHTIG:** Take back all the wedges fixed inside the frame.

**WARNING:** Anheben die ganze beklebt Keile in dem Rahmen.

**IMPORTANTE:** Quitar integralmente los calces pegados en el interior del cajón.

## 7.

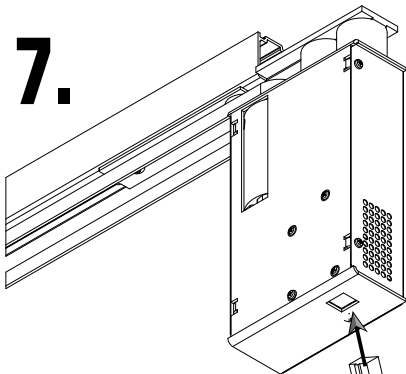

## 7.1

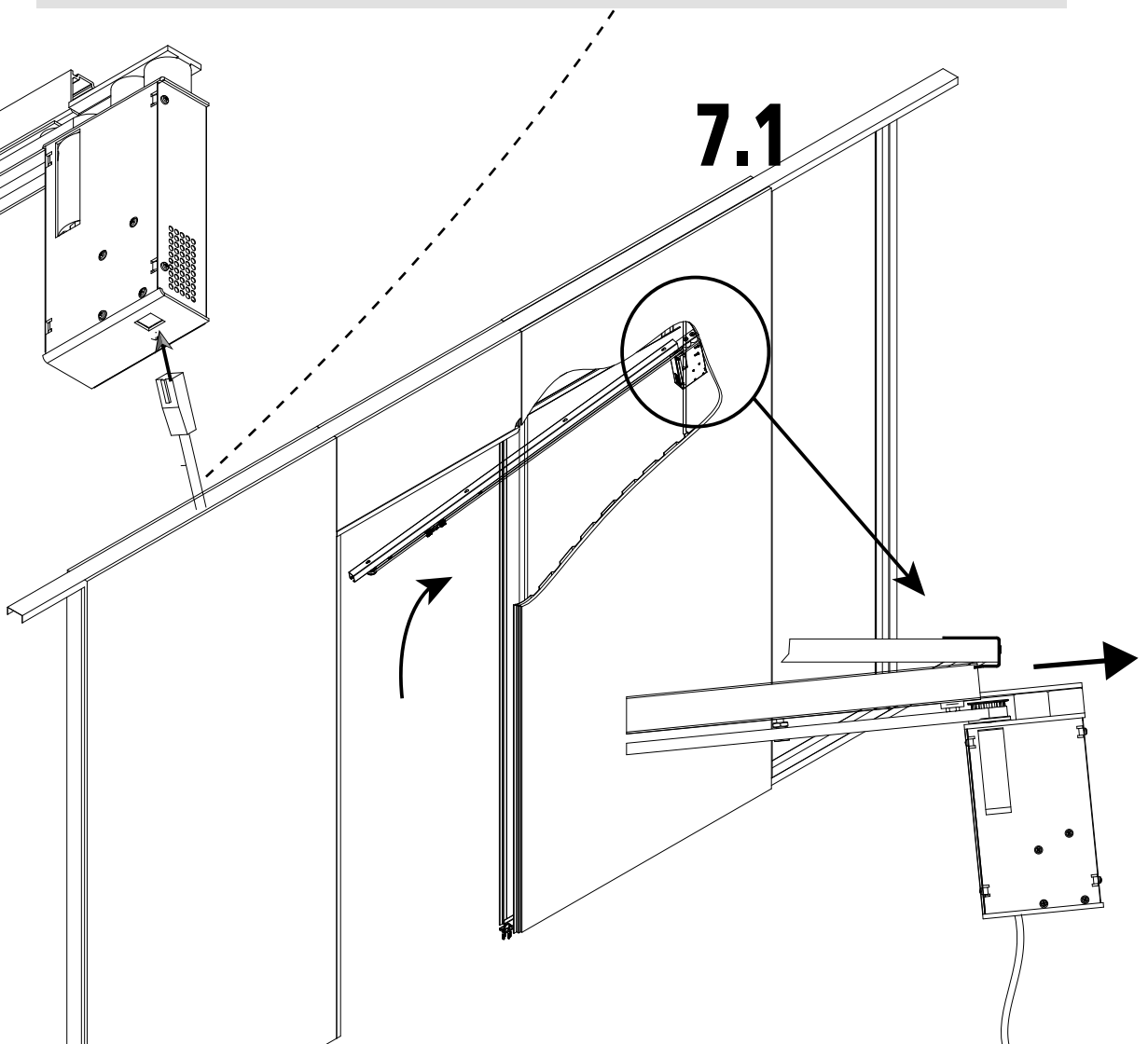

8.

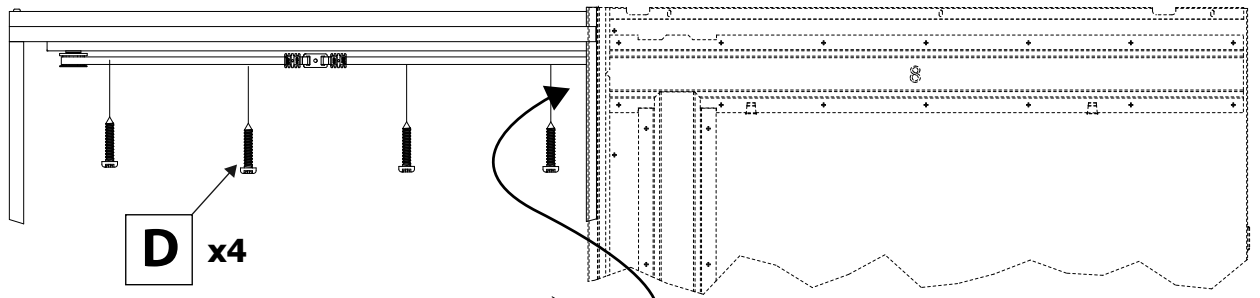

9.

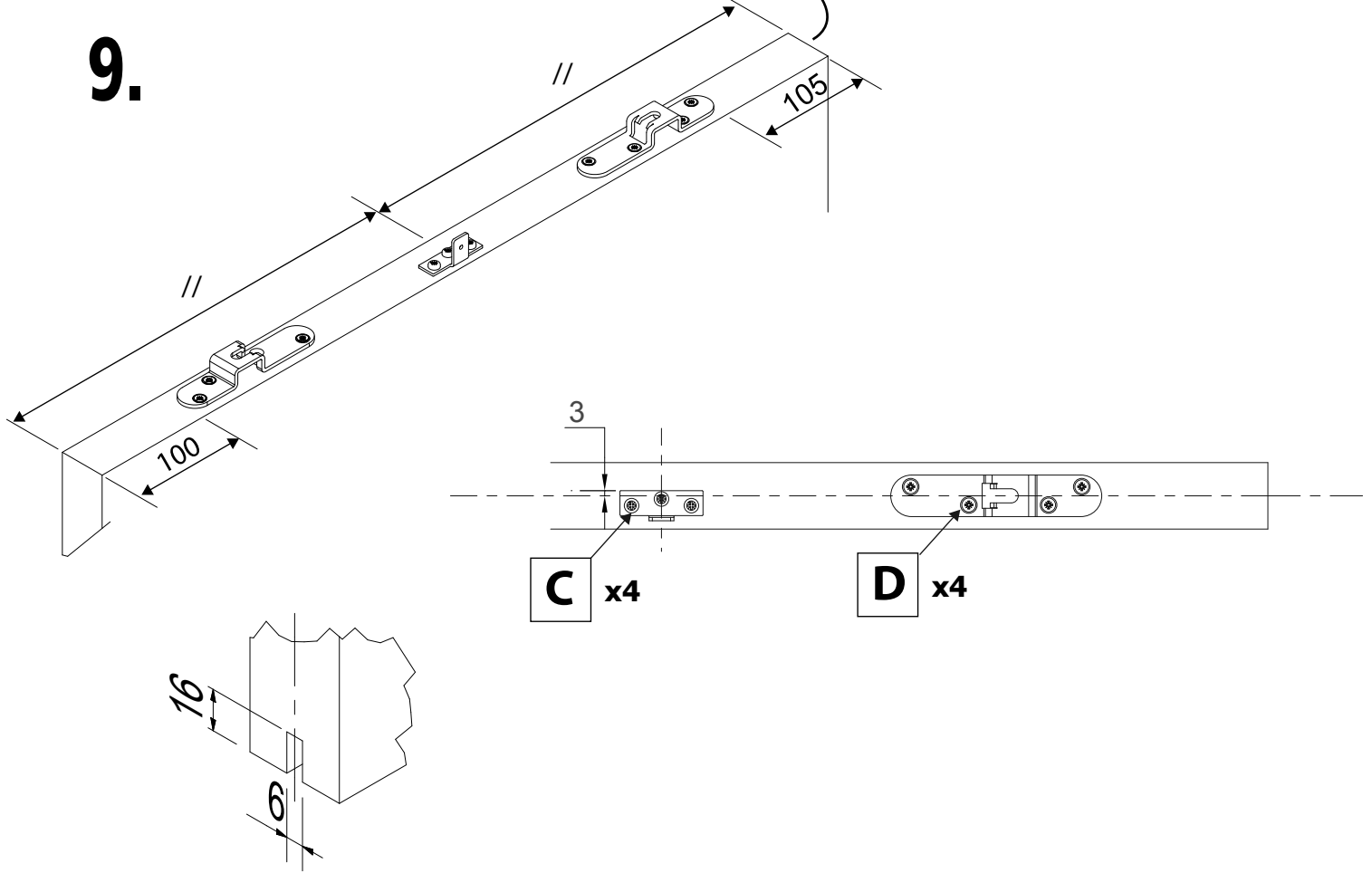

10.

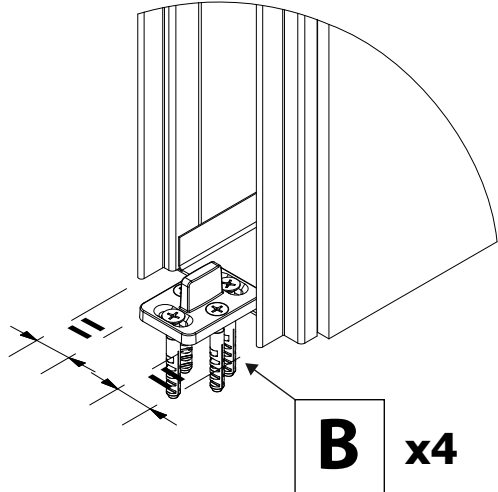

11.

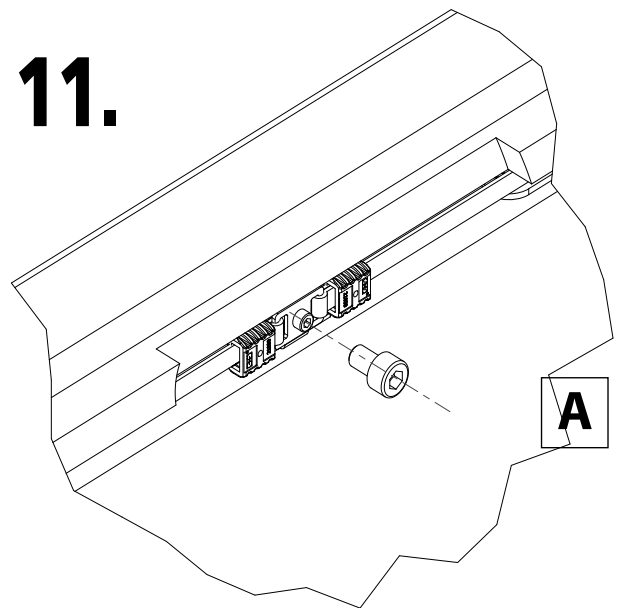

# 12.

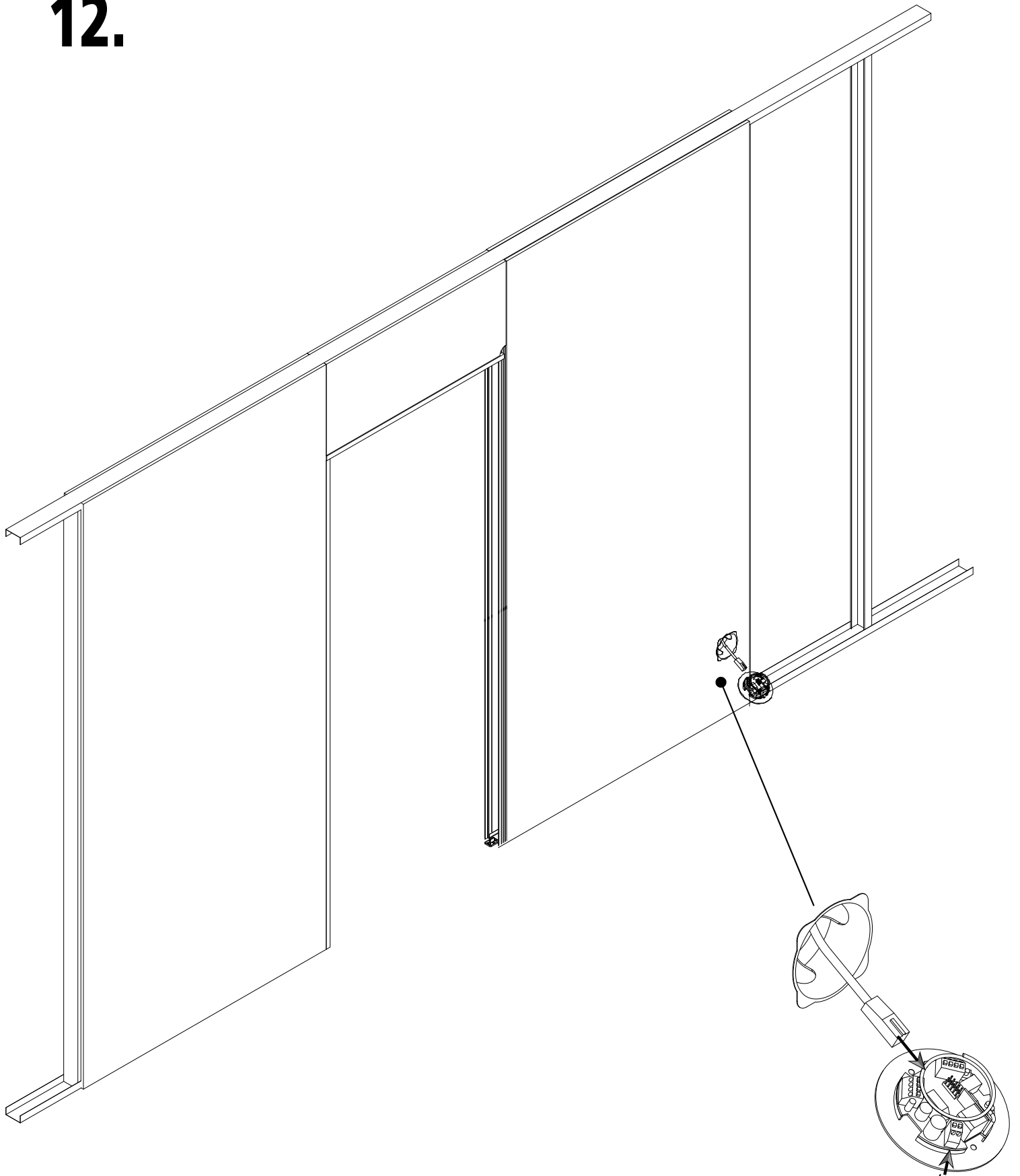

**24V DC**  
**+5%**  
**2.5A**