

# SAF-INSIDE® FRAME FOR SLIDING POCKET DOORS

MANTION Innovation:  
Reinforced Frame Box



## **SOLID:**

Vertical opening reinforcements for higher inertia making the Manton frame box one of the most robust on the market

## **VERSATILE:**

For single or double doors, made of wood or glass  
Motorised system available on request

## **SILENT:**

Resulting from many hours of design and testing, our new fittings provide unmatched effortless and silent movement (100,000 cycles guaranteed!)

## **CONVENIENT:**

Door stop (adjustable clamping force) allowing you to lock the door in open or closed position  
Optional soft-close damper system

## **SAVE SPACE:**

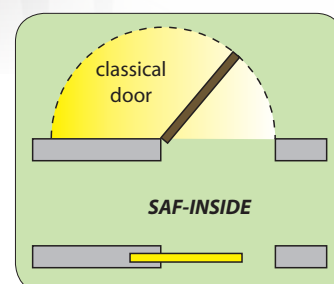

**MANTION**  
HERCULE® - SPORTUB® - MINISPORT®

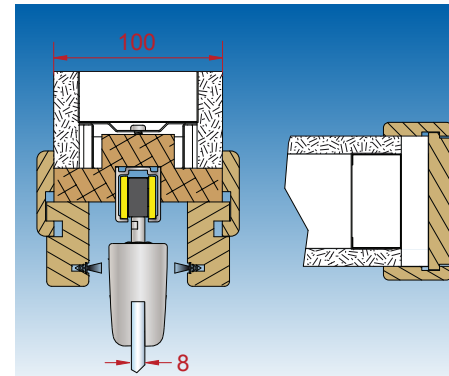
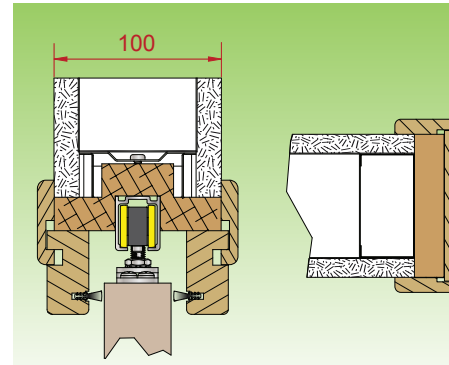
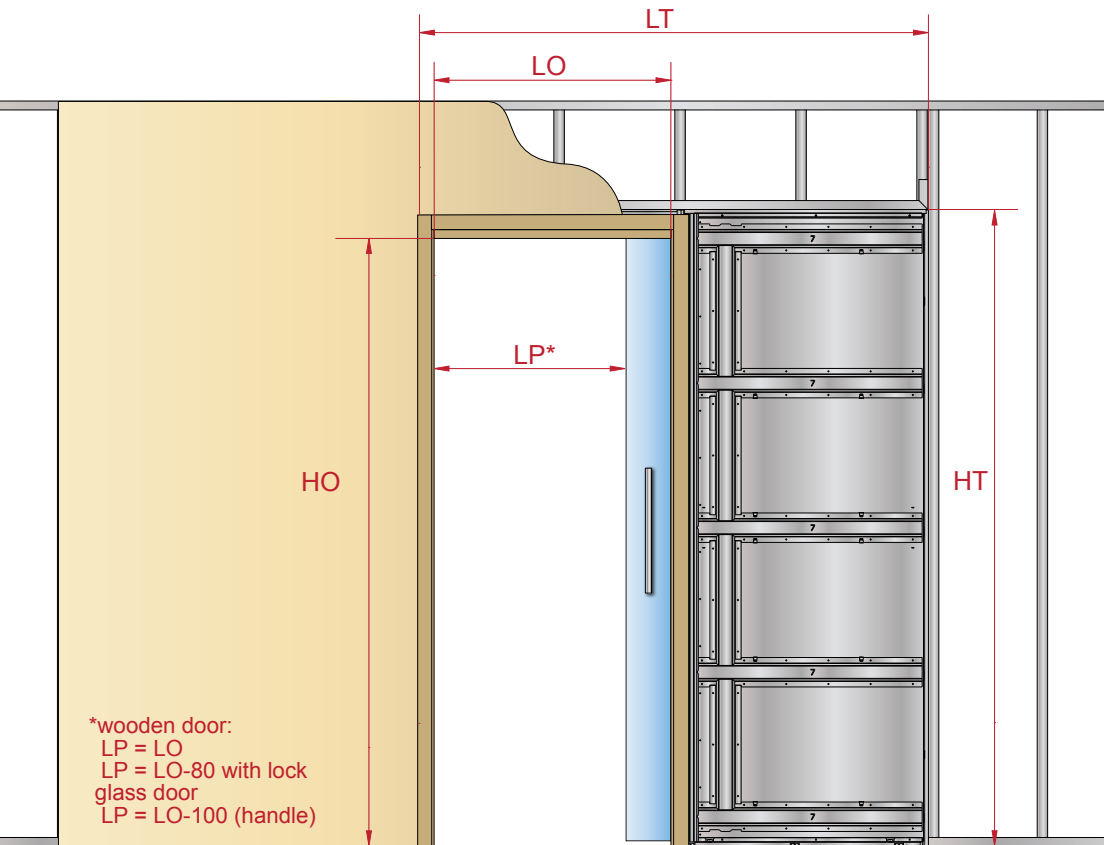

### SET for single wood door (40 mm max.)

ITEM NO.	OPENING LO X HO	FREE PASSAGE LP without lock / with lock	SPACE REQUIRE- MENT LT X HT	FINISHED INTERNAL WALL	PASSAGE	DOOR* W X H
<b>SAF-INSIDE70</b>	695 x 2040	695 / 615	1510 x 2140	100	55	730 x 2040
<b>SAF-INSIDE80</b>	795 x 2040	795 / 715	1710 x 2140	100	55	830 x 2040
<b>SAF-INSIDE789F</b>	Cladding set for MDF door frame – suitable for both items above					*th. 40 mm max. 80 kg max.
<b>SAF-INSIDE90</b>	895 x 2040	895 / 815	1910 x 2140	100	55	930 x 2040
<b>SAF-INSIDE100</b>	995 x 2040	995 / 915	2110 x 2140	100	55	1030 x 2040
<b>SAF-INSIDE9109F</b>	Cladding set for MDF door frame – suitable for both items above					*th. 40 mm max. 80 kg max.

#### SET contents:

- 1 frame box and galvanised steel support structure – 1 reinforcement on casing side and 1 wood track support
- 1 assembled aluminium track – 2 mounting devices (with ball bearings) + plates
- 2 end stops (adjustable stop for closing)
- 1 polyamide guide – Screws and bolts, spanner and installation instructions
- Optional soft-close damper, see page 4

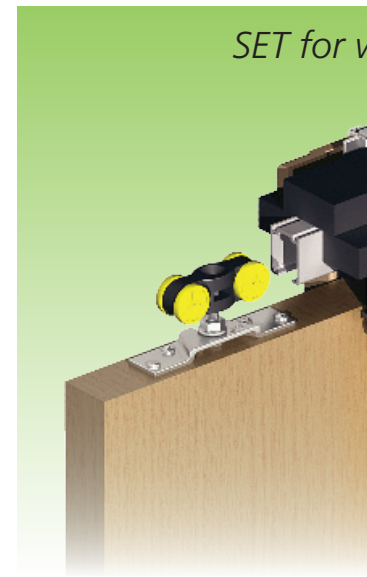

### SET for single glass door (8 mm)

ITEM NO.	OPENING LO X HO	FREE PASSAGE LP	SPACE REQUIRE- MENT LT X HT	FINISHED INTERNAL WALL	PASSAGE	DOOR* W X H
<b>SAF-INSIDECO70</b>	695 x 2040	595	1510 x 2140	100	55	730 x 2015
<b>SAF-INSIDECO80</b>	795 x 2040	695	1710 x 2140	100	55	830 x 2015
<b>SAF-INSIDECO789F</b>	Cladding set for MDF door frame – suitable for both items above					*th. 8 mm 80 kg max.
<b>SAF-INSIDECO90</b>	895 x 2040	795	1910 x 2140	100	55	930 x 2015
<b>SAF-INSIDECO100</b>	995 x 2040	895	2110 x 2140	100	55	1030 x 2015
<b>SAF-INSIDECO9109F</b>	Cladding set for MDF door frame – suitable for both items above					*th. 8 mm 80 kg max.

#### SET contents:

- 1 frame box and galvanised steel support structure – 1 reinforcement on casing side and 1 wood track support
- 1 assembled aluminium track – 2 mounting devices (with ball bearings) supplied with clamp – 2 pelmets
- 2 end stops (adjustable stop for closing)
- 1 polyamide guide
- Screws and bolts, spanner and installation instructions

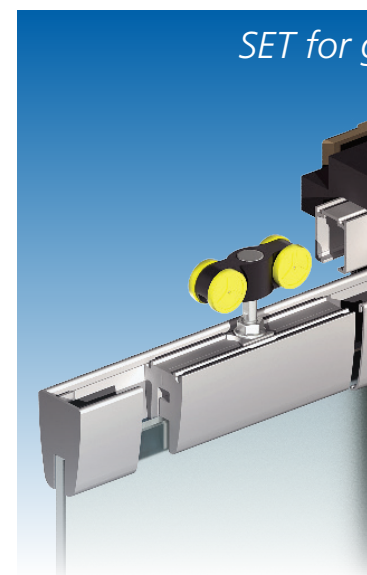

# Frame set for **DOUBLE DOORS** made of wood or glass



Cross-section of frame for wood door

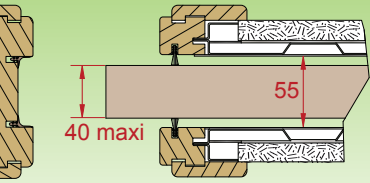

Cross-section of frame for glass door

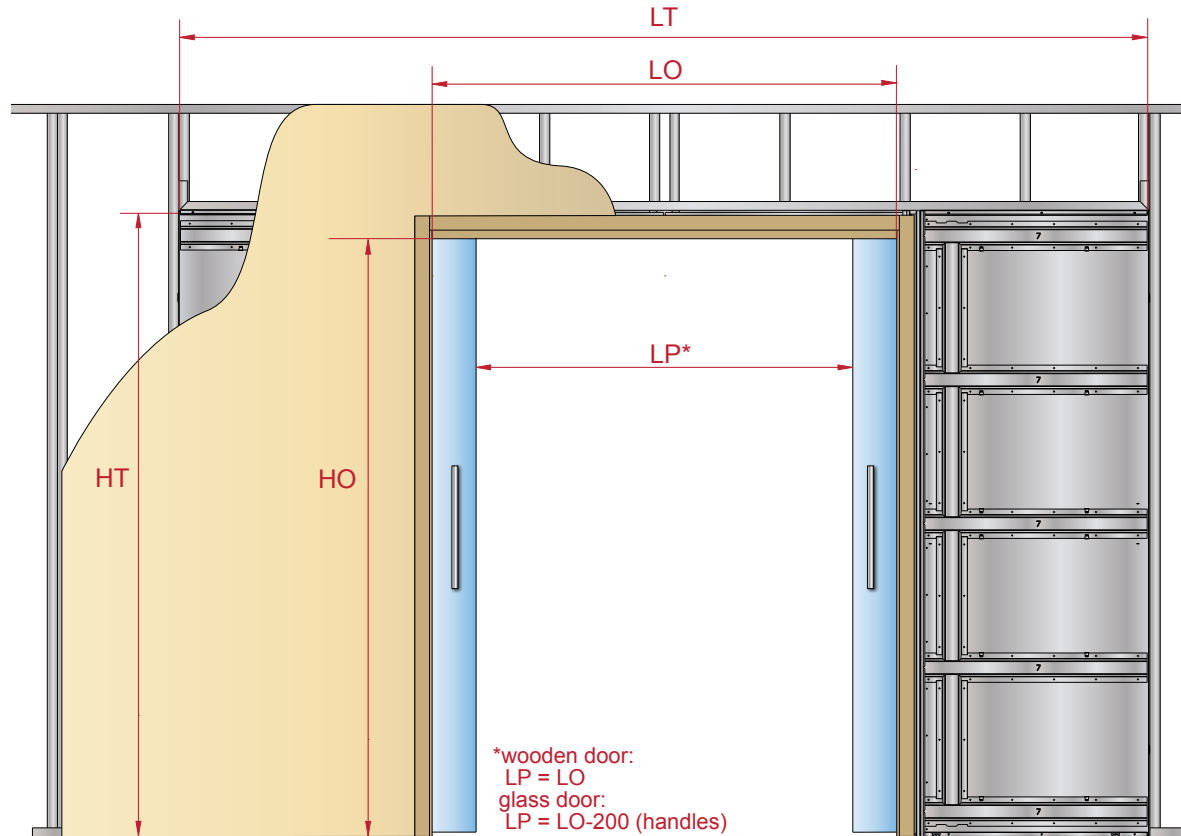
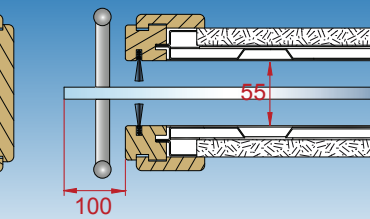

wood door

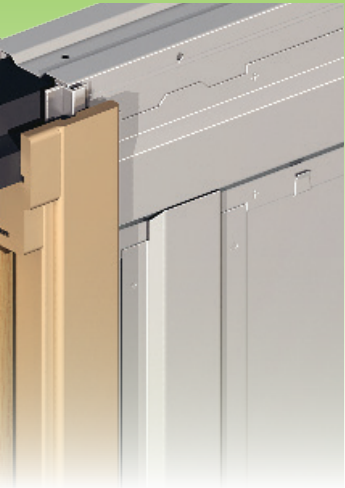

## SET for double wood door (40 mm max.)

ITEM NO.	OPENING LO X HO	FREE PASSAGE LP	SPACE REQUIREMENT LT X HT	FINISHED INTERNAL WALL	PASSAGE	DOOR* W X H
<b>SAF-INSIDE140</b>	1385 x 2040	1385	2915 x 2140	100	55	730 x 2040
<b>SAF-INSIDE160</b>	1585 x 2040	1585	3315 x 2140	100	55	830 x 2040
<b>SAF-INSIDE469F</b>	Cladding set for MDF door frame – suitable for both items above					*th. 40 mm max. 80 kg max.
<b>SAF-INSIDE180</b>	1785 x 2040	1785	3715 x 2140	100	55	930 x 2040
<b>SAF-INSIDE200</b>	1985 x 2040	1985	4115 x 2140	100	55	1030 x 2040
<b>SAF-INSIDE829F</b>	Cladding set for MDF door frame – suitable for both items above					*th. 40 mm max. 80 kg max.

### SET contents:

2 frame boxes with galvanised steel support structure – 2 wood track supports  
2 assembled aluminium tracks with sleeve – 4 mounting devices (with ball bearings) + plates  
4 end stops (adjustable stop for closing)  
2 polyamide guides – Screws and bolts, spanner and installation instructions  
Optional soft-close damper or synchronisation set, see page 4

glass door

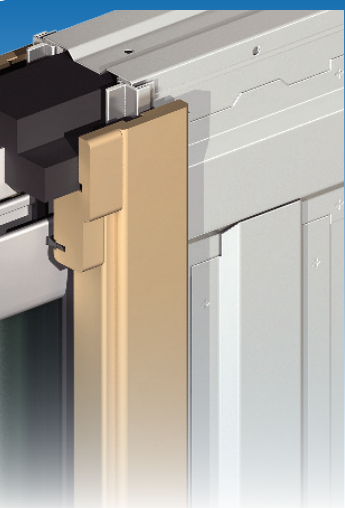

## SET for double glass door (8 mm)

ITEM NO.	OPENING LO X HO	FREE PASSAGE LP	SPACE REQUIREMENT LT X HT	FINISHED INTERNAL WALL	PASSAGE	DOOR* W X H
<b>SAF-INSIDECO140</b>	1385 x 2040	1185	2915 x 2140	100	55	730 x 2015
<b>SAF-INSIDECO160</b>	1585 x 2040	1385	3315 x 2140	100	55	830 x 2015
<b>SAF-INSIDECO469F</b>	Cladding set for MDF door frame – suitable for both items above					*th. 8 mm 80 kg max.
<b>SAF-INSIDECO180</b>	1785 x 2040	1585	3715 x 2140	100	55	930 x 2015
<b>SAF-INSIDECO200</b>	1985 x 2040	1785	4115 x 2140	100	55	1030 x 2015
<b>SAF-INSIDECO829F</b>	Cladding set for MDF door frame – suitable for both items above					*th. 8 mm 80 kg max.

### SET contents:

2 frame boxes with galvanised steel support structure – 2 wood track supports  
2 aluminium rails with sleeve – 4 mounting devices (with ball bearings) supplied with clamp - 4 pelmets  
4 end stops (adjustable stop for closing)  
2 polyamide guides  
Screws and bolts, spanner and installation instructions – optional synchronisation set, see page 4



## ACCESSORIES for wood doors

ITEM NO.	DESIGNATION
<b>Soft-close damper</b>	
<b>66AFP11</b>	Damper system allowing for soft closing of doors. Damper automatically follows door to its closed position. For doors up to 40 kg
<b>66AFP12</b>	Ditto for doors up to 80 kg
<b>Lock</b>	
<b>942</b>	Lock set with 2 round handles and keeper + finger pull Stainless steel
<b>942 C</b>	Ditto with cylinder and 2 keys
<b>Handle Sets</b>	
<b>1280</b>	Set of round stainless steel handles and finger pull
<b>1280A</b>	Set of 2 oval stainless steel handles
<b>1281</b>	Stainless steel finger pull (door edge)
<b>Round ABS flush pull 50 mm Ø</b>	
<b>SU510</b>	Black coating
<b>SU511</b>	White coating
<b>SU512</b>	Red coating
<b>SU513</b>	Brown coating
<b>SU514</b>	Beige coating
<b>SU515</b>	Silvery coating
<b>SU516</b>	Golden coating
<b>Metal finger pull 35 mm Ø (ideal for door edge)</b>	
<b>SU517</b>	Chromed metal
<b>SU518</b>	Golden metal
<b>Rectangular metal flush pull 32 x 75 mm</b>	
<b>SU519</b>	Chromed metal
<b>SU520</b>	Golden metal
<b>Synchronisation set</b>	
<b>11050-2</b>	Synchronisation set for 2 opposing 80-kg doors including: - 2 assembled pulleys - 1 driving bracket - 1 mounting bracket with spring - 1 cable, 2 mm in diameter and 10 m long

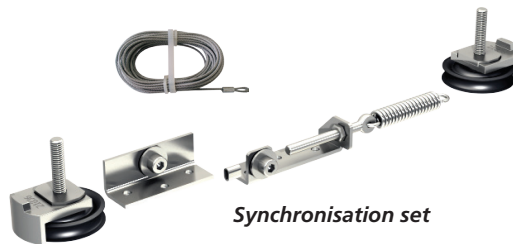
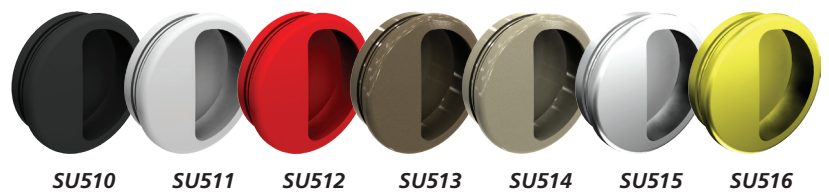
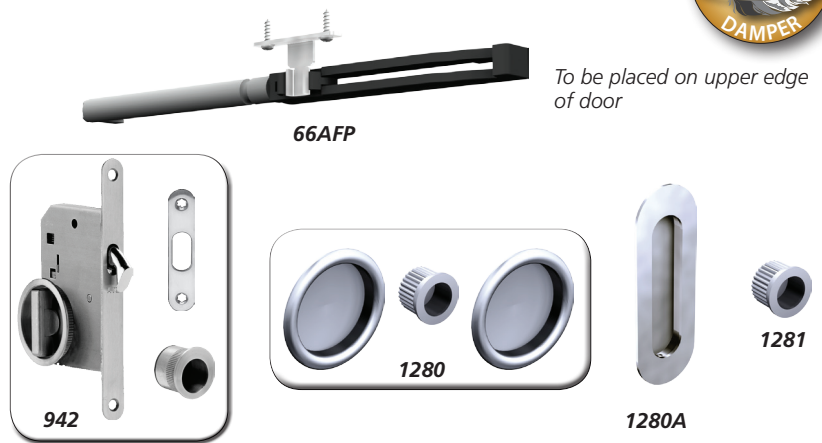

Example SU519 + SU517 handles

## ACCESSORIES for glass doors

ITEM NO.	DESIGNATION
<b>Set of metal handles</b>	
<b>NEPTUNE-300</b>	Brushed stainless steel finish – Height 300 mm 20 mm Ø
<b>VENUS-505</b>	Brushed stainless steel finish – Height 505 mm 20 mm Ø
<b>VENUS-657</b>	Ditto Height 657 mm
<b>VENUS-810</b>	Ditto Height 810 mm
<b>MARS-325</b>	Brushed stainless steel finish – Height 325 mm 20 mm Ø
<b>MARS-375</b>	Ditto Height 375 mm
<b>MERCURE-330</b>	Brushed stainless steel and anodised aluminium finish for centre part – Height 330 mm 25 mm Ø
<b>MERCURE-370</b>	Ditto Height 370 mm
<b>Set of polycarbonate handles</b>	
<b>102099</b>	Polycarbonate flush pull 69.5 mm Ø
<b>102099-2</b>	Chromed metal flush pull 55 mm Ø
<b>102101</b>	Polycarbonate knob 37 mm Ø
<b>102101-1</b>	Chromed metal knob 30 mm Ø
<b>102101-2</b>	Chromed metal knob 50x60 mm
<b>Seal</b>	
<b>66JN/250</b>	Adhesive dual-material seal to be fitted on door edge to dampen closure
<b>Synchronisation set</b>	
On request, please contact us	

