

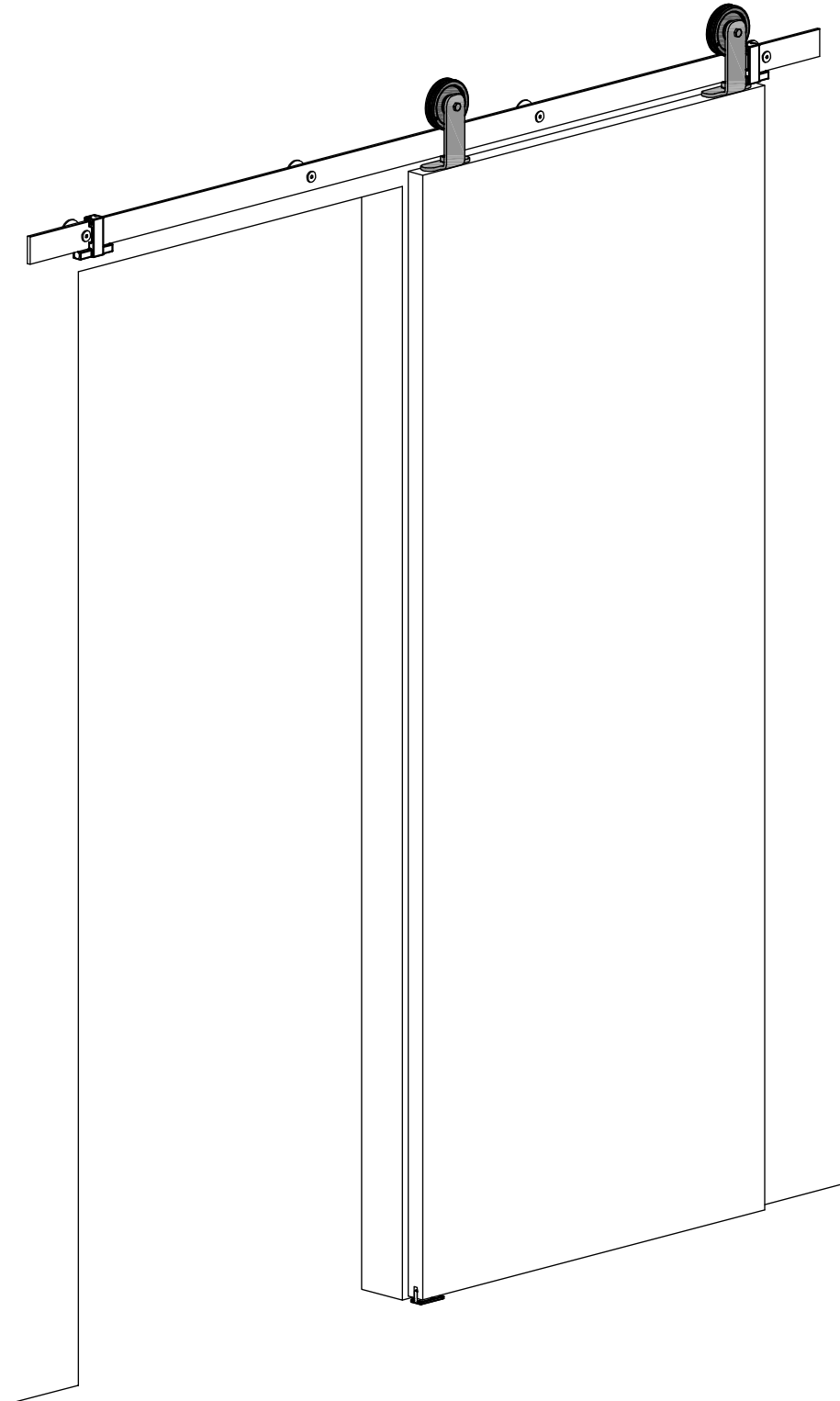

INSTRUCTION DE MONTAGE  
MONTAGEANLEITUNG  
INSTRUCTIONS FOR ASSEMBLY  
INSTRUCCIONES DE MONTAJE

# ROC DESIGN RD-E-B / RD-E-C

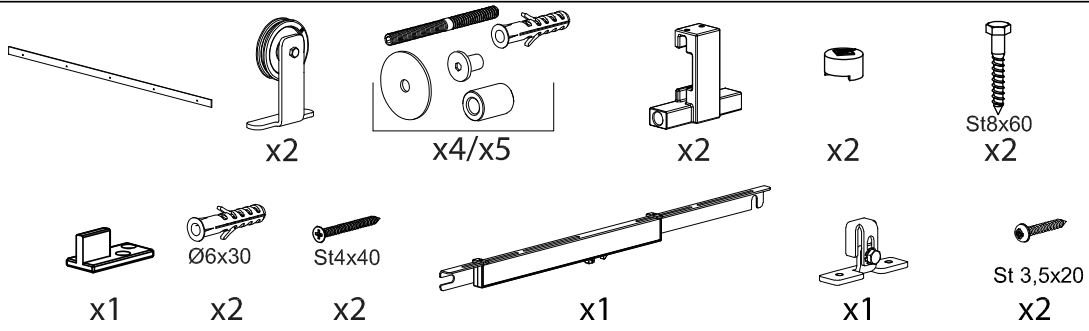



1

a)

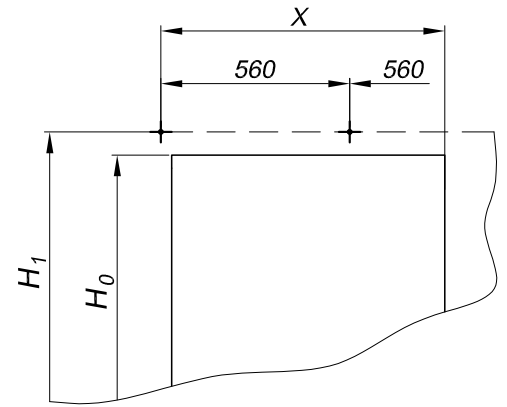
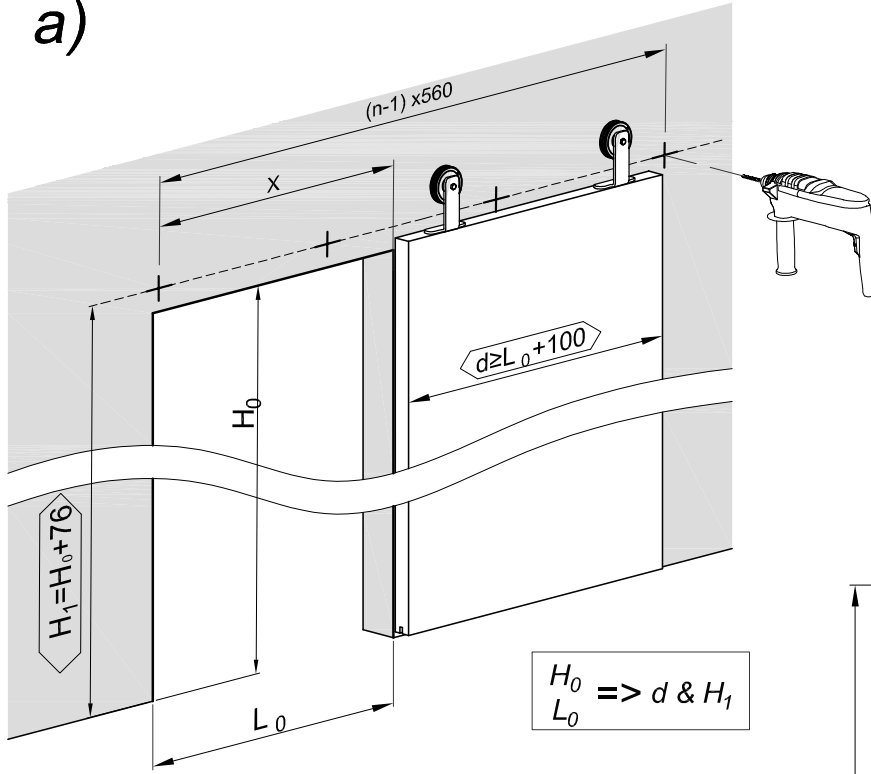

$L_{Track}$ [mm]	1950	2400
$X$ [mm]	840	1120
$n$	4	5

$H_0 \Rightarrow d \& H_1$   
 $L_0$

b)

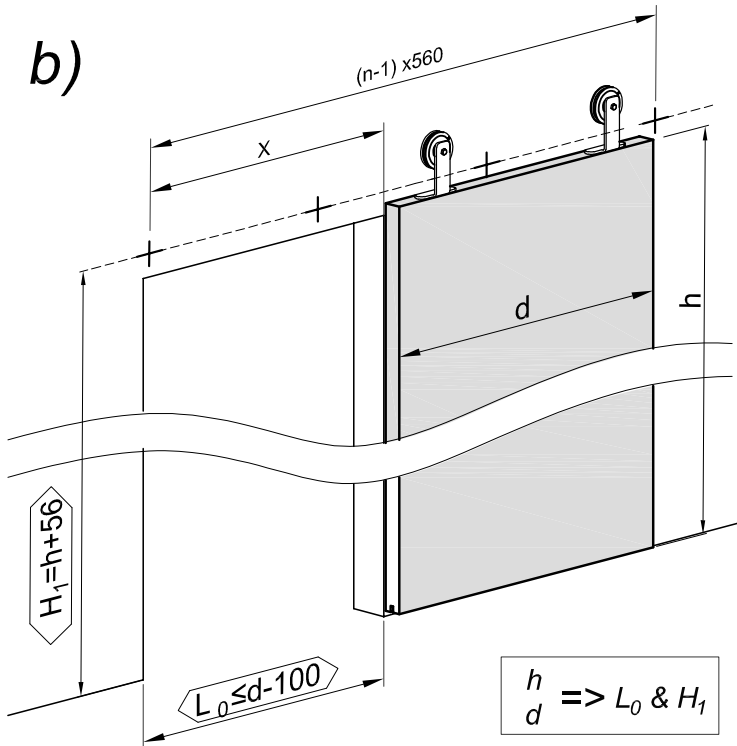

$H_1$

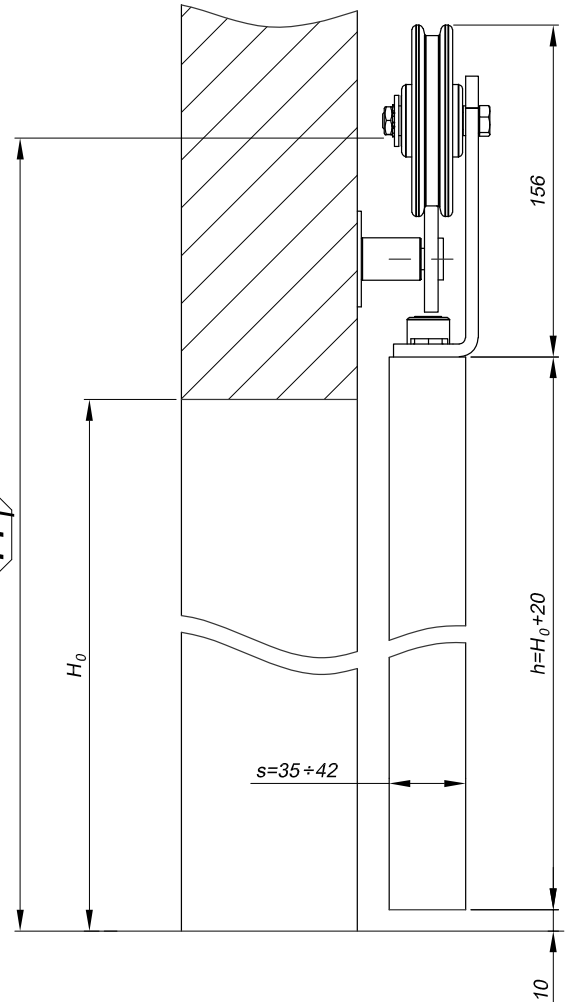

NM\_RD\_008

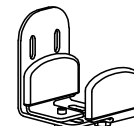

$H_1 = H_0 + 81$   
 $H_1 = h + 61$



2

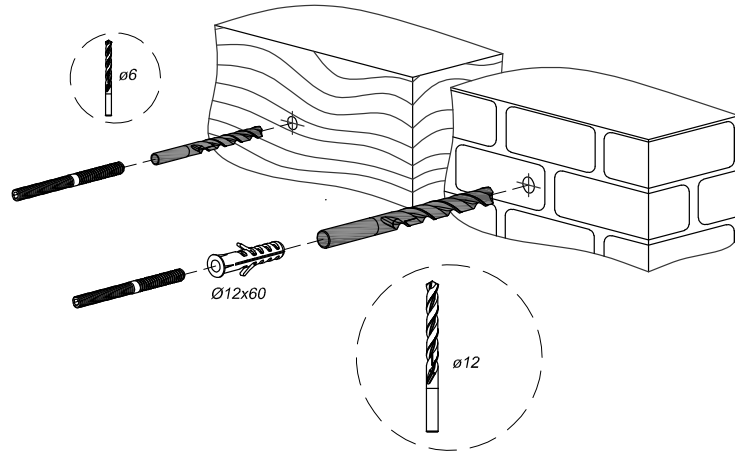
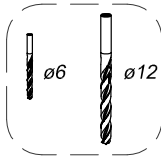

3

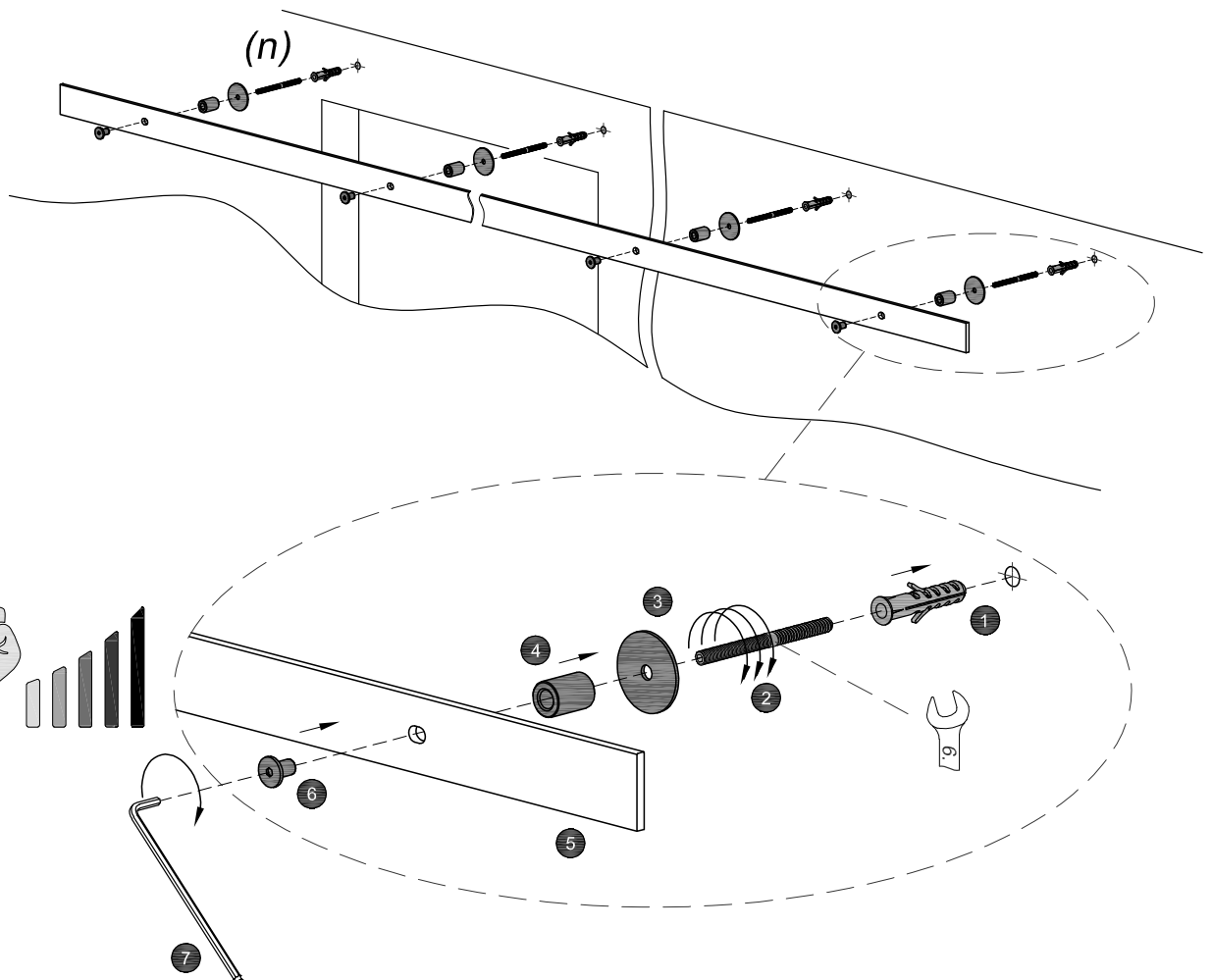
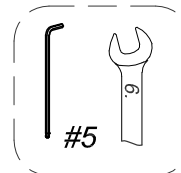
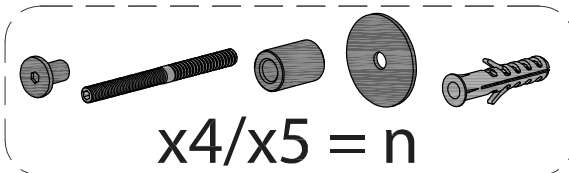



4

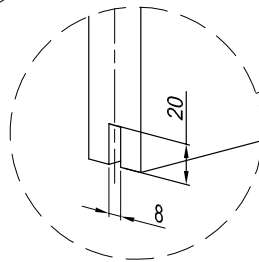
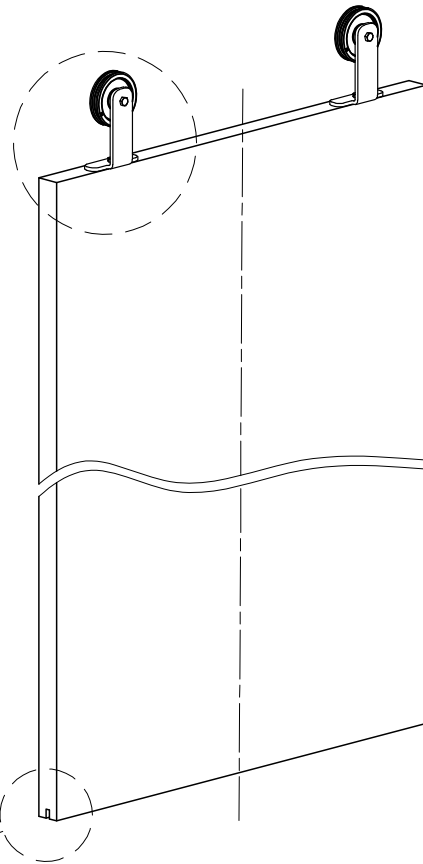
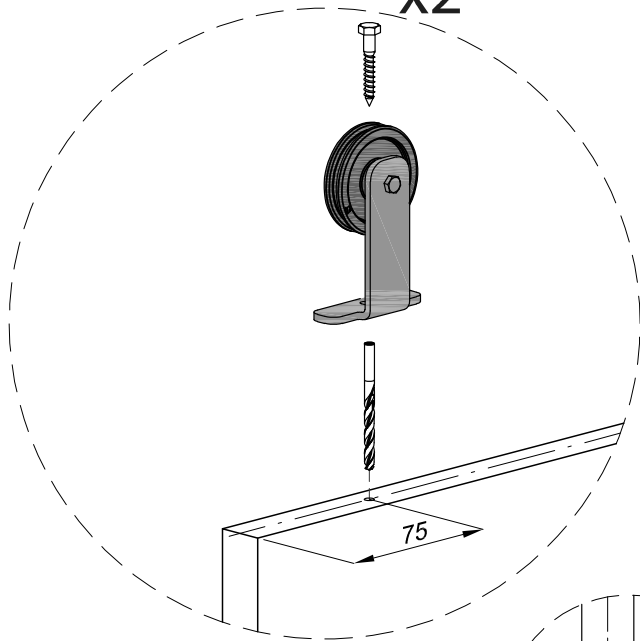
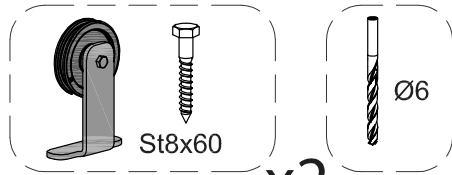

5

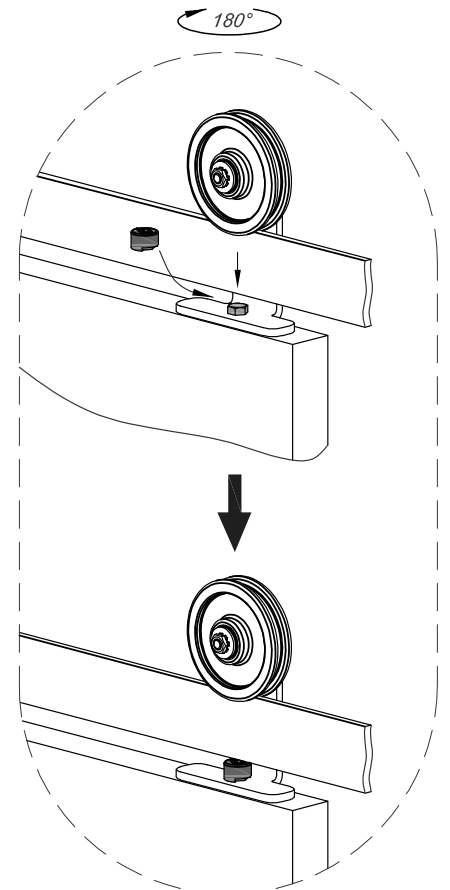
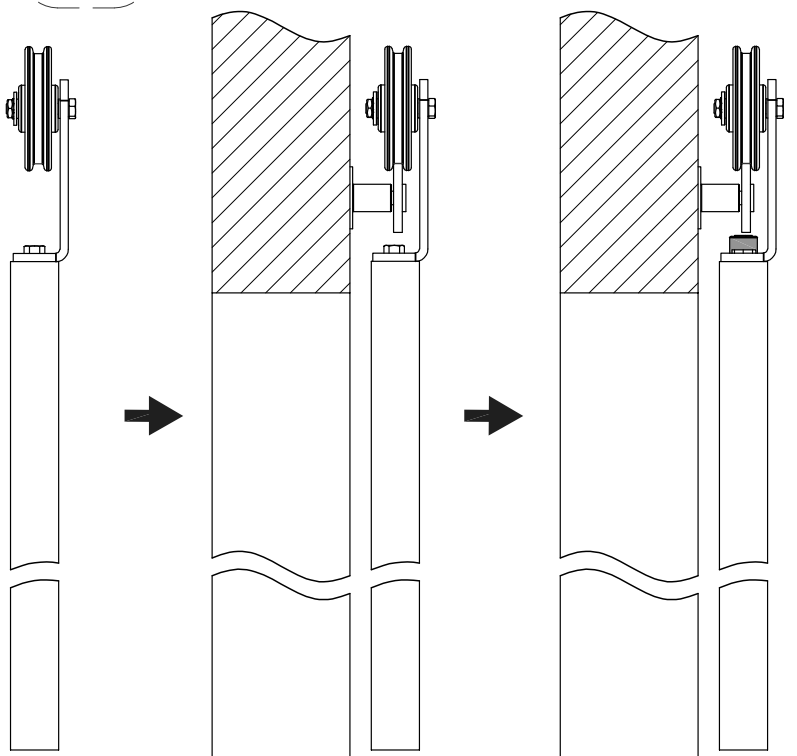



INSTRUCTION DE MONTAGE  
MONTAGEANLEITUNG  
INSTRUCTIONS FOR ASSEMBLY  
INSTRUCCIONES DE MONTAJE

# ROC DESIGN RD-E-B / RD-E-C

6

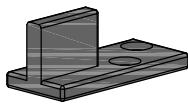

2xSt4x40



2xØ6x30

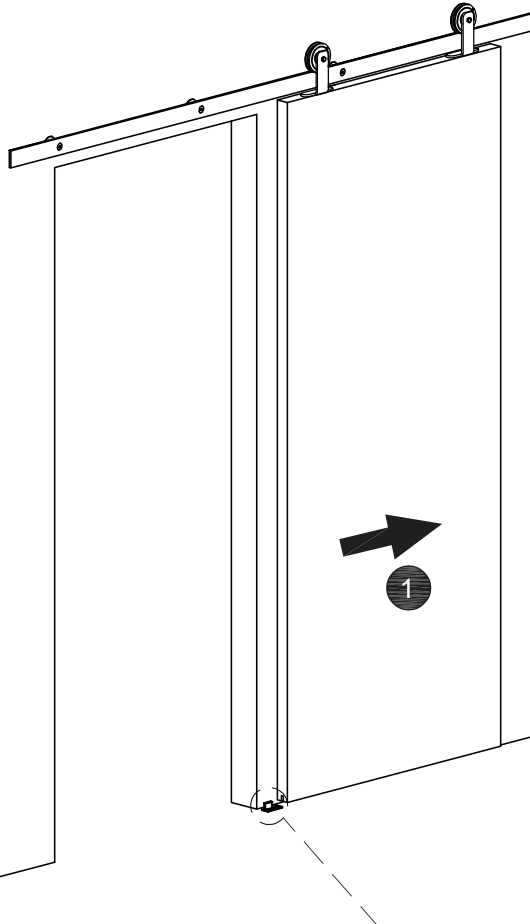
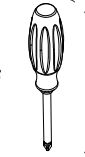

1

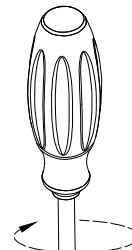

2

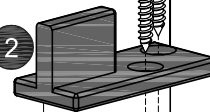

3



**7**

x2

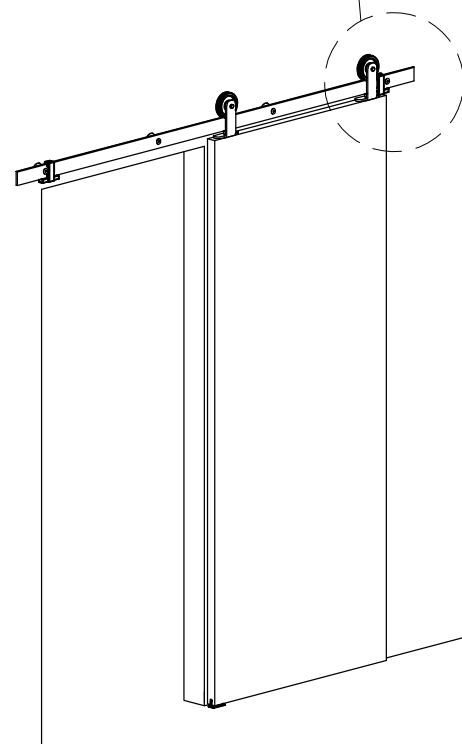
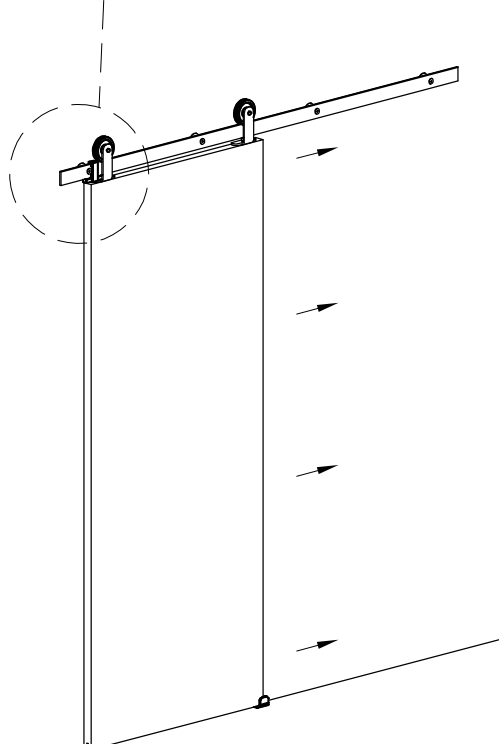
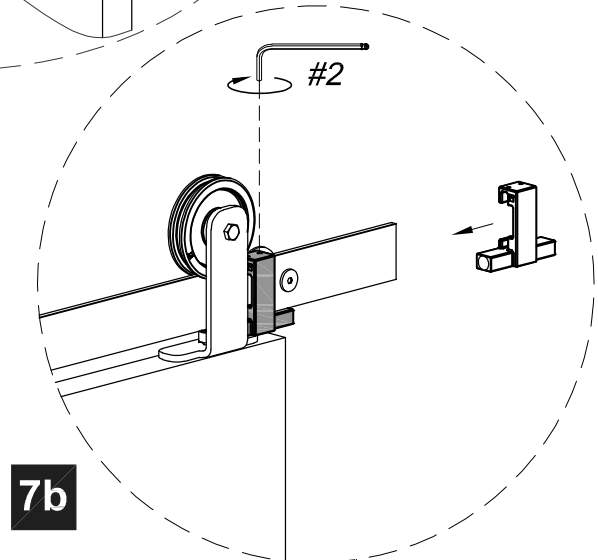
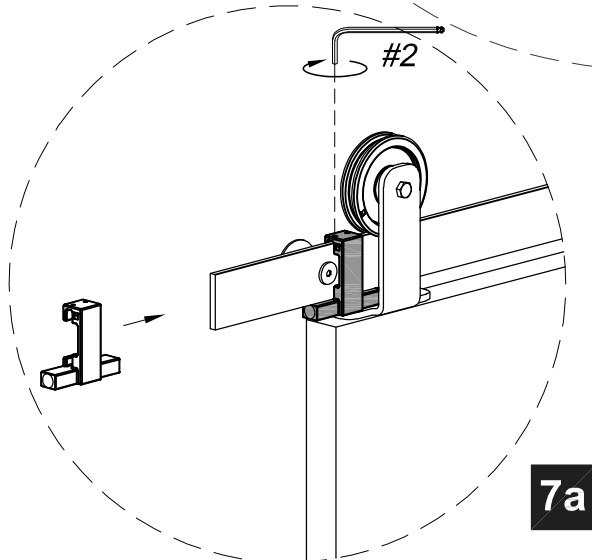
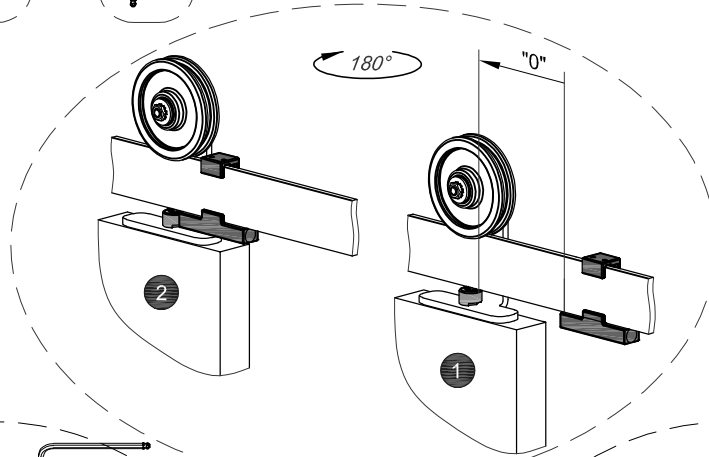
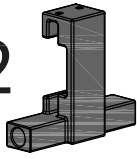

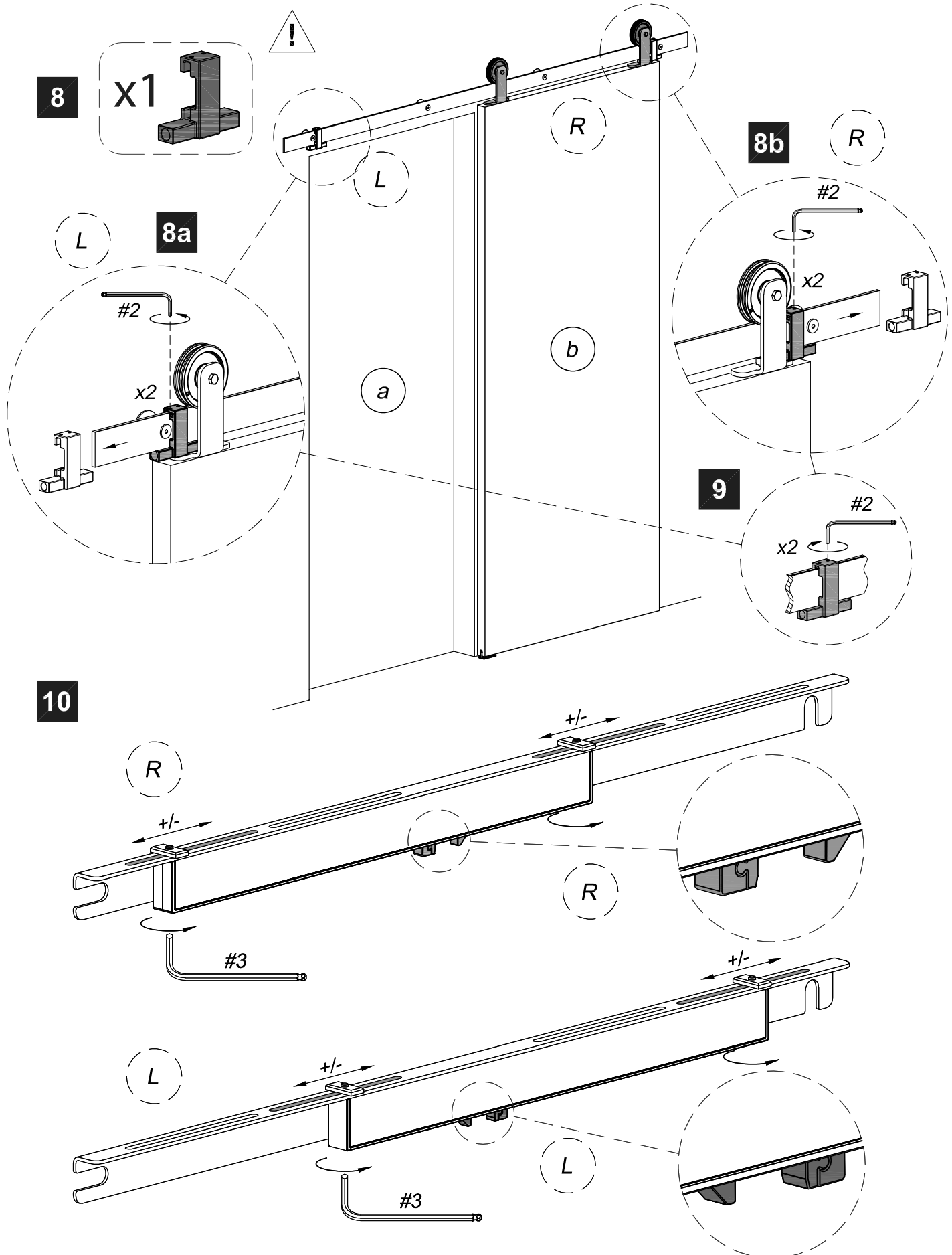



11

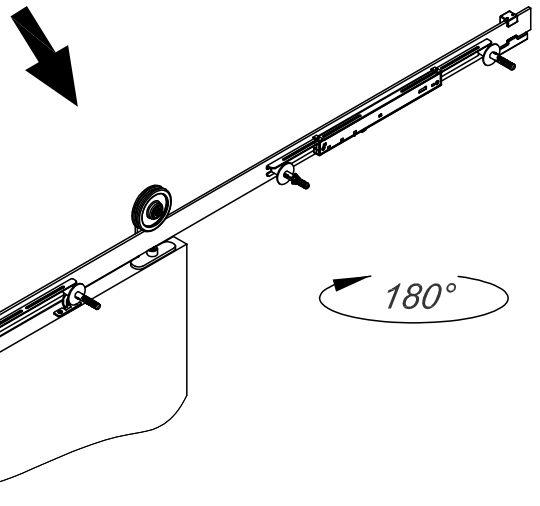
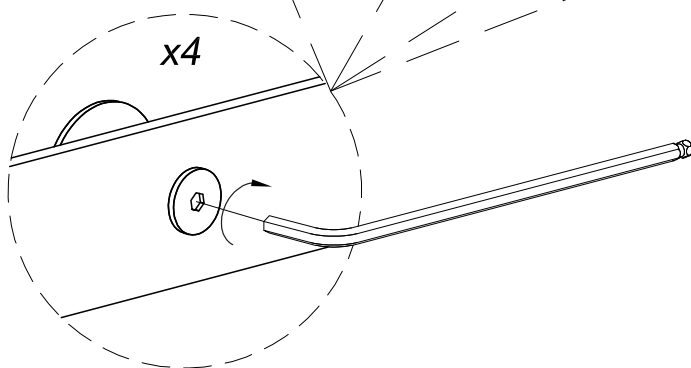
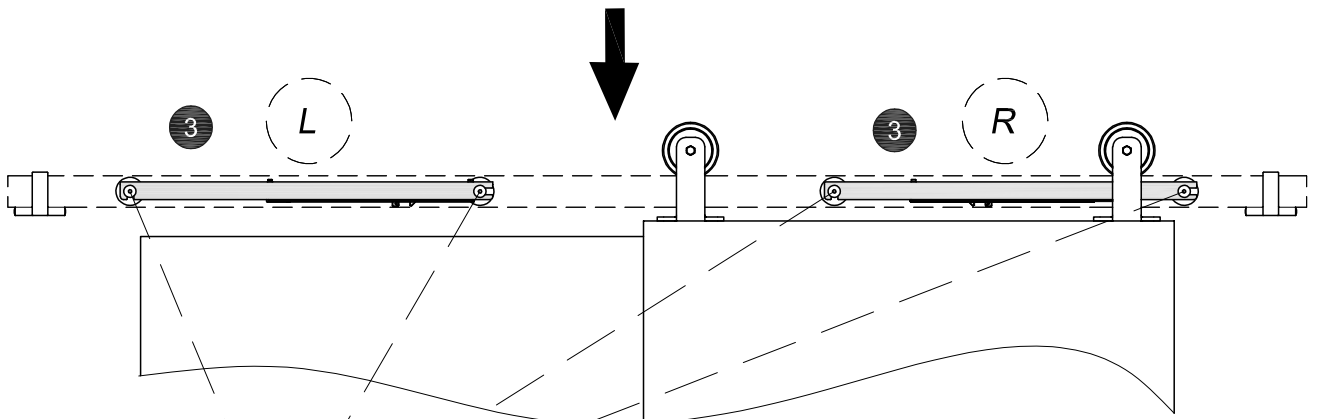
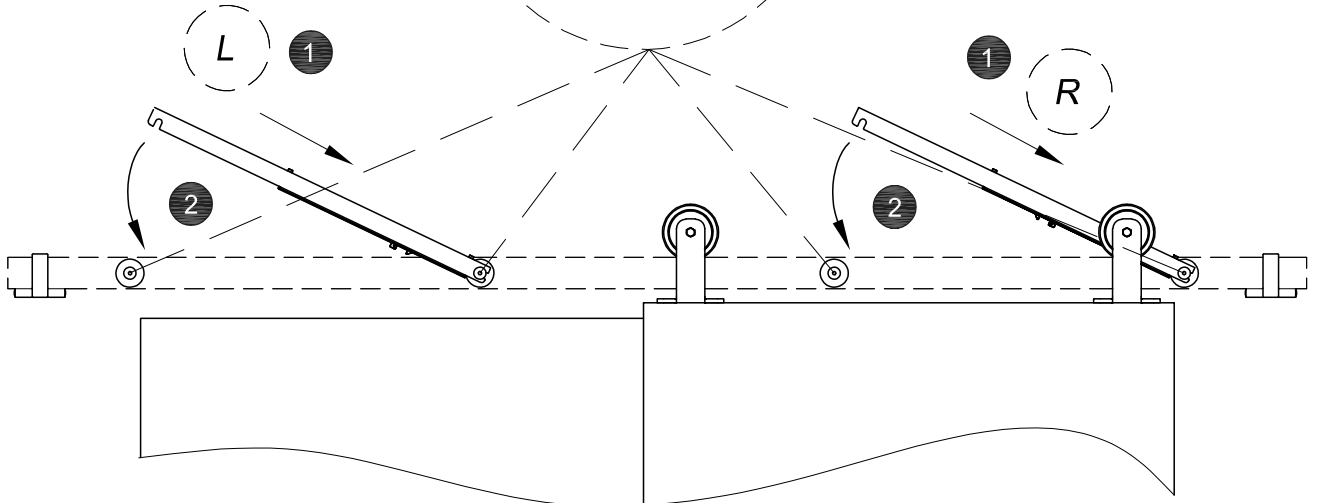
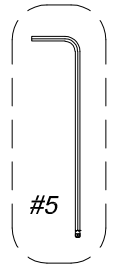
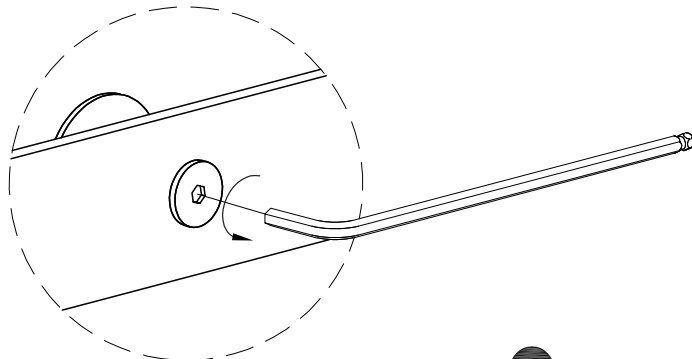





12

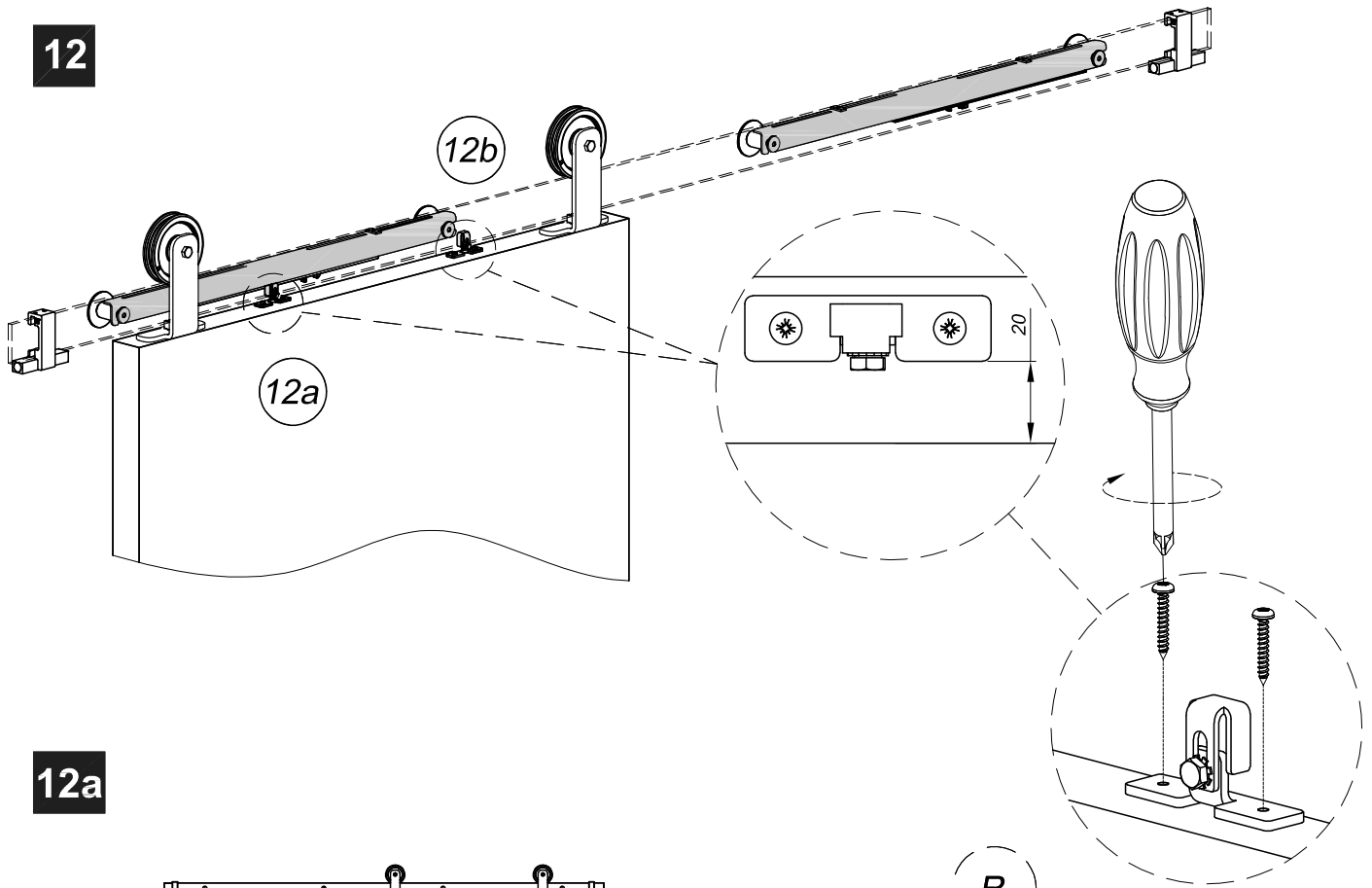

12a

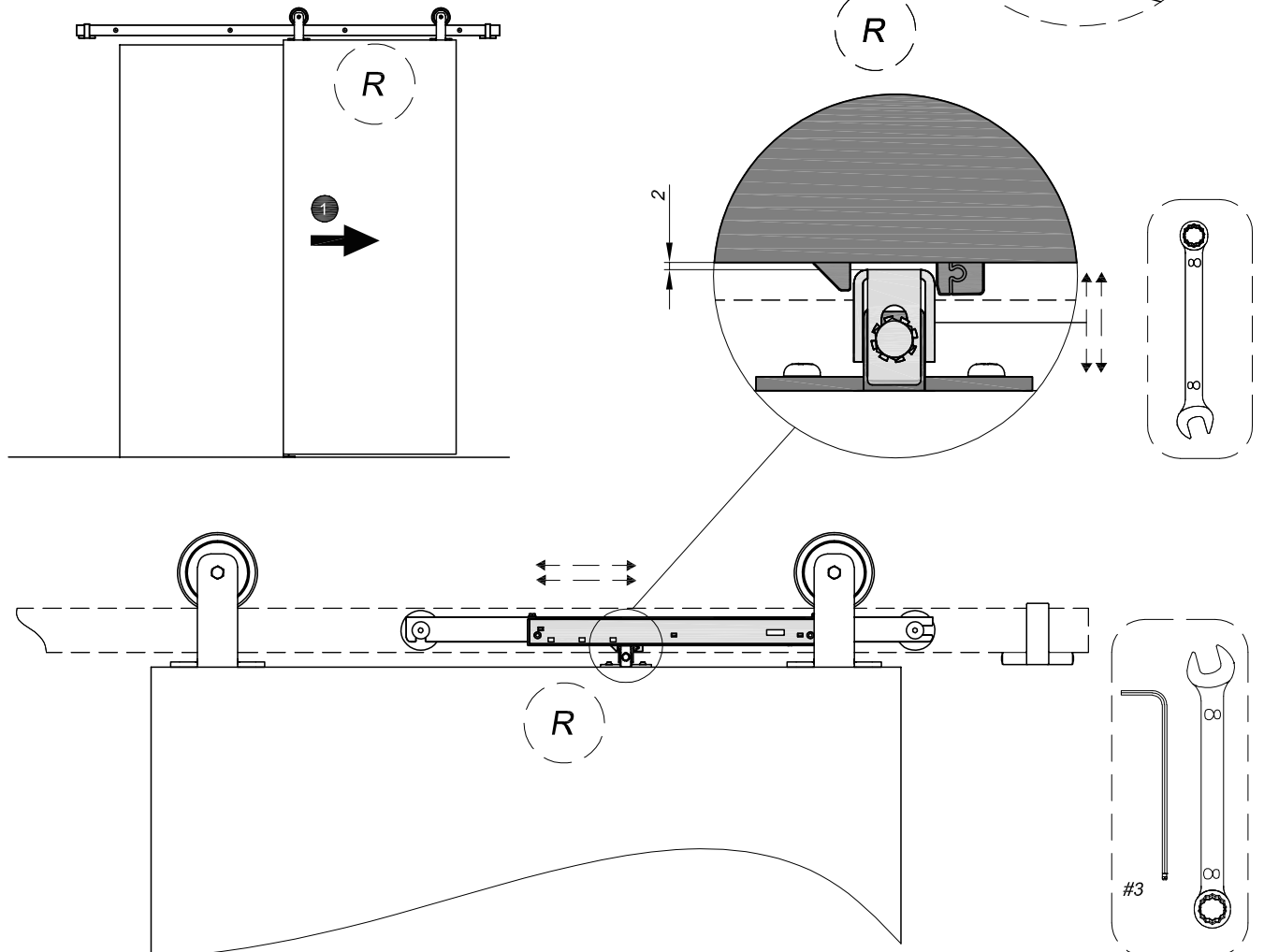



12b

