

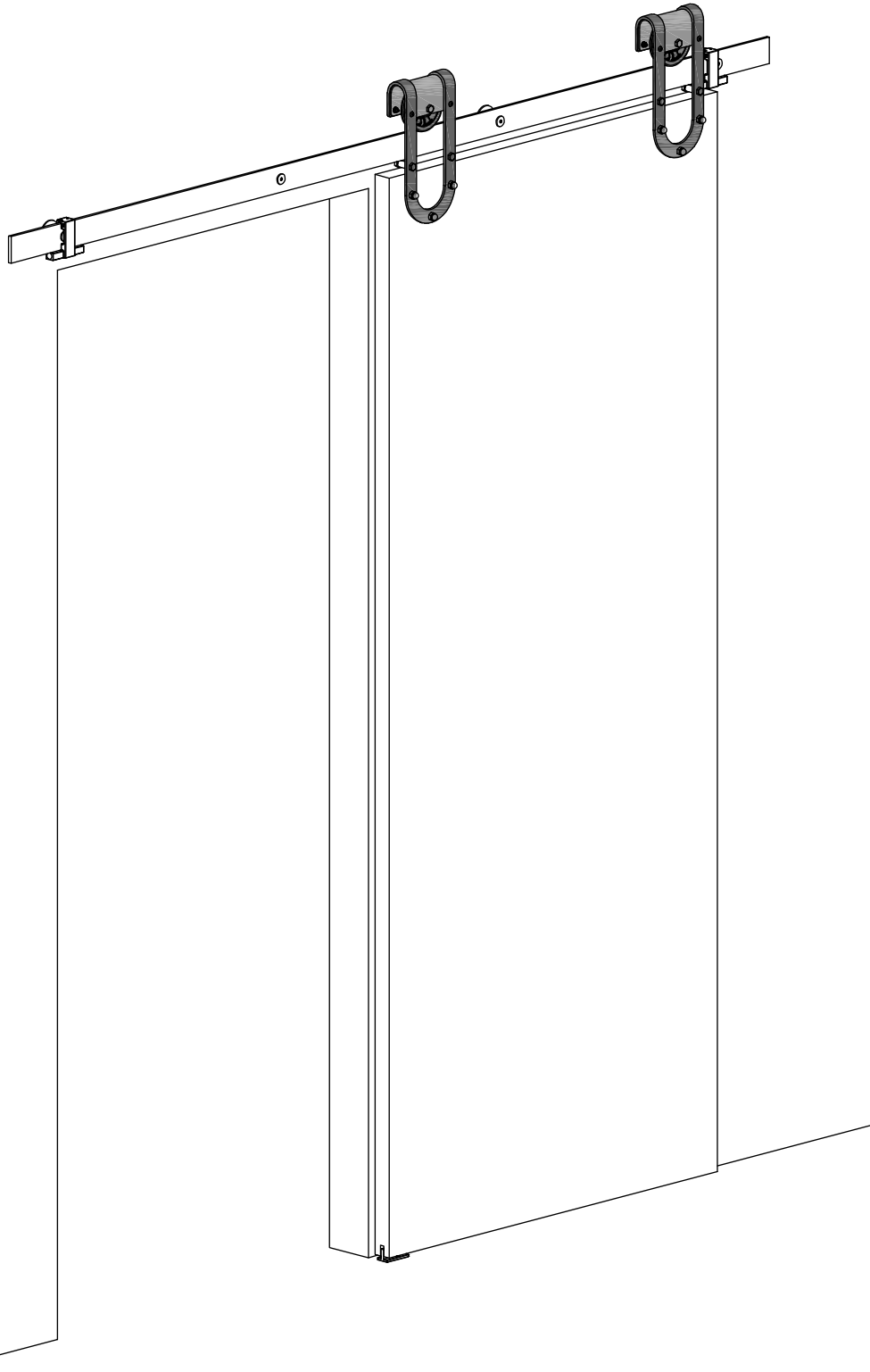

INSTRUCTION DE MONTAGE
MONTAGEANLEITUNG
INSTRUCTIONS FOR ASSEMBLY
INSTRUCCIONES DE MONTAJE

ROC DESIGN RD-B-B / RD-B-C

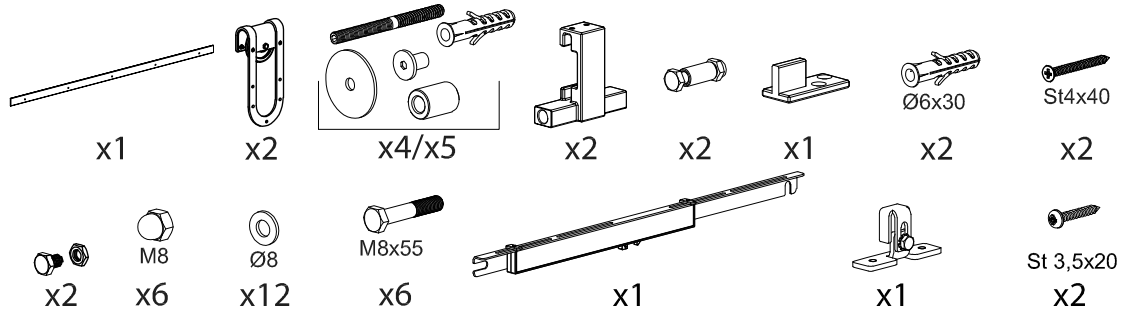



1

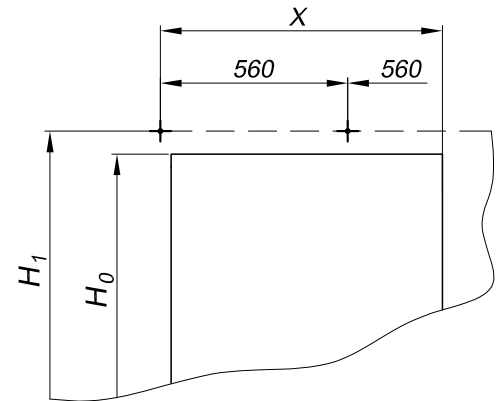
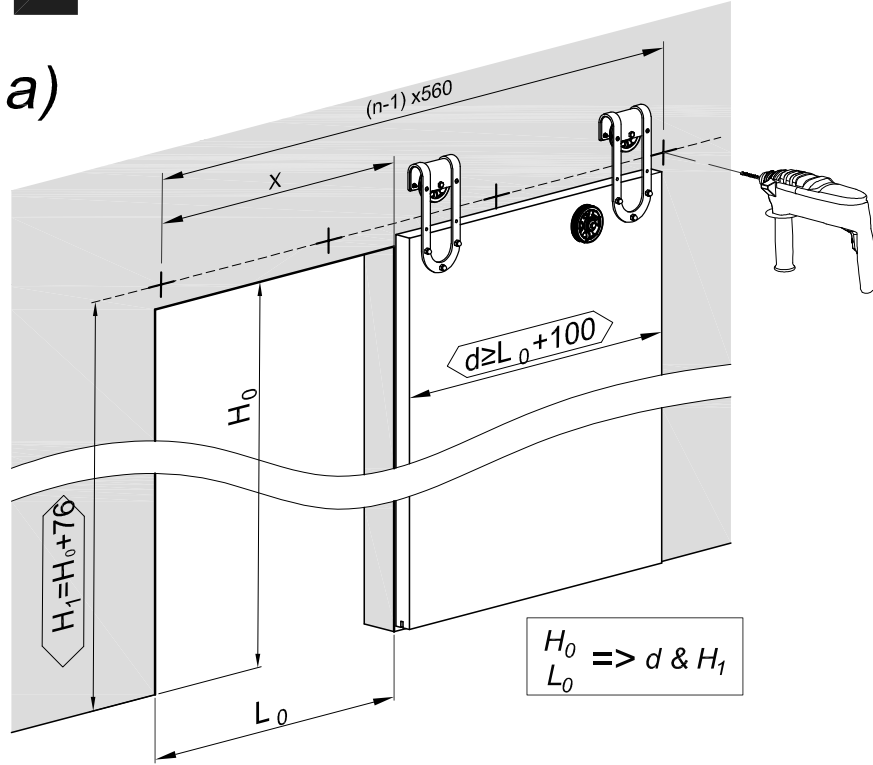

L_{Track} [mm]	1950	2400
X [mm]	840	1120
n	4	5

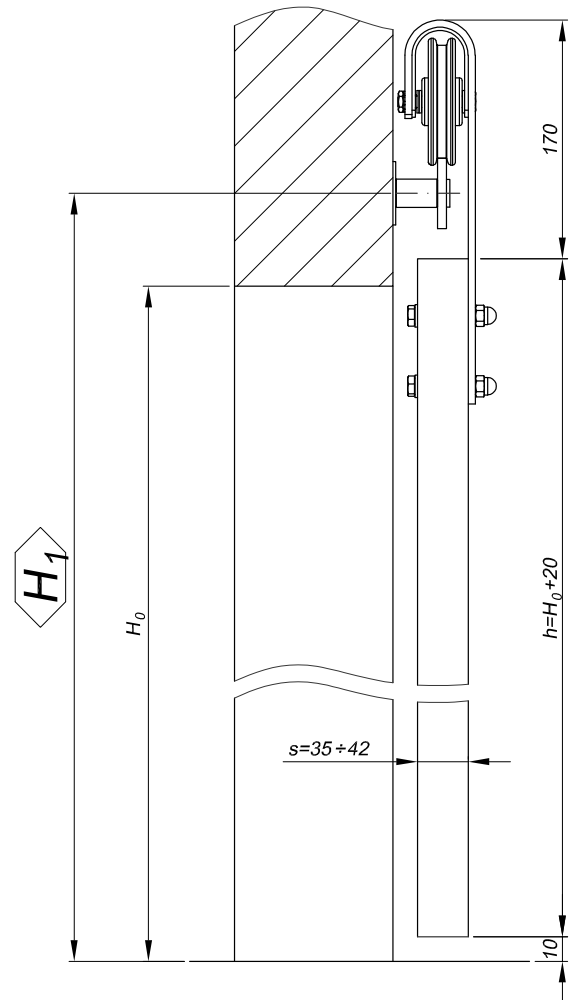
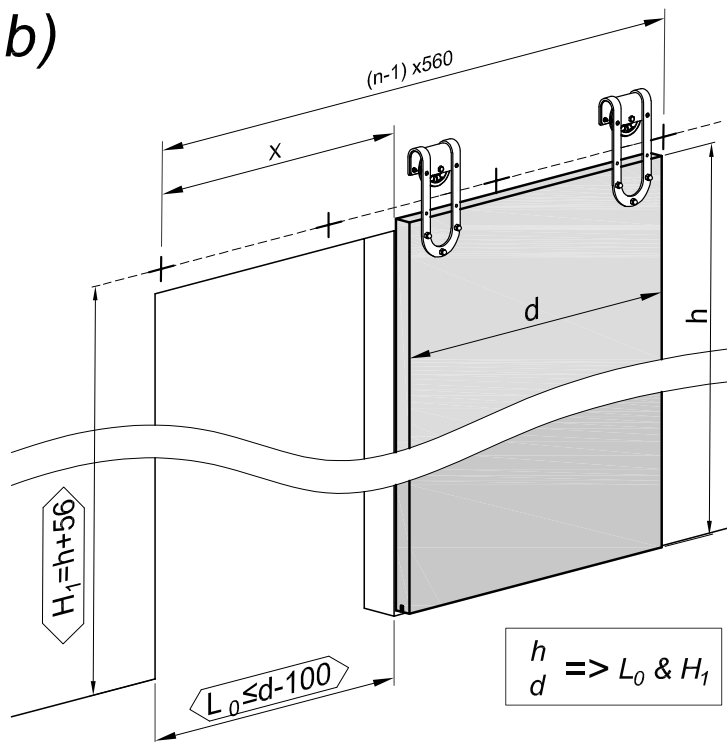

NM_RD_008

$H_1 = H_0 + 81$
 $H_1 = h + 61$



2

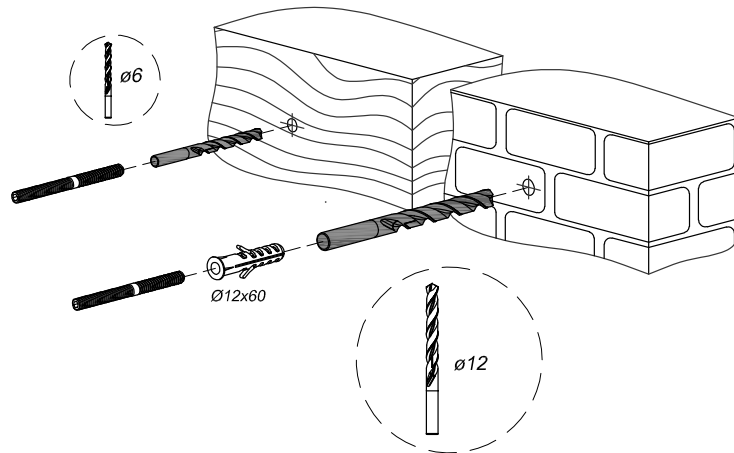
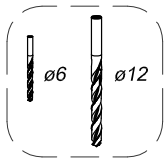

3

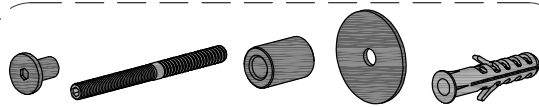

x4/x5 = n

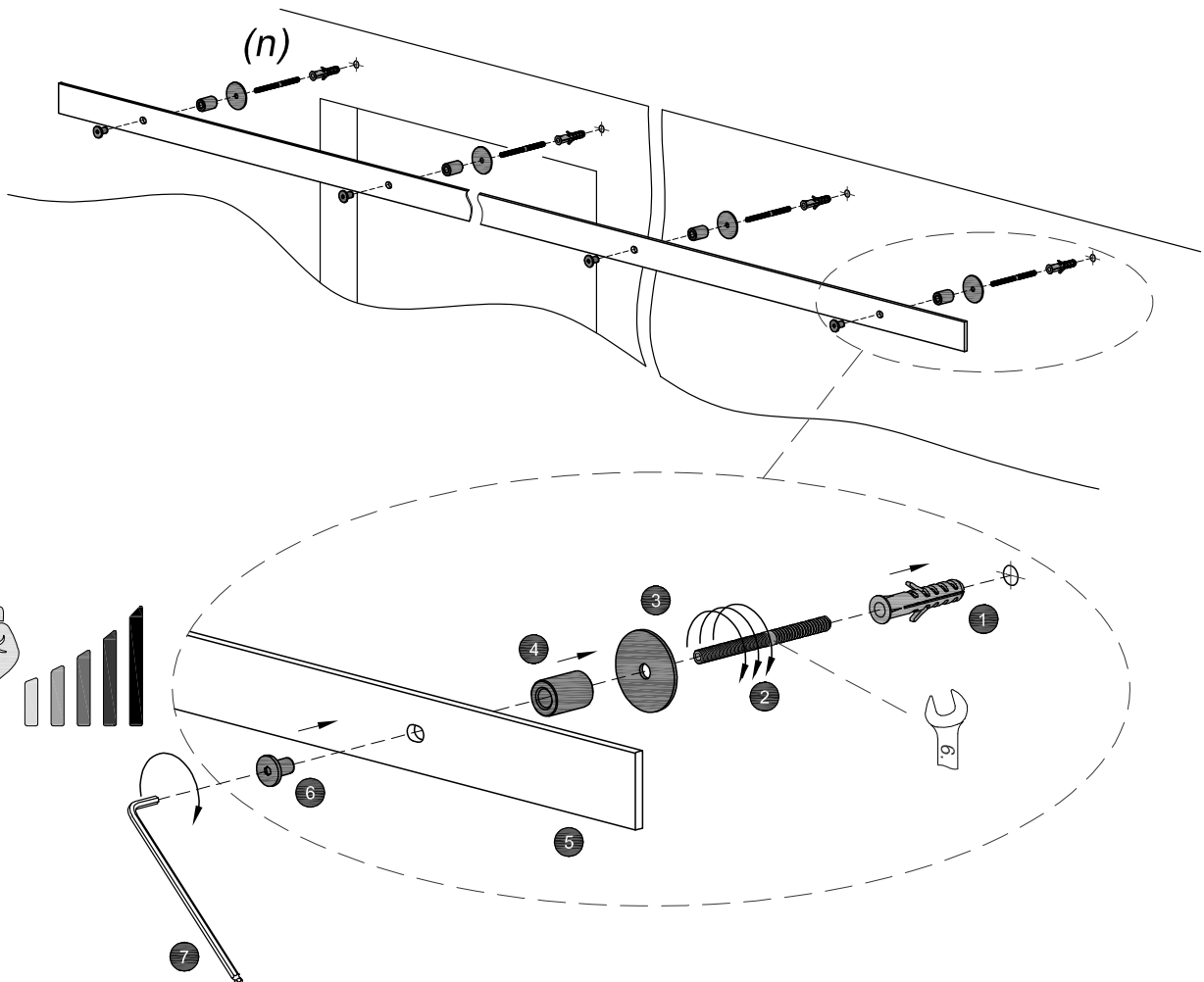
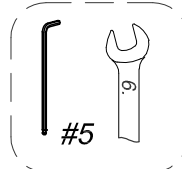



4

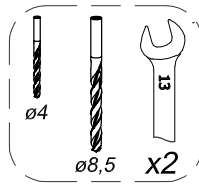
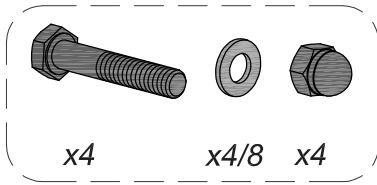

L

R

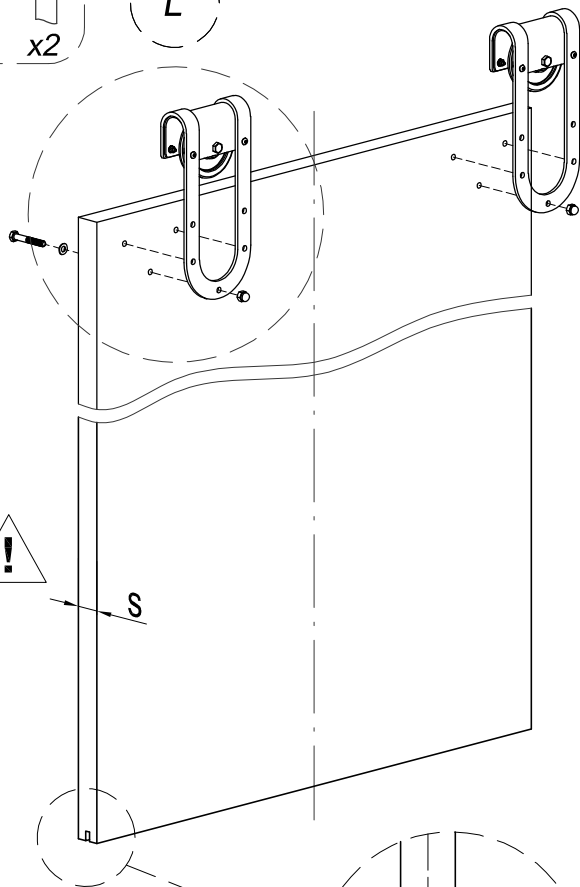

4.1

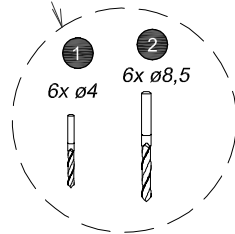
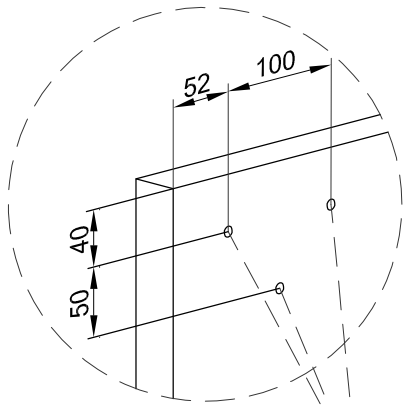

4.2

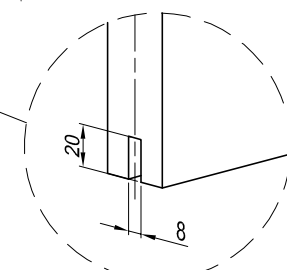

! $35 < s < 38$

$38 \leq s < 42$

4.3

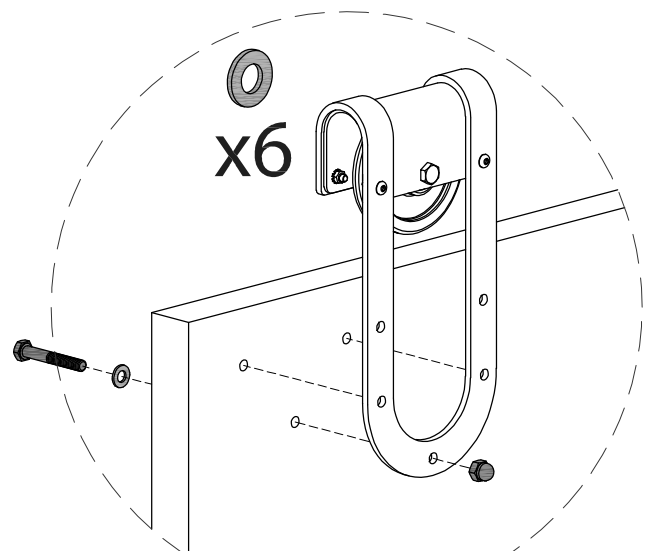
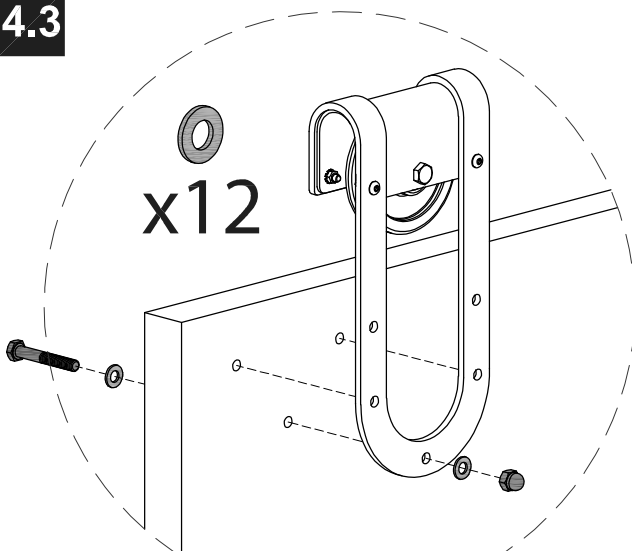



5

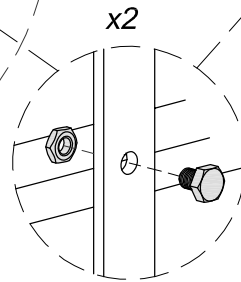
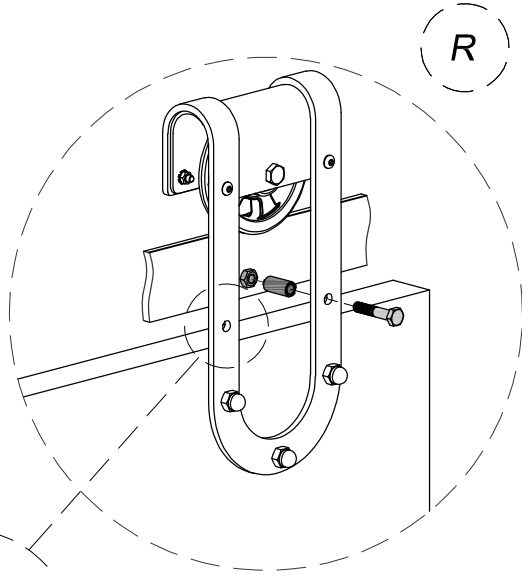
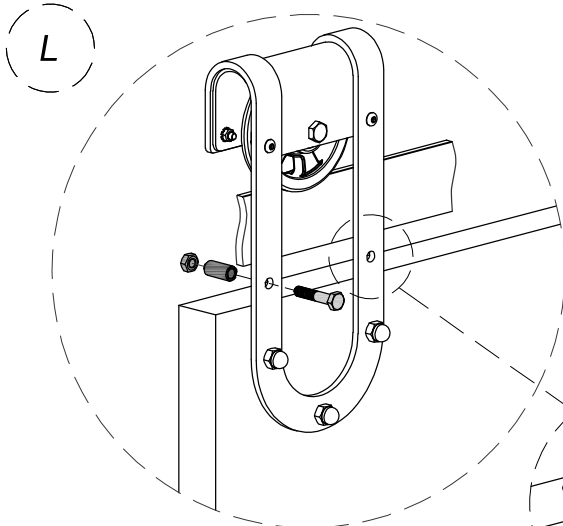
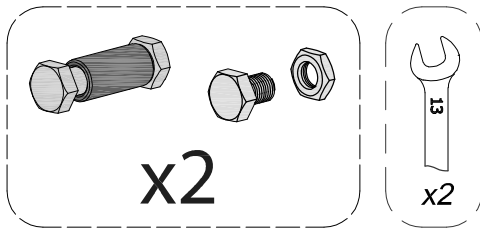

6

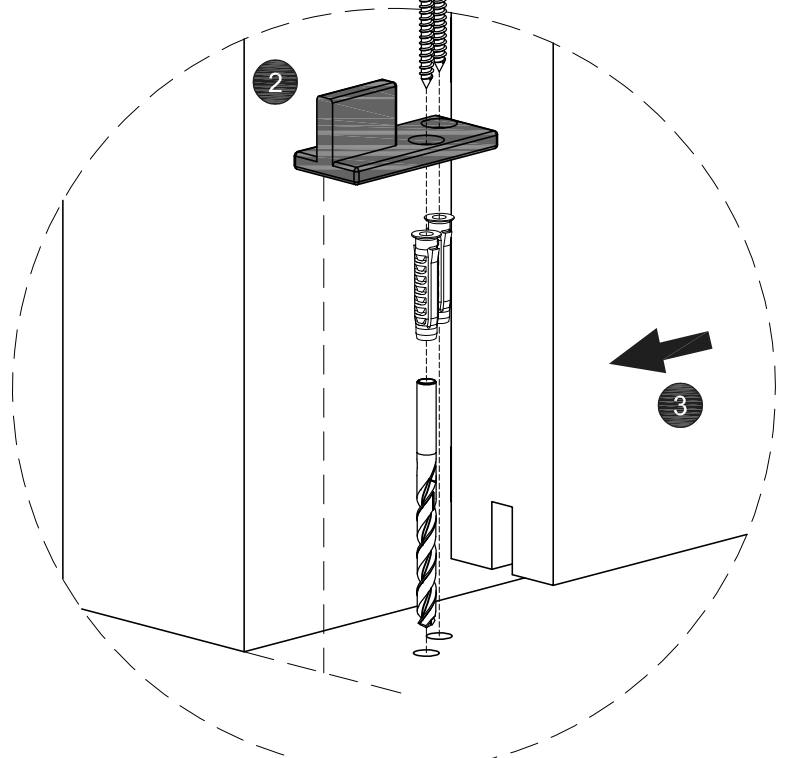
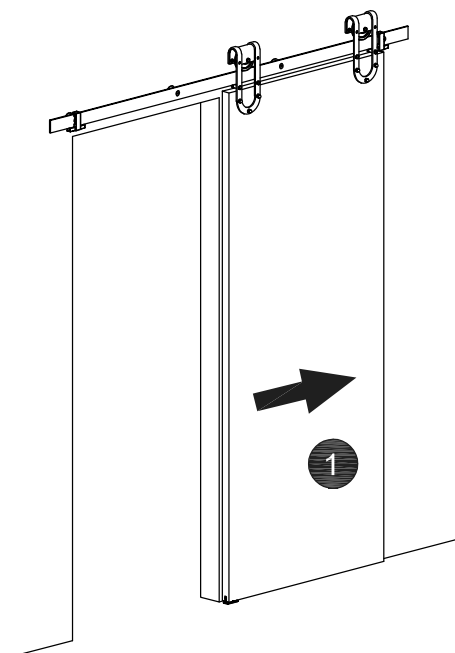
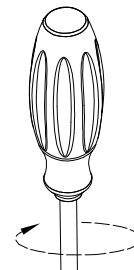
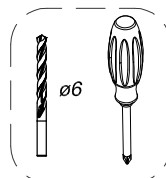
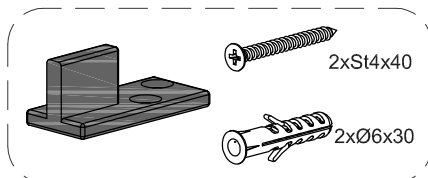



7

x2

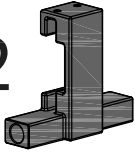

#2

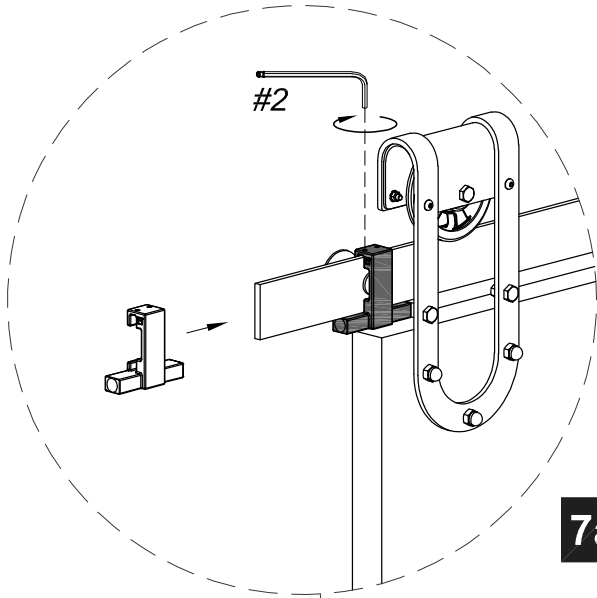
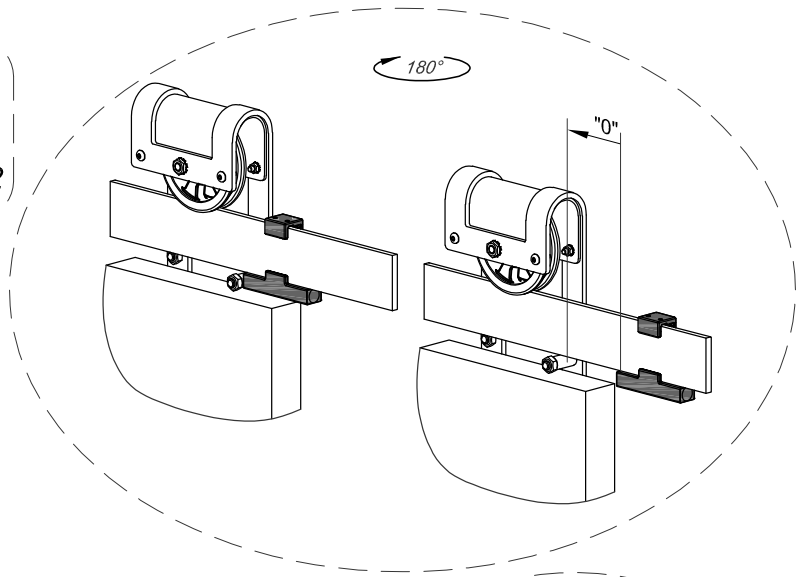

7a

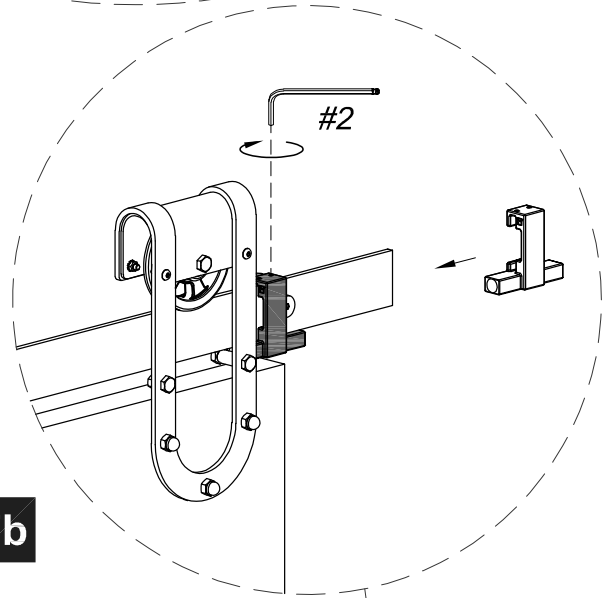

7b

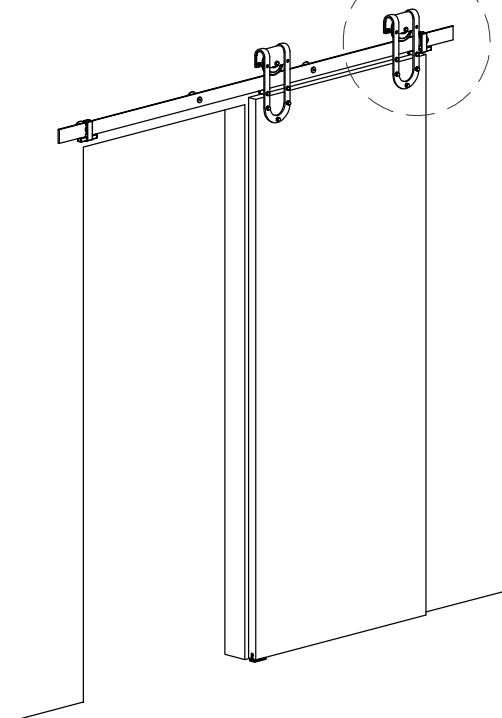
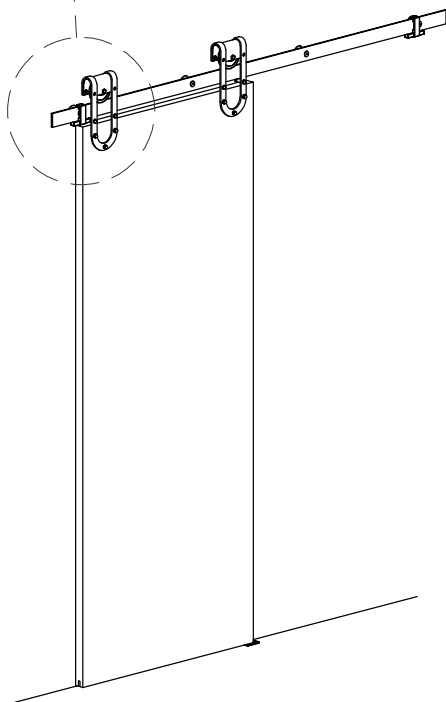

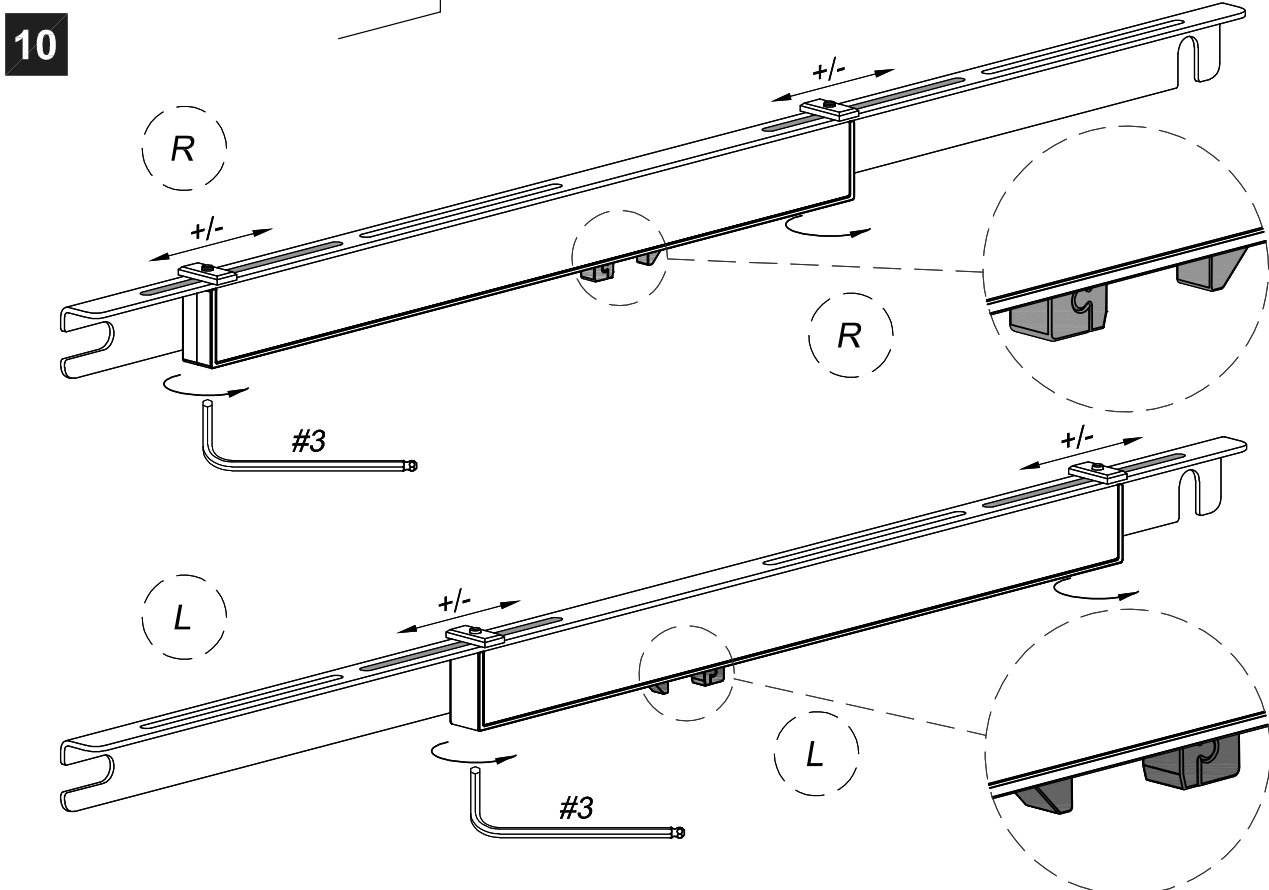
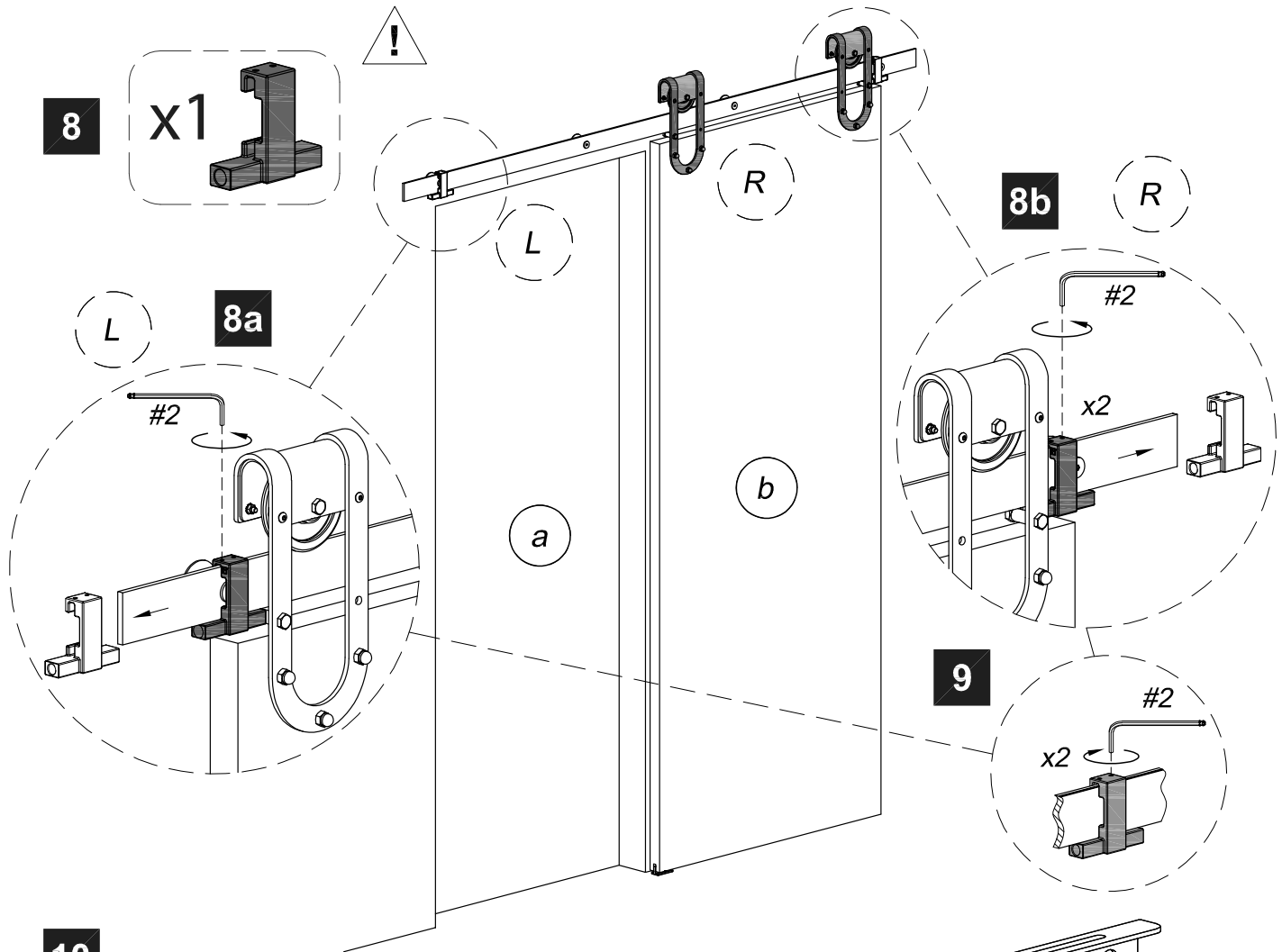



11

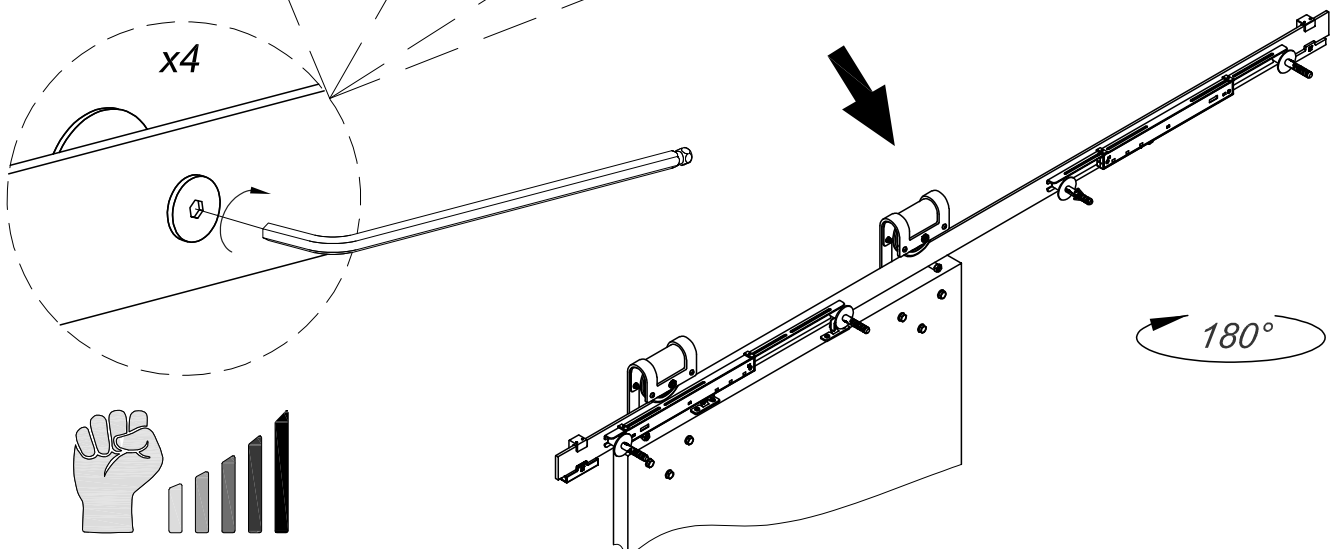
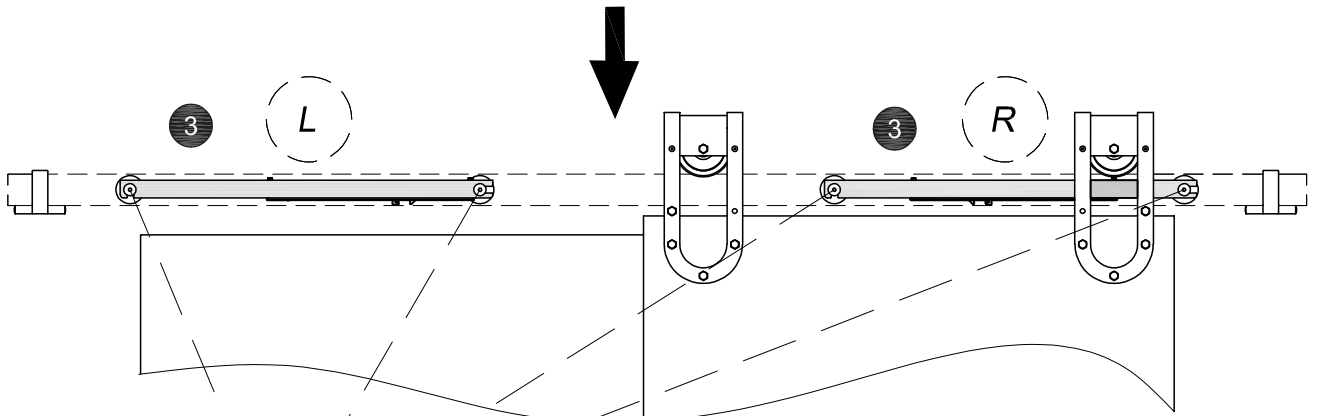
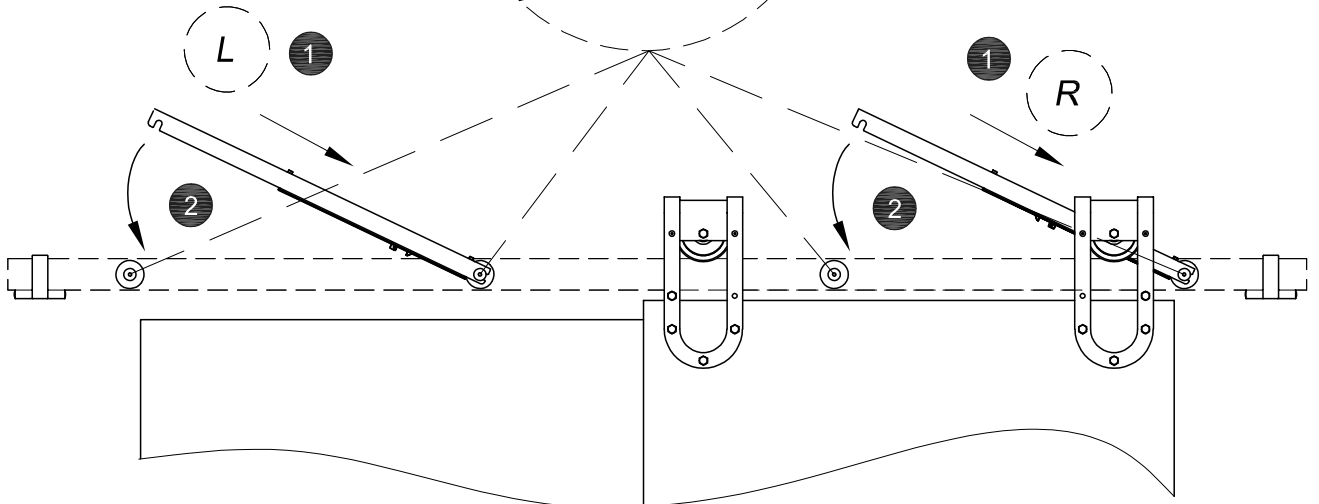
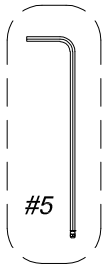
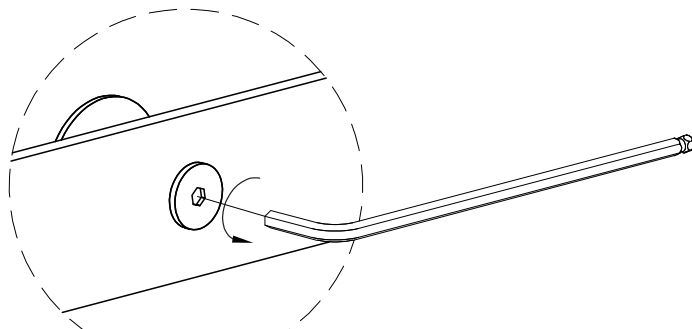
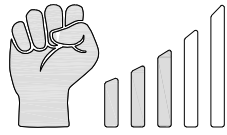



12

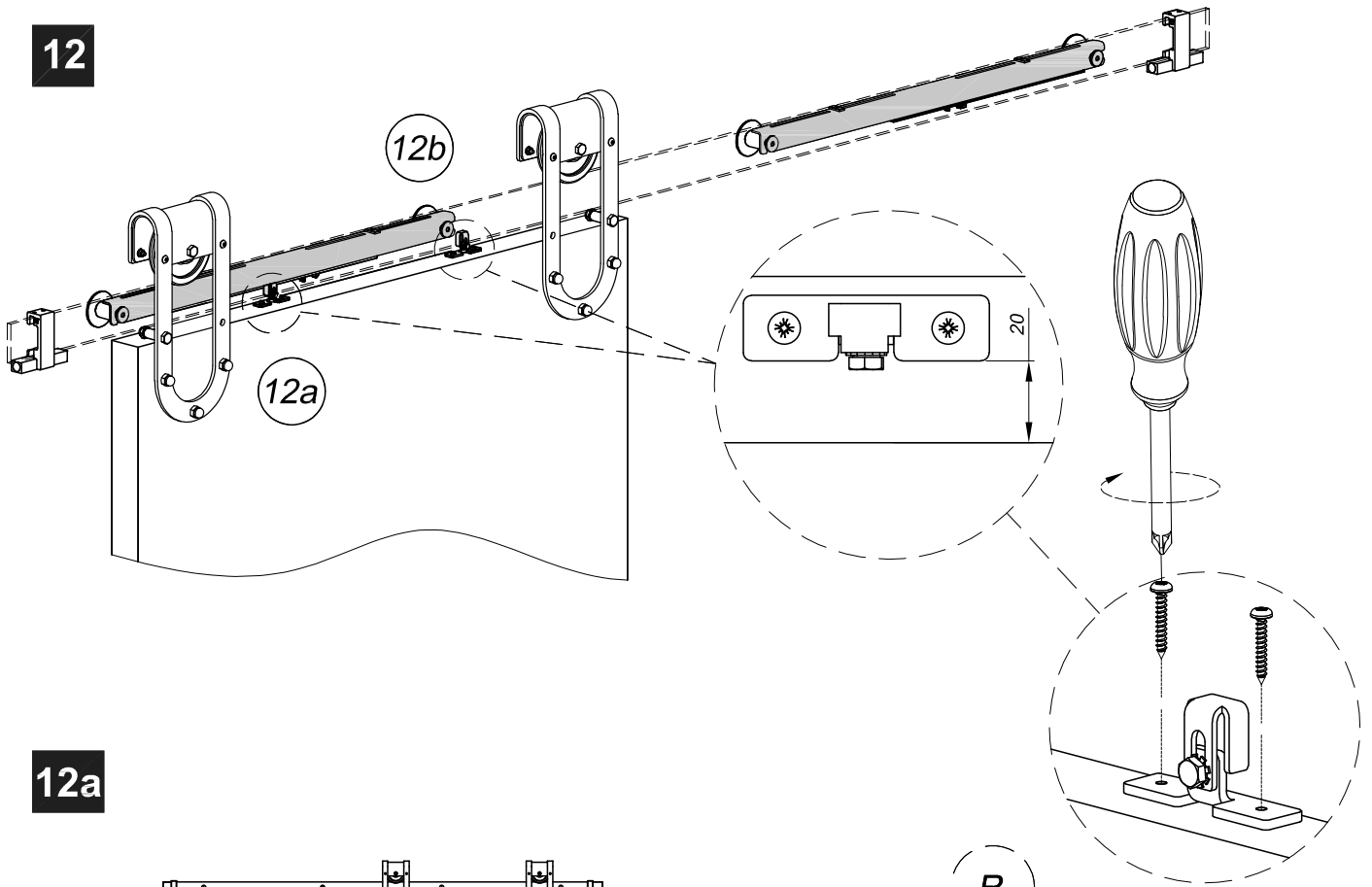

12a

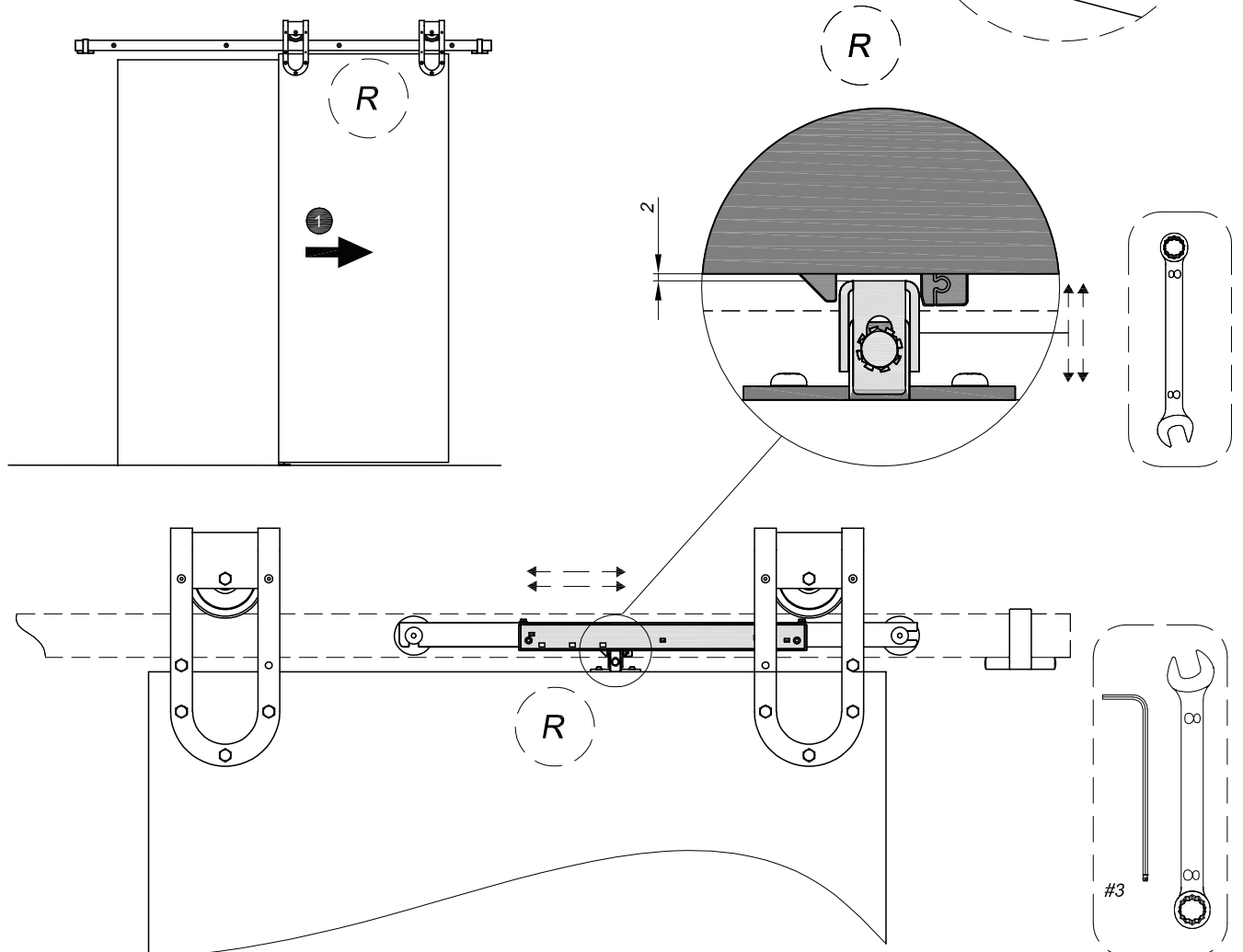



12b

