



INSTRUCTION DE MONTAGE
MONTAGEANLEITUNG
INSTRUCTIONS FOR ASSEMBLY
INSTRUCCIONES DE MONTAJE

SAFGLASS

NM_SAFGL_003

PORTE D'INTÉRIEUR / INNENTÜR / INTERIOR DOOR / PUERTA DE INTERIOR **80 KG**



COMPOSITION - ZUSAMMENSETZUNG - COMPOSICIÓN

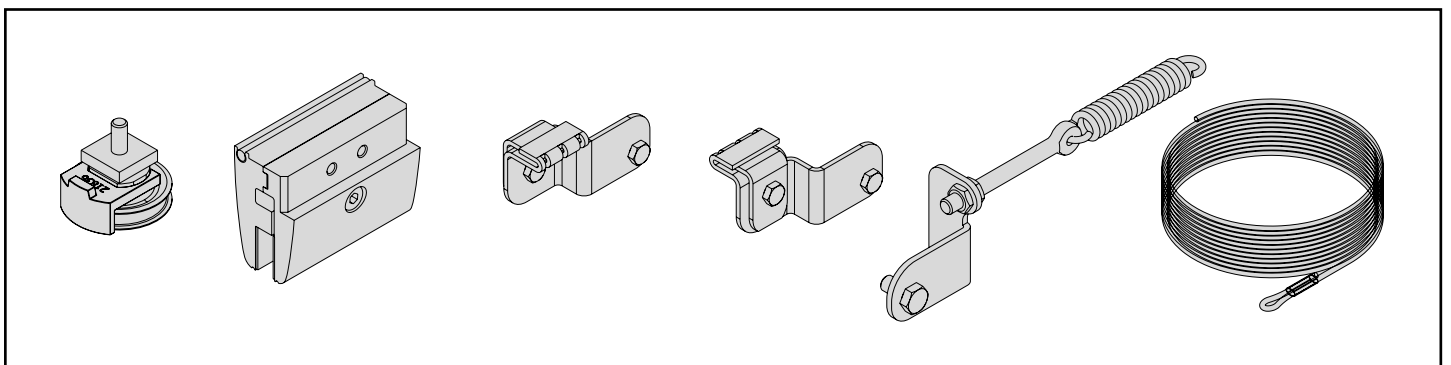
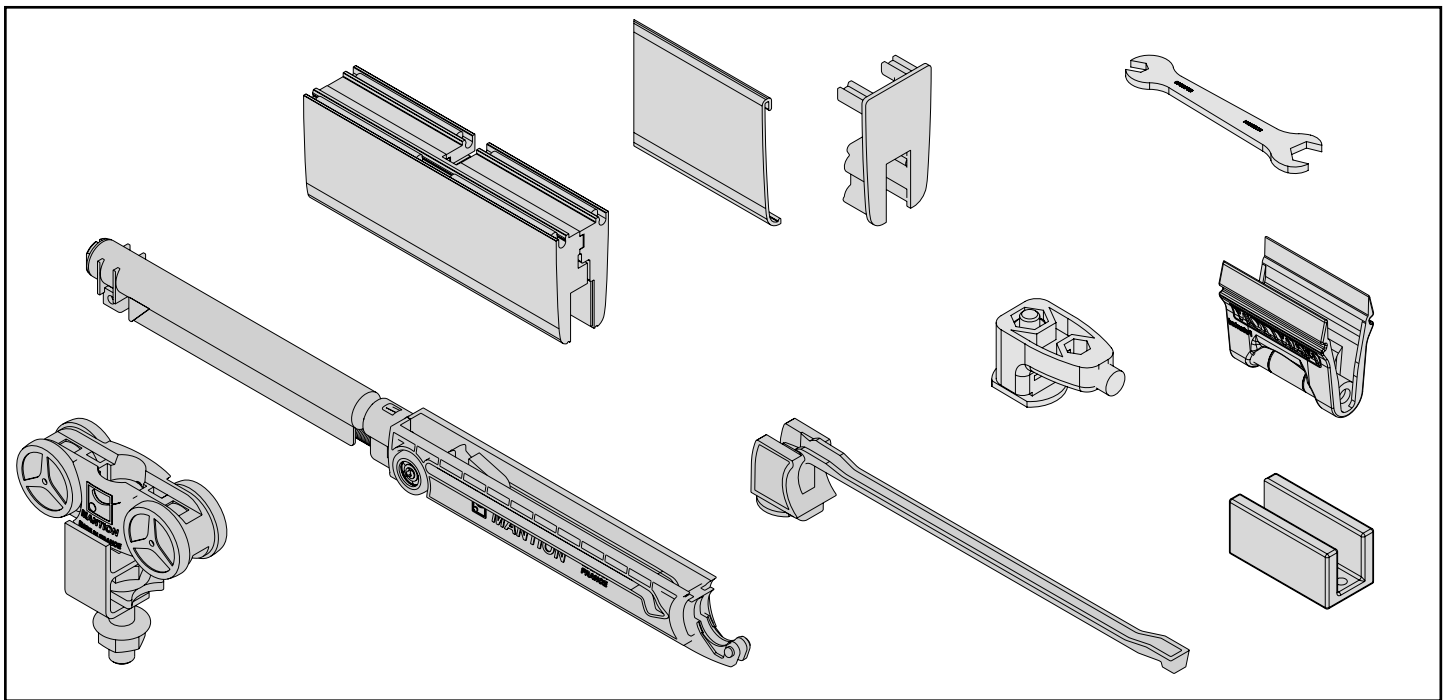
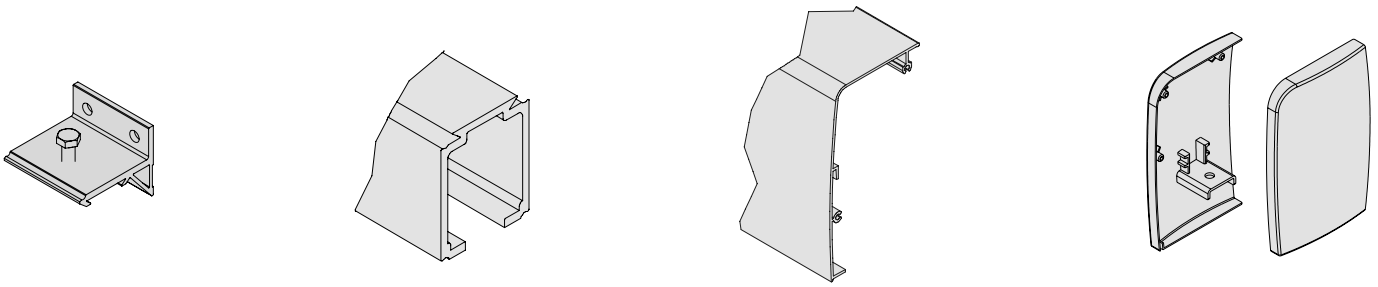

CONDITIONS DE POSE / MONTAGEBEDINGUNGEN / INSTALLATION REQUIREMENTS / CONDICIONES DE COLOCACION:

- Produit destiné à une utilisation en intérieur / Dieses Produkt ist nur für Innenanwendung geeignet / For indoor use only / Producto para utilización en interior
- Ne pas installer dans des endroits humides / Nicht in feuchten Atmosphären verwenden / Do not install in humid places / No instalar en lugares húmedos
- Le montage doit être effectué par des monteurs qualifiés / Die Montage muss von qualifizierten Handwerkern geführt werden / Installation must be performed by skilled personnel / el montaje tiene que hacerse por instaladores cualificados

OUTILLAGE NÉCESSAIRE A LA POSE / BENÖTIGTE WERKZEUGE / REQUIRED TOOLS FOR ASSEMBLY / HERRAMIENTA NECESARIA PARA LA COLOCACIÓN:

- Mètre / Metermass / Measuring tape / Flexometro
- Visseuse/perceuse à percussion (selon type de support) / Einschraubmaschine / Schlagbohrer (je nach dem Wandmaterial) / Percussion drill (if needed) / Atornillador / taladro de percusión (en función del soporte)
- Clé BTR de 4 / Schlüssel / Allen wrench (4 mm) / Llave Allen de 4
- Clé plates de 8 et 10 / Flachschlüssel / wrenche (8 & 10) / Llave llana de (8 & 10)

DIMENSIONS / MASSE / SIZING / DIMENSIONES (mm):

Baie min. / Min. Öffnung / Min. opening / Apertura min. : **1200 mm**

Ecoinçon min. / Min. Eckenmasse / Min. nook / Rincón min. : **O/2 + 150 mm**

Linteau min. / Min. Türsturz / Min. lintel / Dintel min: **A = 110 mm ; B = 150 mm**

Hauteur du panneau / Paneelhöhe / Panel height / Altura del panel: **A W = H - 35 mm**

B W = H

Largeur panneau / Paneelbreite / Panel width / Anchura del panel: **L = O/2 + 35 mm**

Epaisseur panneau / Paneelstärke / Panel thickness / Grueso del panel: **12 mm**

Poids panneau / Paneelgewicht / Panel weight / Peso panel: **80 Kg MAX**

ENCOMBREMENT - ABMESSUNGEN - DIMENSIONS - VOLUMEN

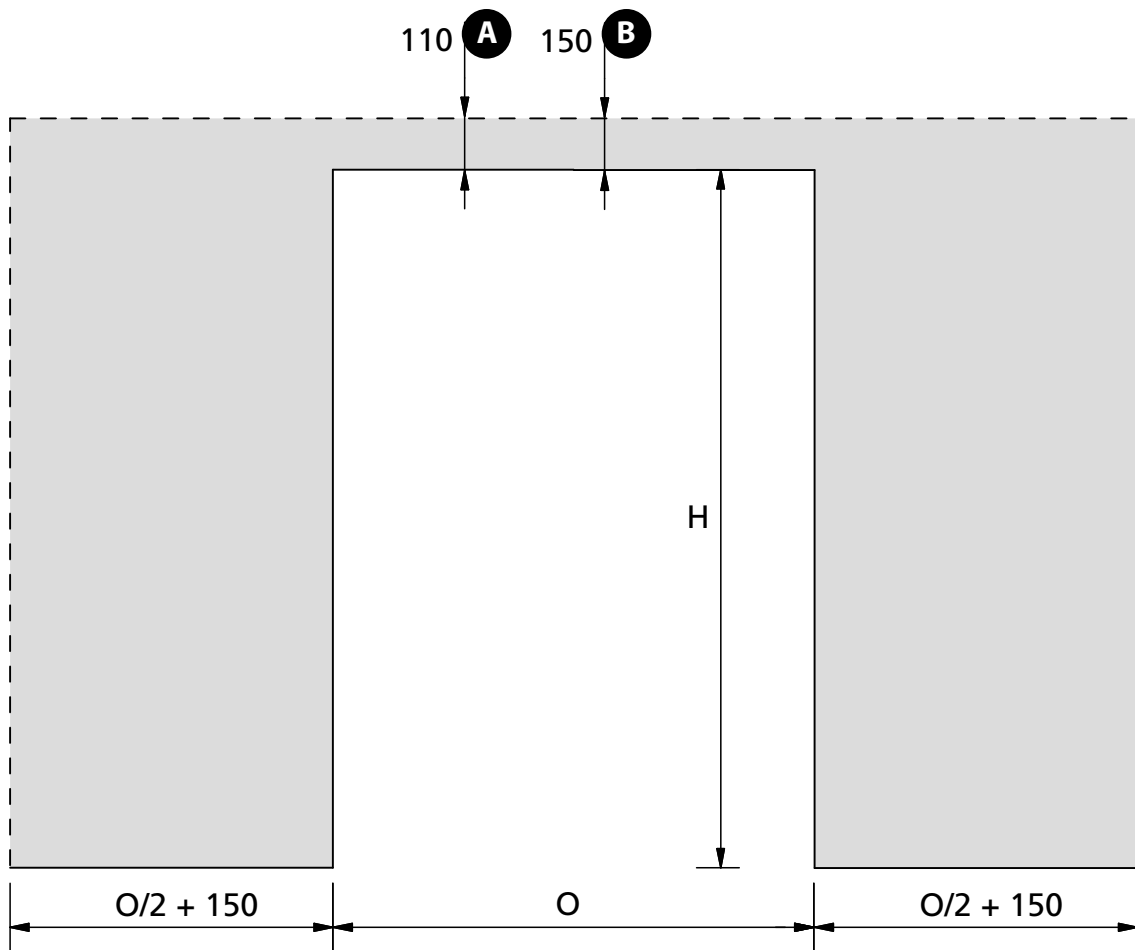

Dimensions de la porte - Abmessungen von Türen - Dimensions of doors - Dimensiones de las puertas

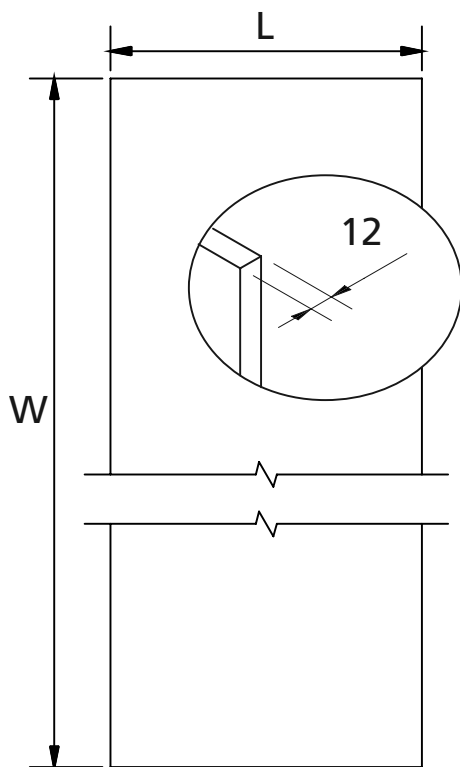

Avec bandeaux de pinces
mit Klemmenblenden
with clamps pelmets

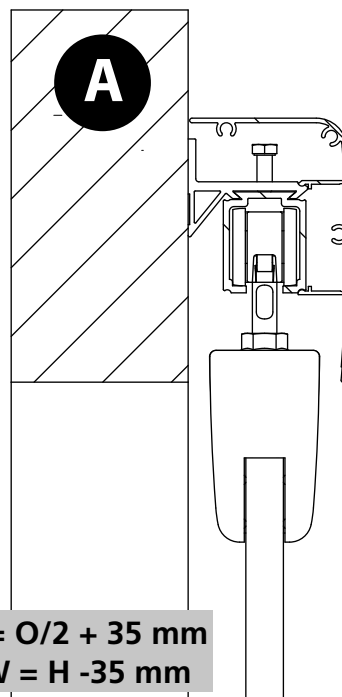

Sans bandeaux de pinces
ohne Klemmenblenden
without clamps pelmet

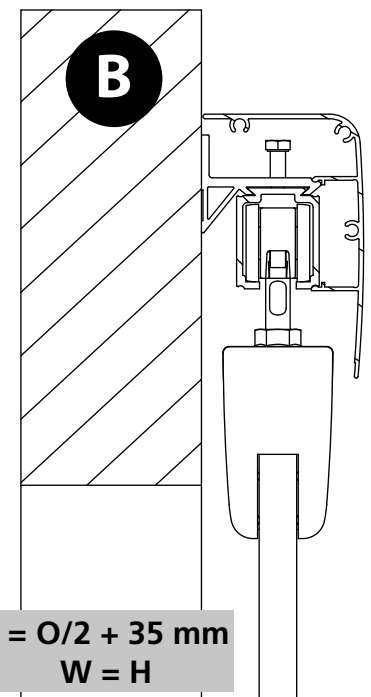

1.

a

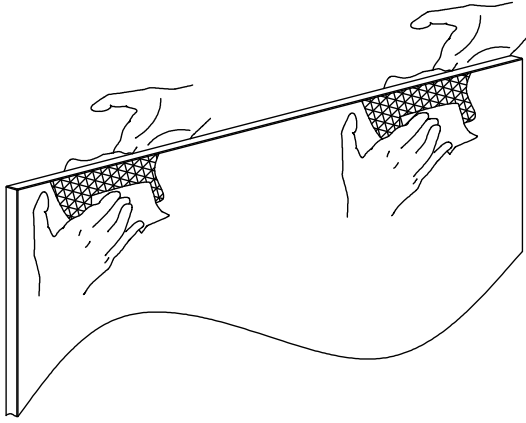

Face 1

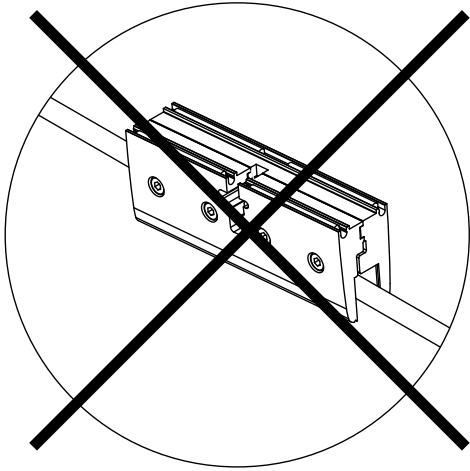

b

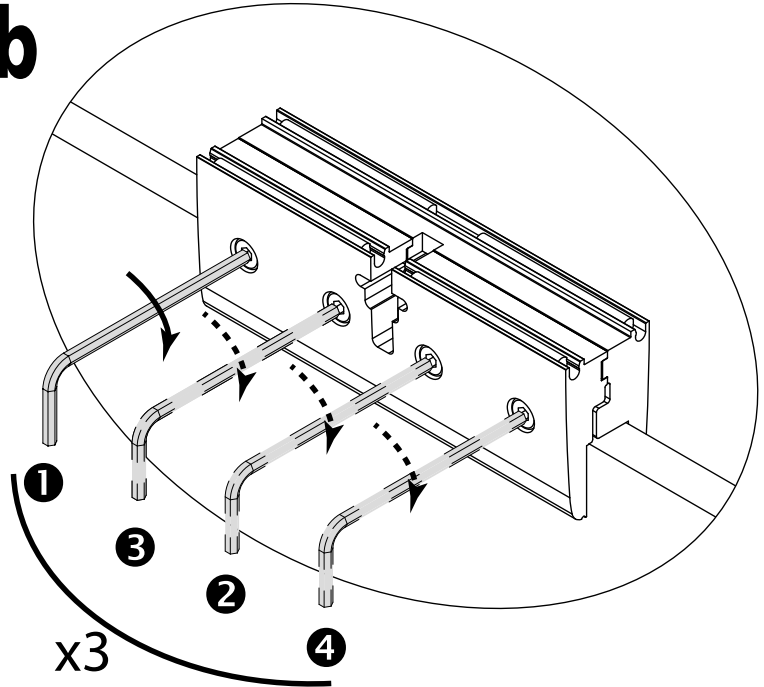

x3

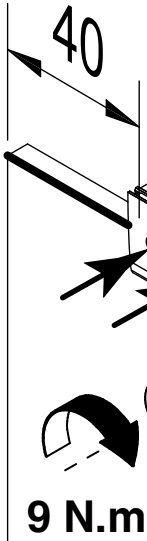

9 N.m

Face 1

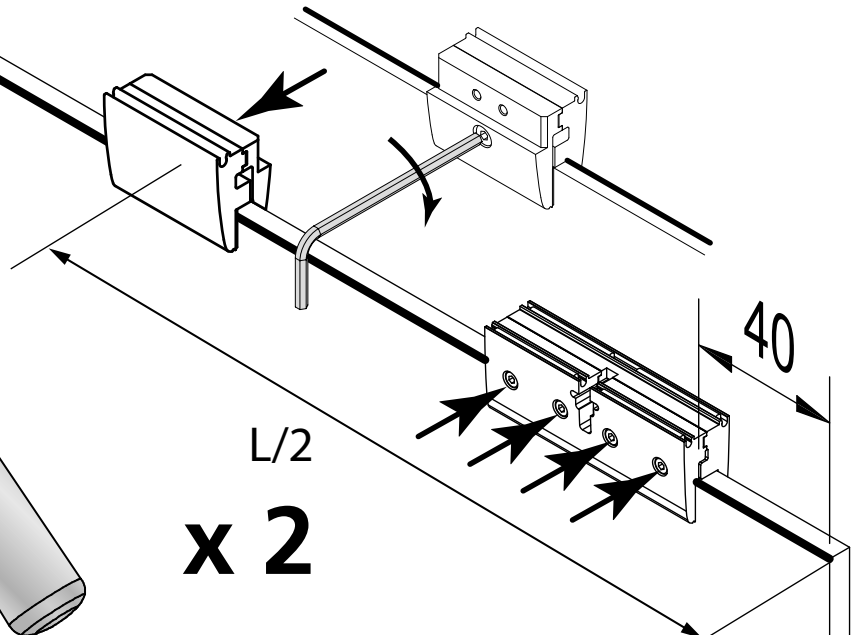

L/2

x2

2.

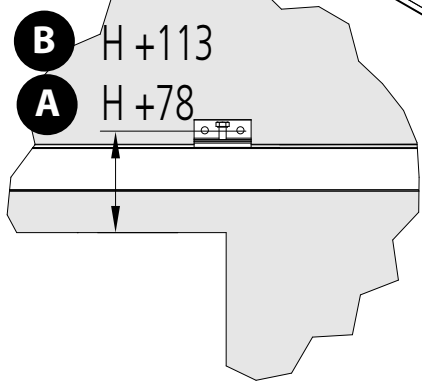
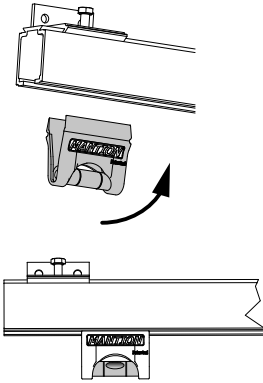

d = 400 mm Max.

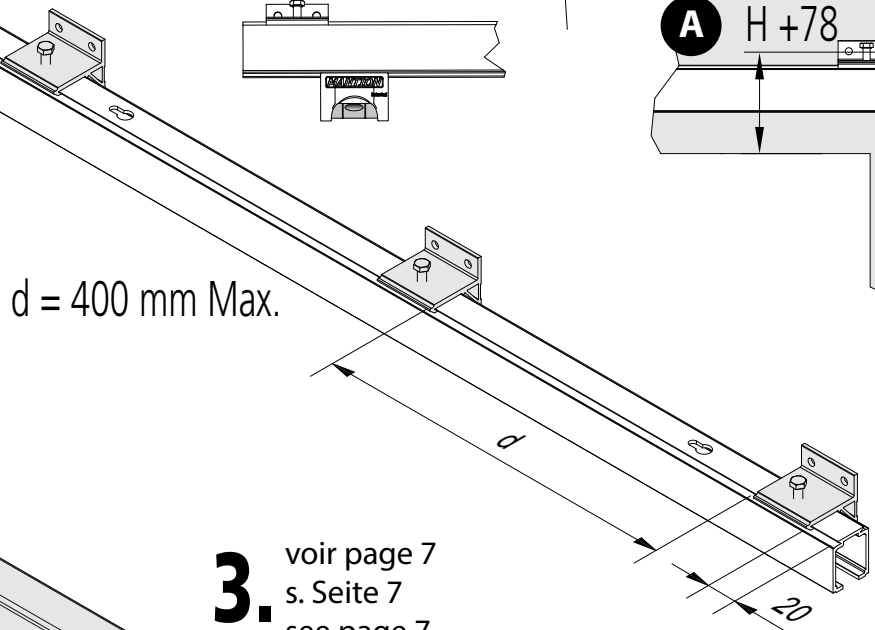

H

L + 80mm

3. voir page 7
s. Seite 7
see page 7
ver p. 7

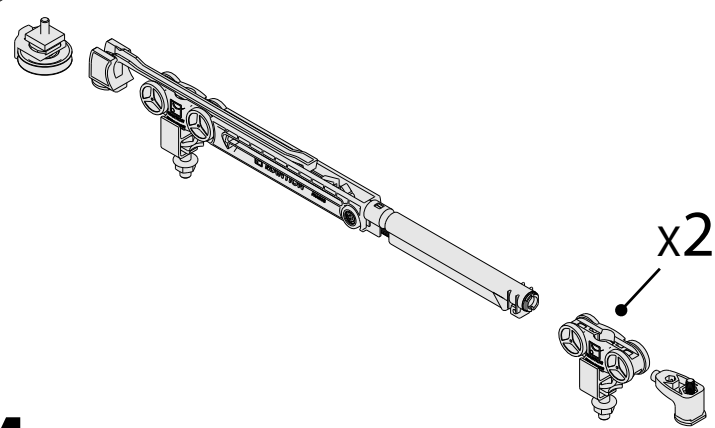

4.

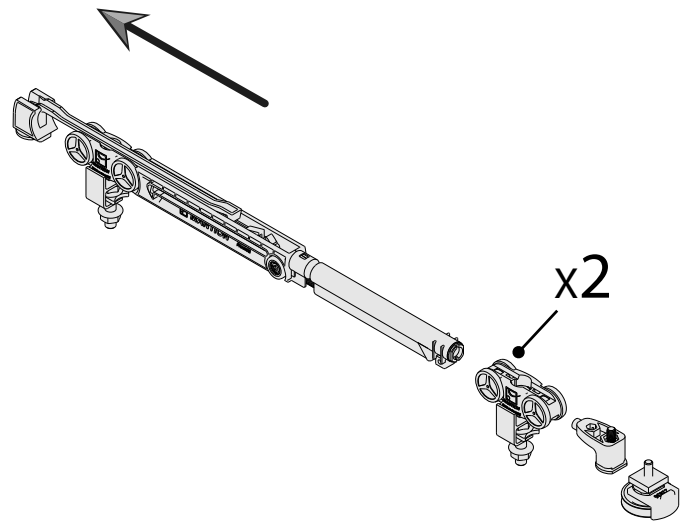
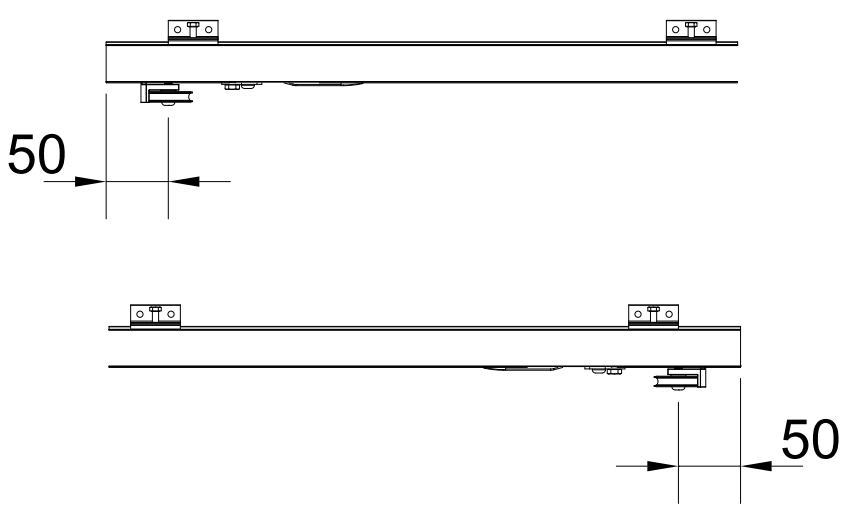

5.

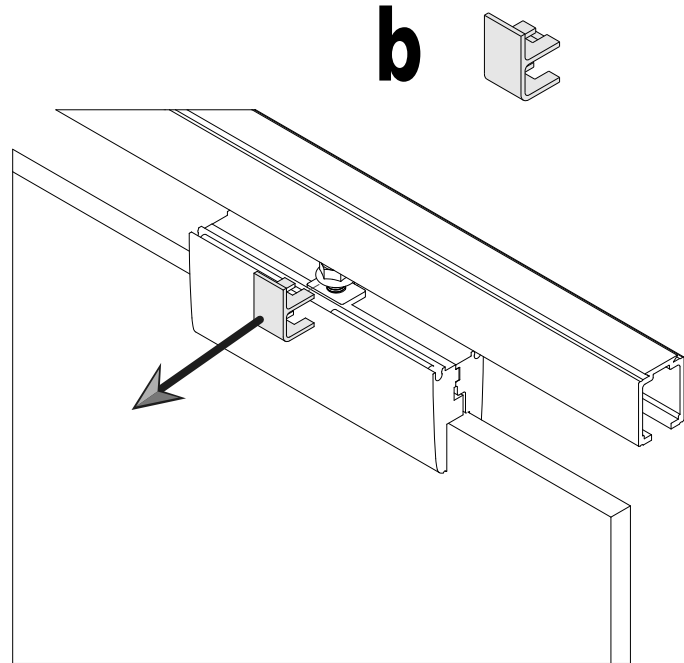
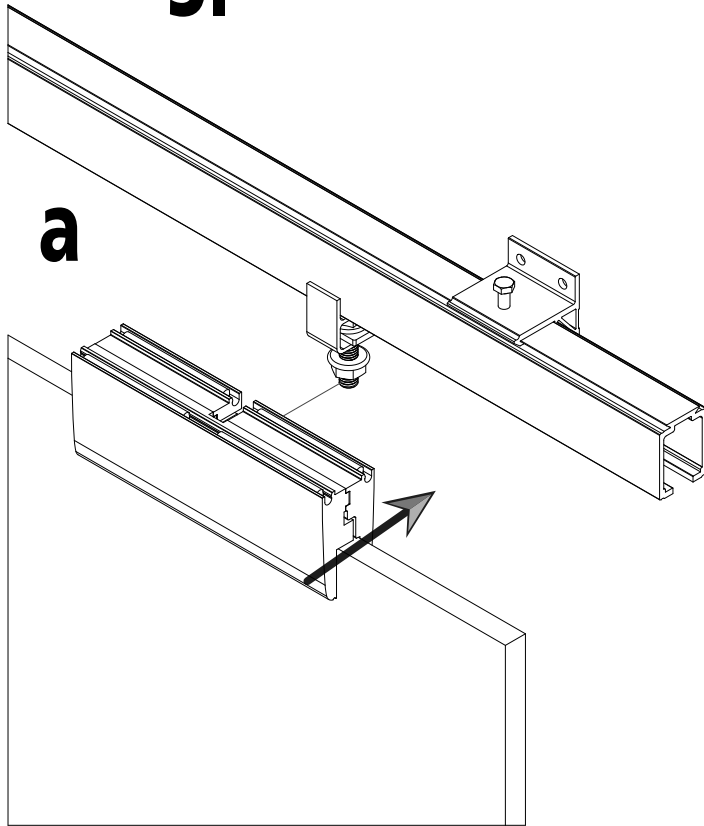

6

a Réglage
Einstellung
Adjustment
Ajuste

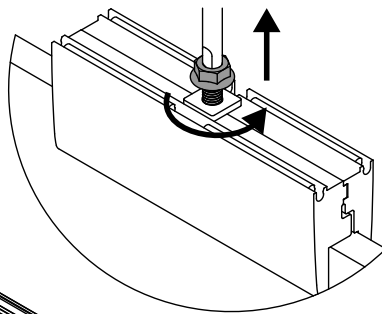

b Serrage
Klemmen
Fitting
Apriete

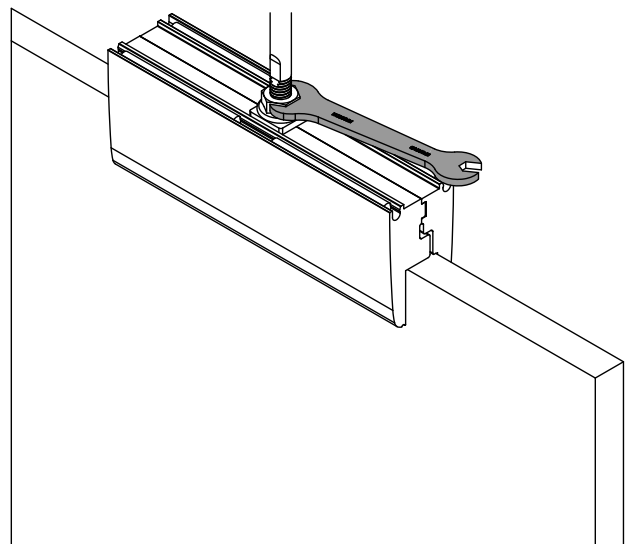

7.

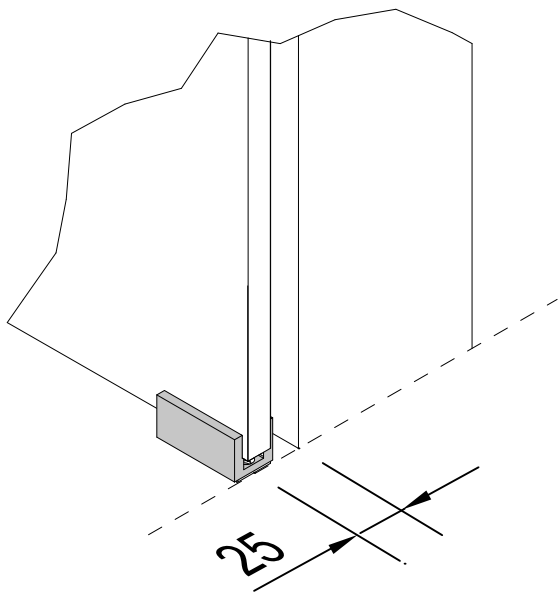

8.

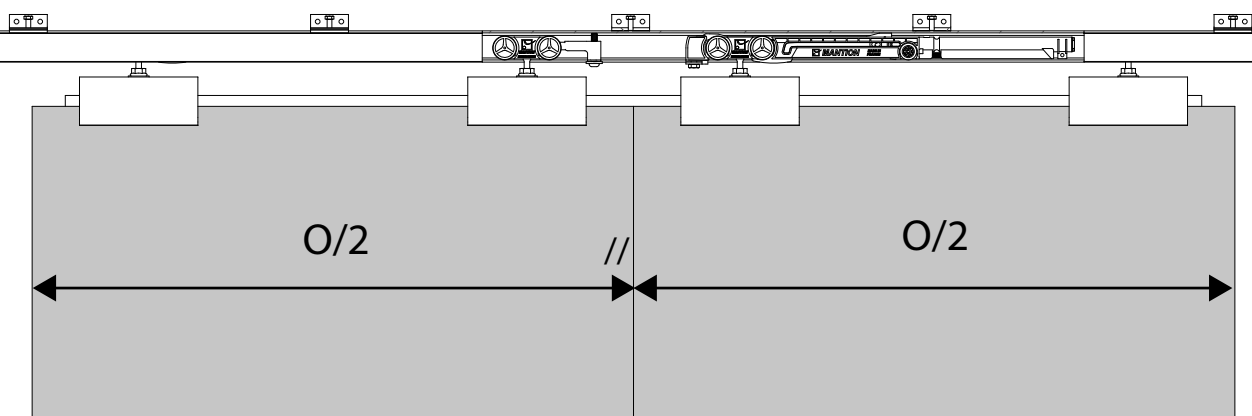
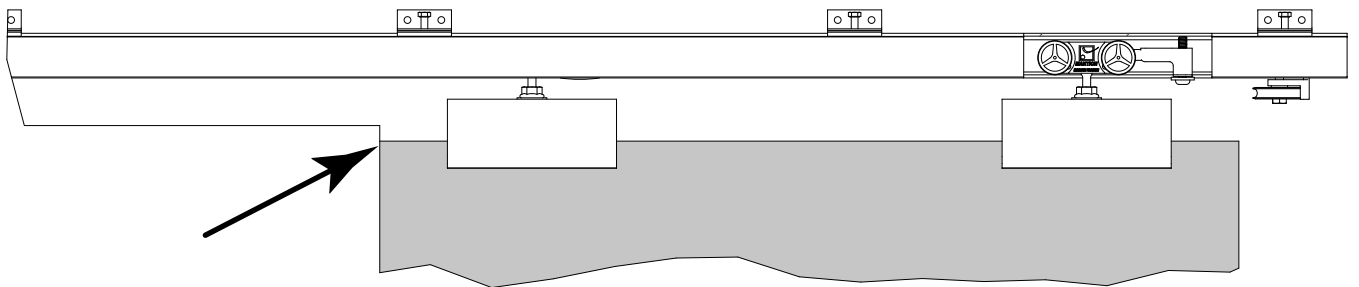
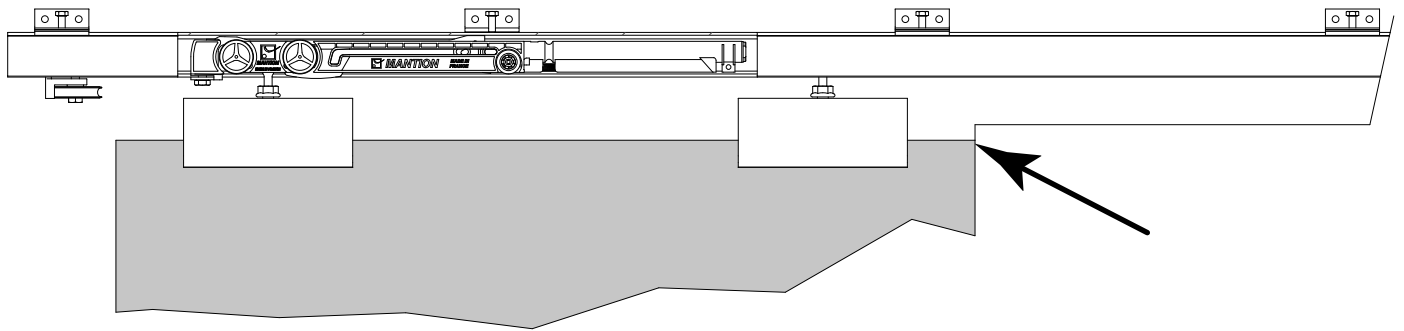
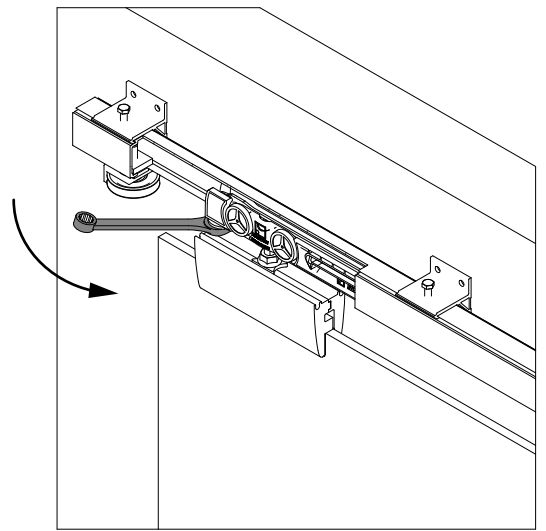

9.

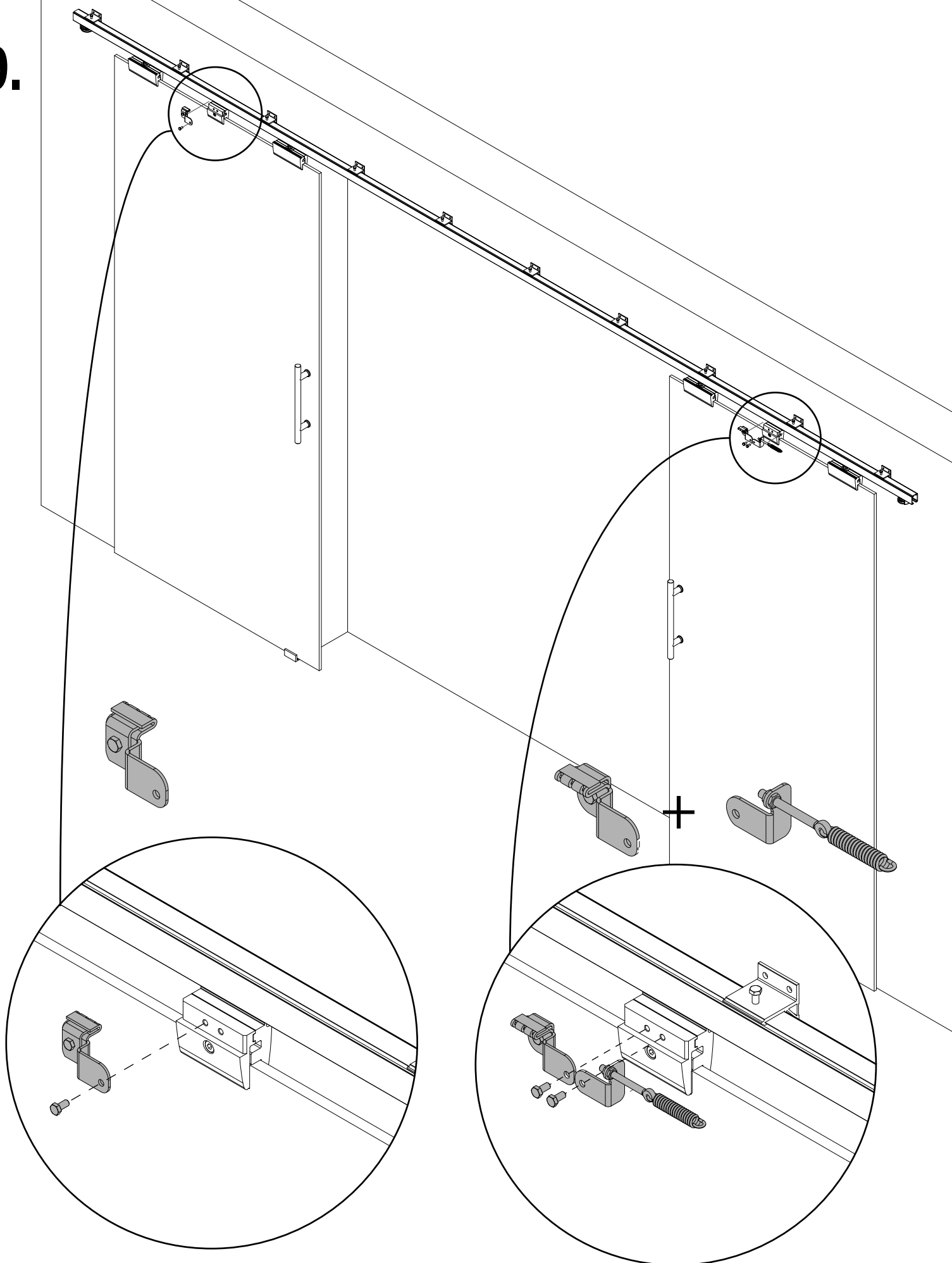

10.

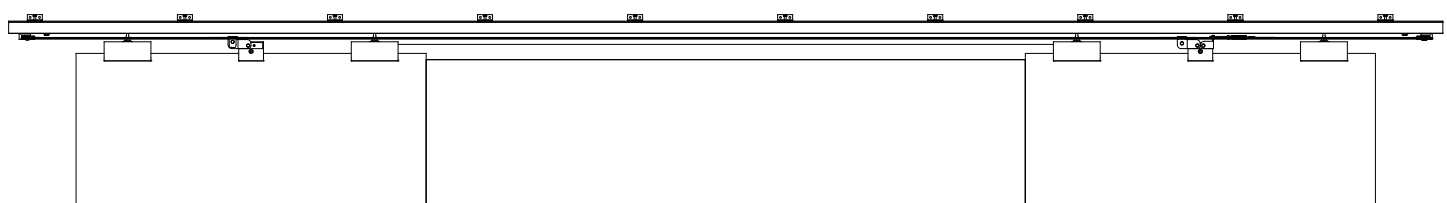
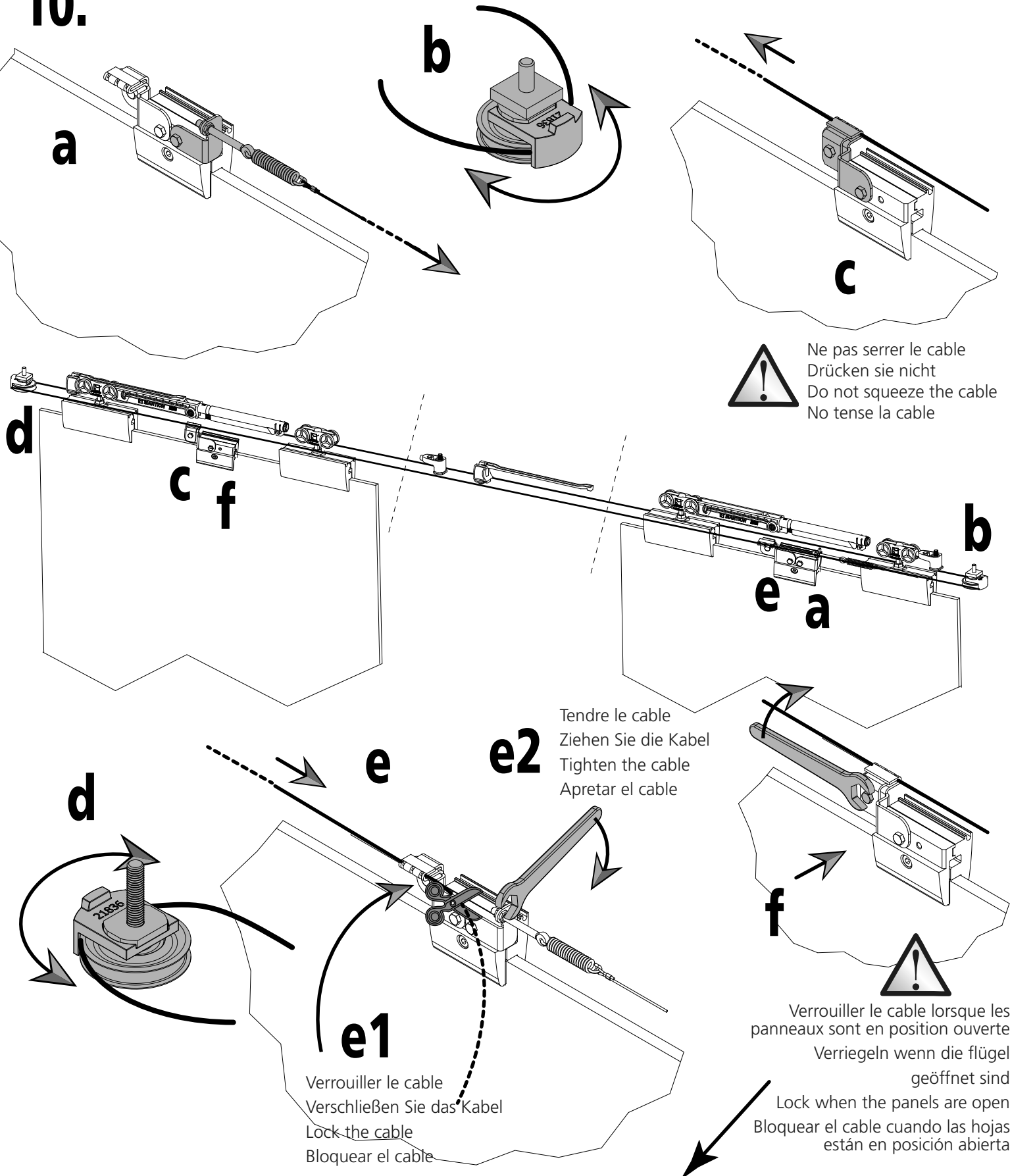

11.

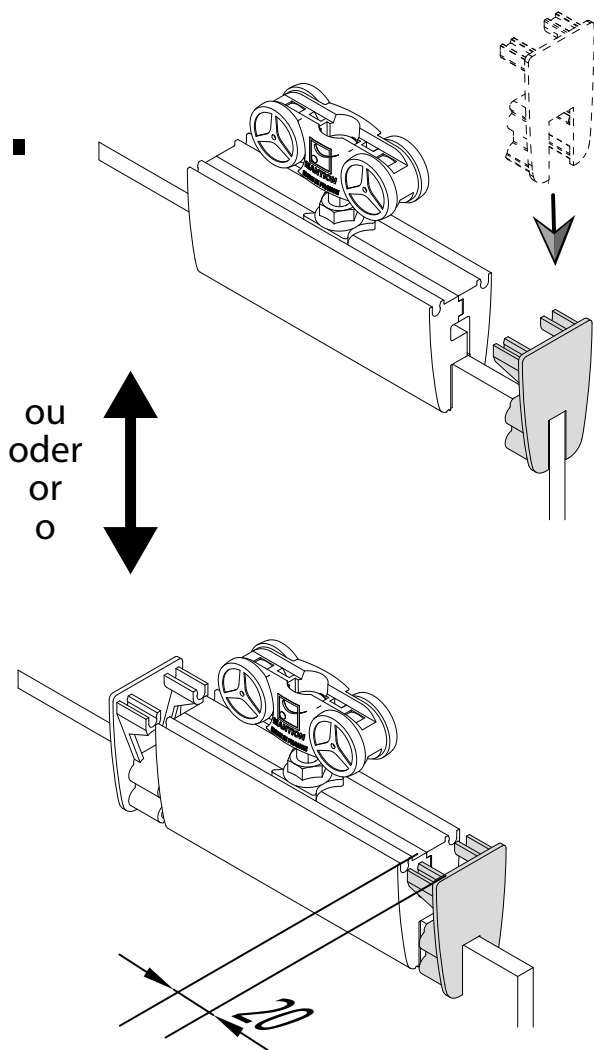

12.

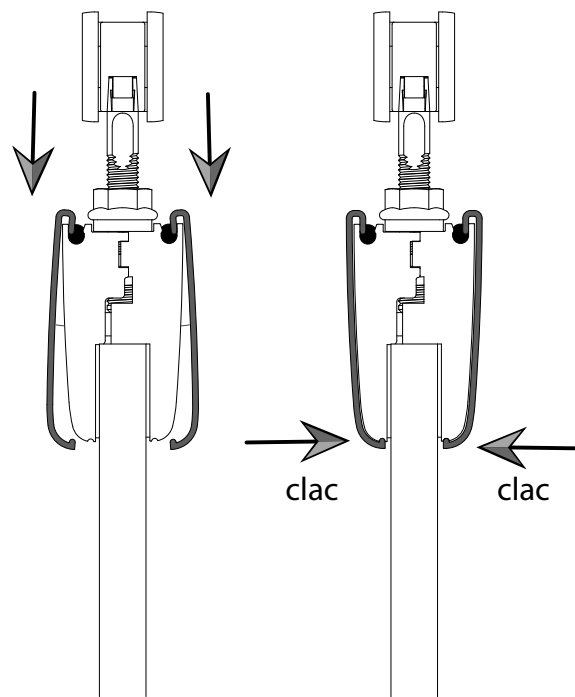

13.

