



INSTRUCTION DE MONTAGE  
MONTAGEANLEITUNG  
INSTRUCTIONS FOR ASSEMBLY  
INSTRUCCIONES DE MONTAJE

# SAFGLASS

## NM\_SAFGL\_001

PORTE D'INTÉRIEUR / INNENTÜR / INTERIOR DOOR / PUERTA DE INTERIOR **80 KG**

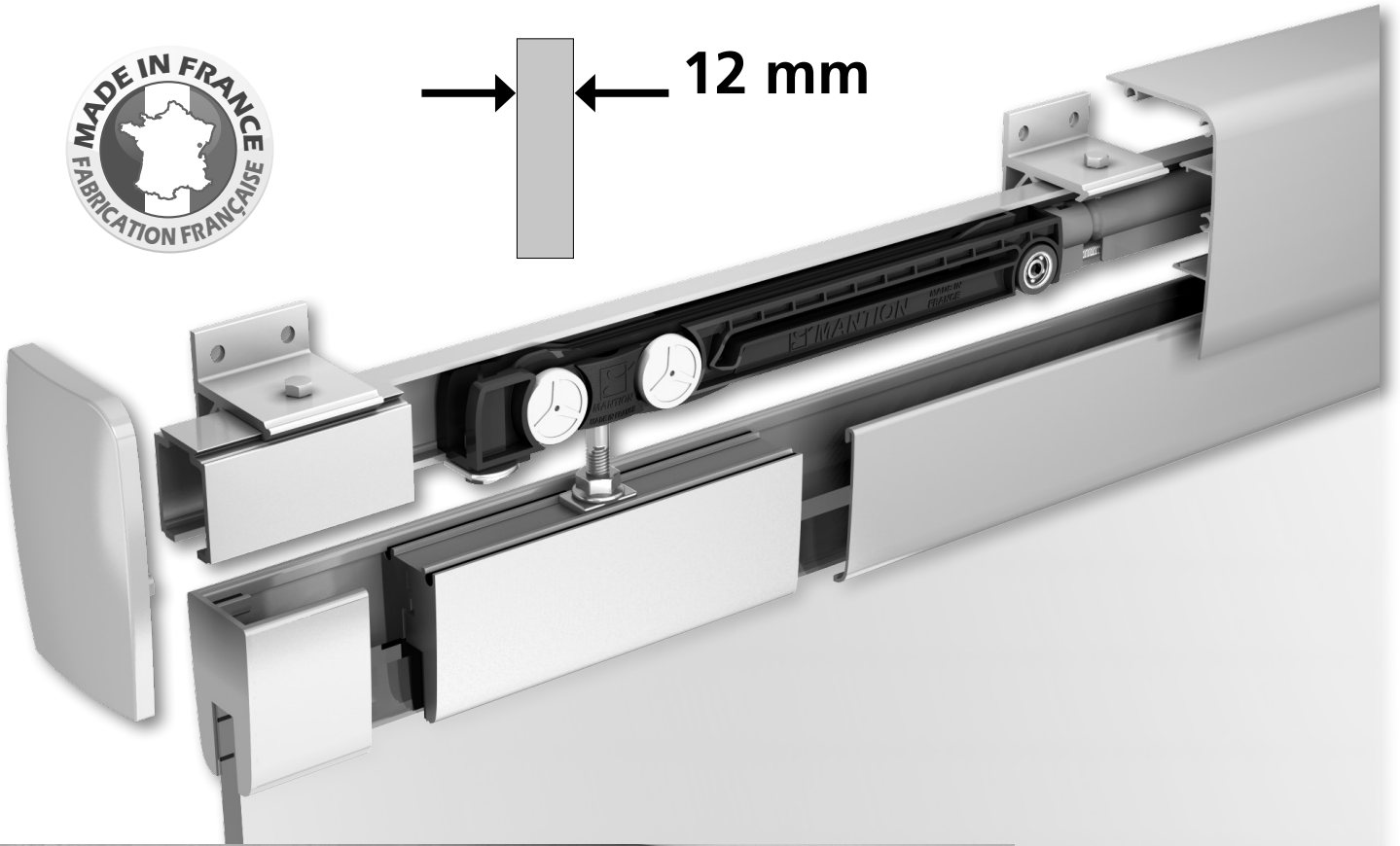
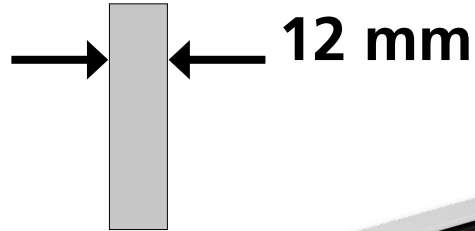

# COMPOSITION - ZUSAMMENSETZUNG - COMPOSICIÓN

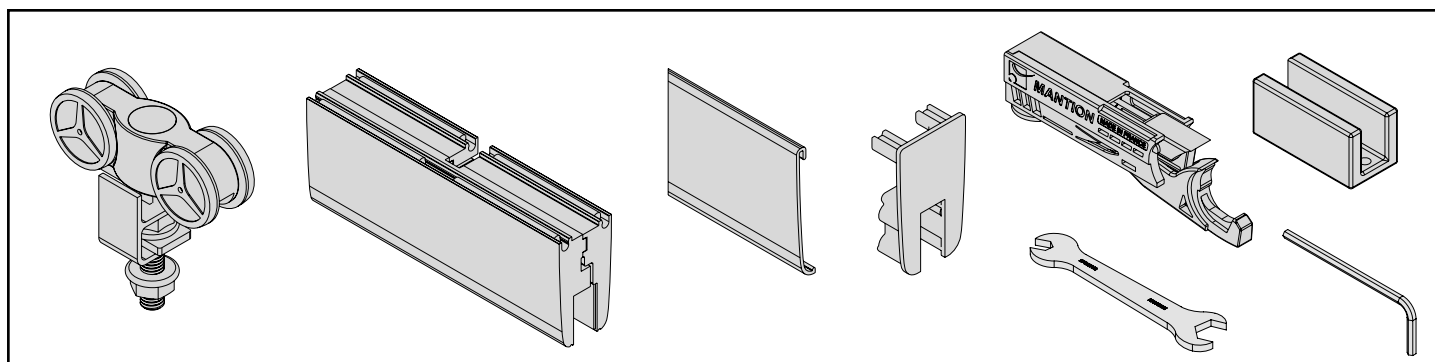
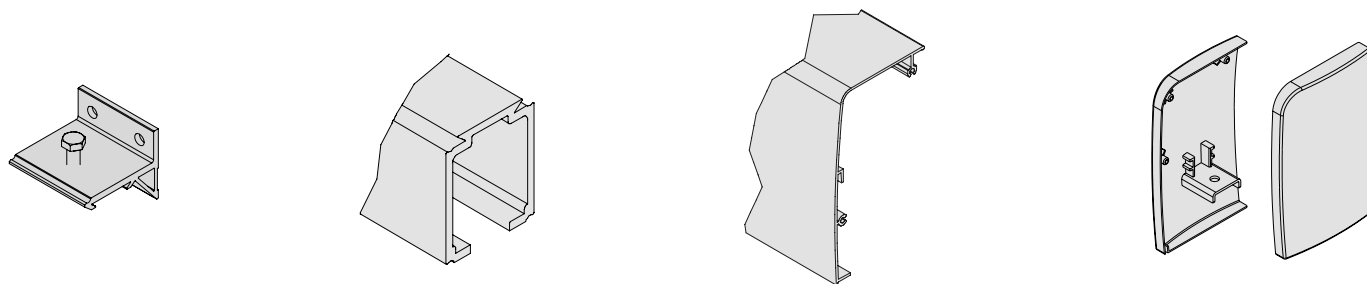

## CONDITIONS DE POSE / MONTAGEBEDINGUNGEN / INSTALLATION REQUIREMENTS / CONDICIONES DE COLOCACION:

- Produit destiné à une utilisation en intérieur / Dieses Produkt ist nur für Innenanwendung geeignet / For indoor use only / Producto para utilización en interior
- Ne pas installer dans des endroits humides / Nicht in feuchten Atmosphären verwenden / Do not install in humid places / No instalar en lugares húmedos
- Le montage doit être effectué par des monteurs qualifiés / Die Montage muss von qualifizierten Handwerkern geführt werden / Instalation must be performed by skilled personnel / el montaje tiene que hacerse por instaladores cualificados

## DIMENSIONS / MASSE / SIZING / DIMENSIONES (mm):

Ecoinçon min. côté refoulement / Min. Eckenmasse auf Stauplatzseiten / Min. nook for pushback side / Rincón min. Lado retroceso : **O + 110 mm**

Ecoinçon min. côté fermeture / Min. Eckenmasse auf Schliess-Seiten / Min. nook for closing side / Rincón min. Lado cierre: **L + 75 mm**

Linteau min. / Min. Türsturtz / Min. lintel / Dintel min: **A = 110 mm** **B = 150 mm**

Epaisseur panneau / Paneelstärke / Panel thickness / Grueso del panel: **12 mm**

Poids panneau / Paneelgewicht / Panel weight / Peso panel: **80 Kg MAX**

# ENCOMBREMENT - ABMESSUNGEN - DIMENSIONS - VOLUMEN

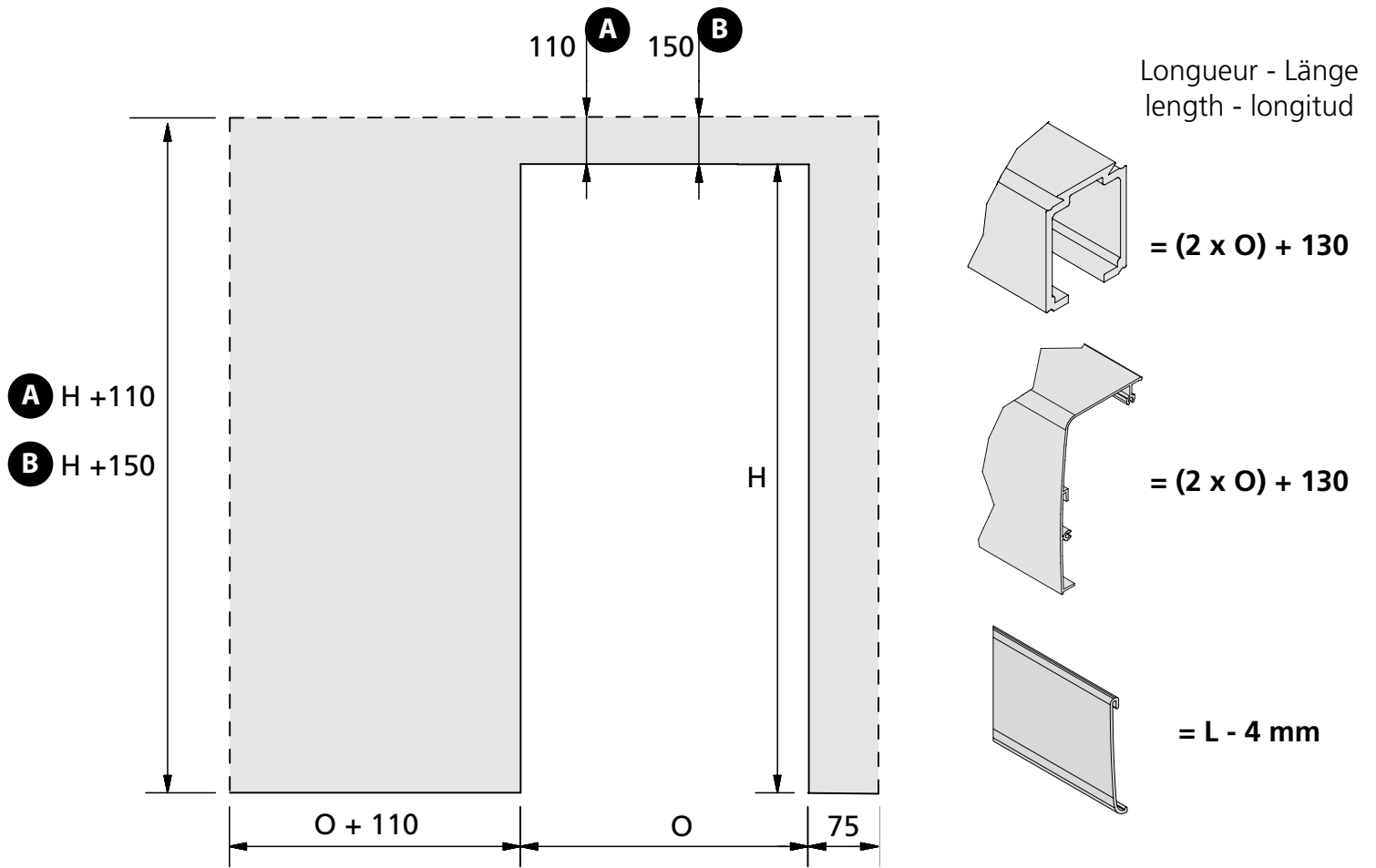

Dimensions de la porte - Abmessungen von Türen - Dimensions of doors - Dimensiones de las puertas

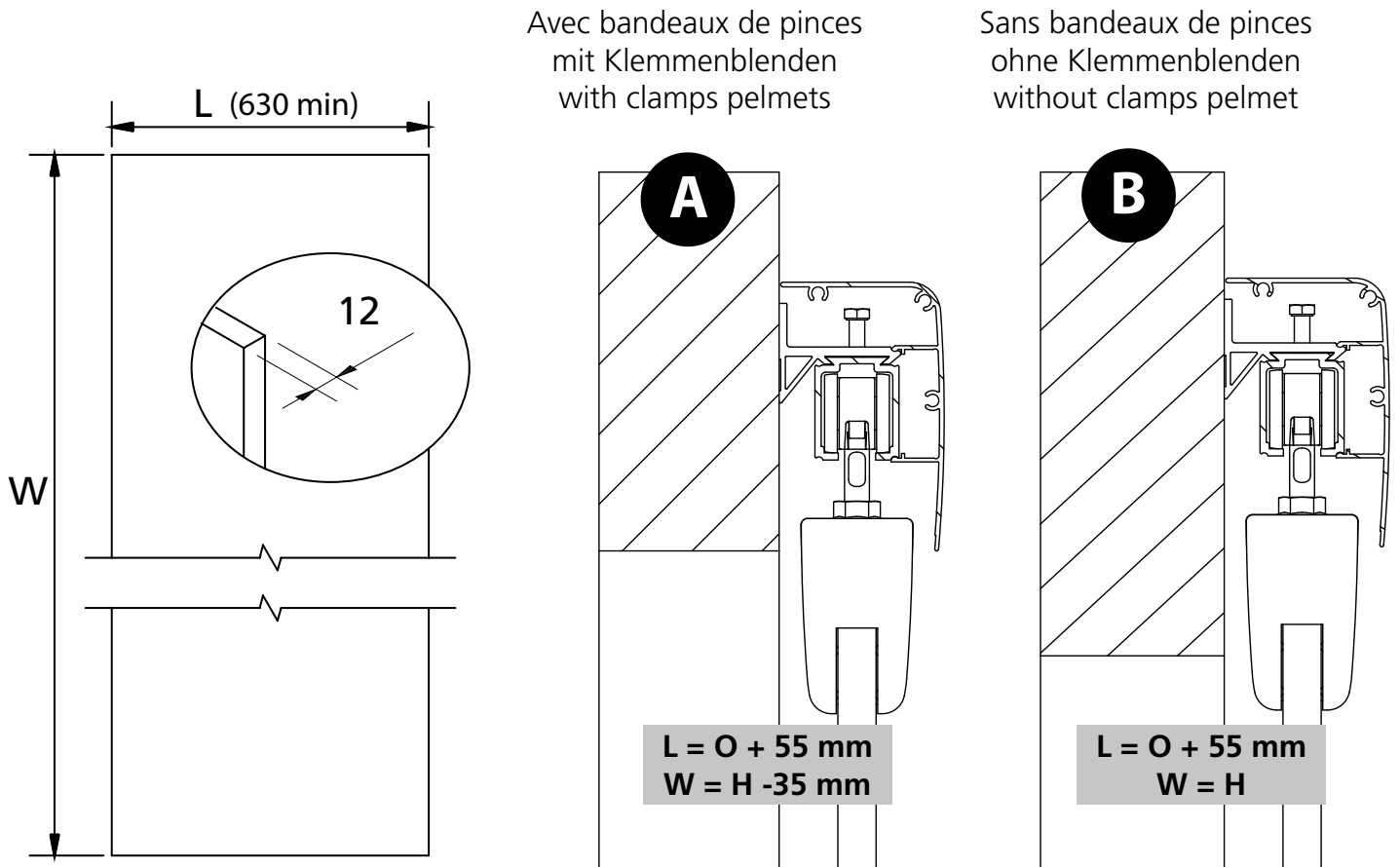

1.

a

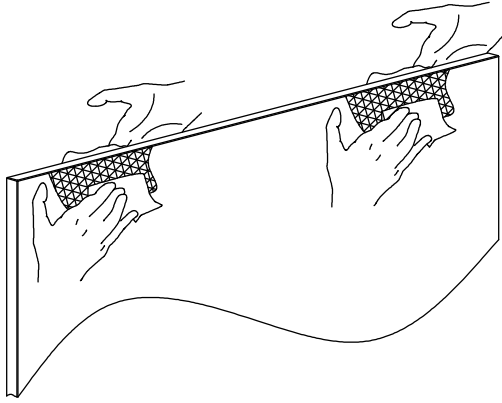

Face 1

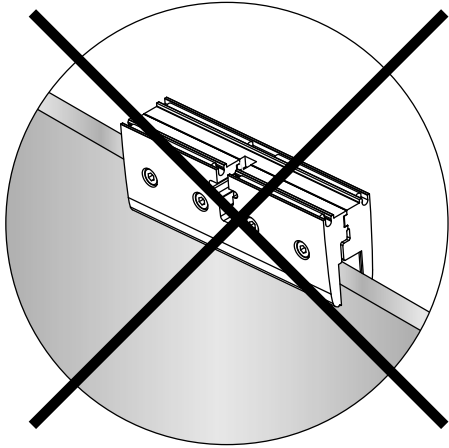

b

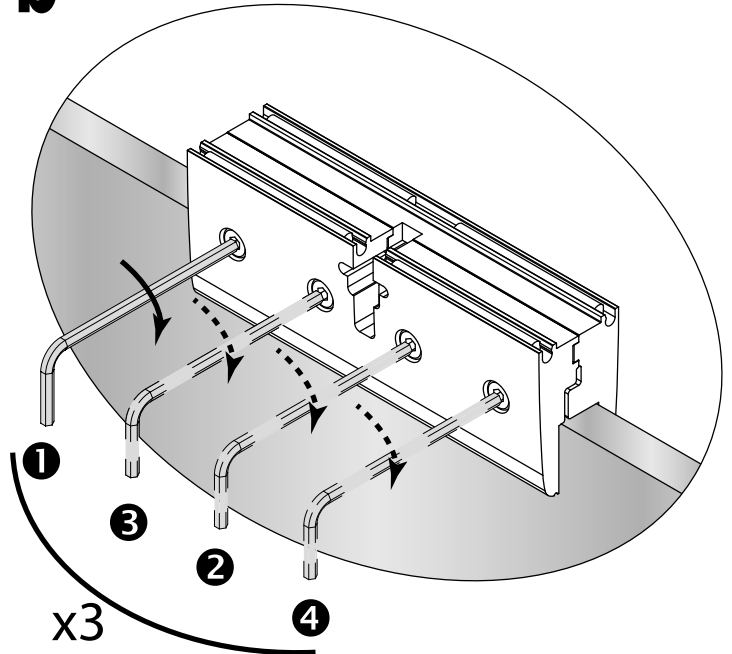

60

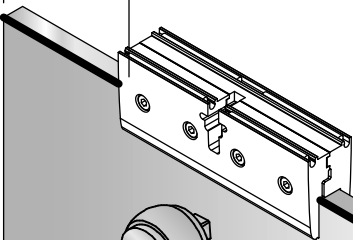

9 N.m

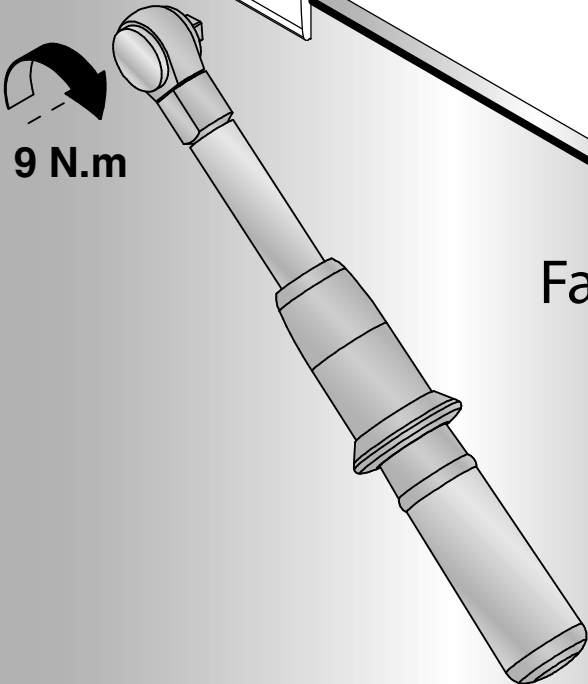

Face 1

60

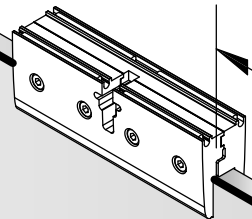

# INSTALLATION / MONTAGE / ASSEMBLY / MONTAJE

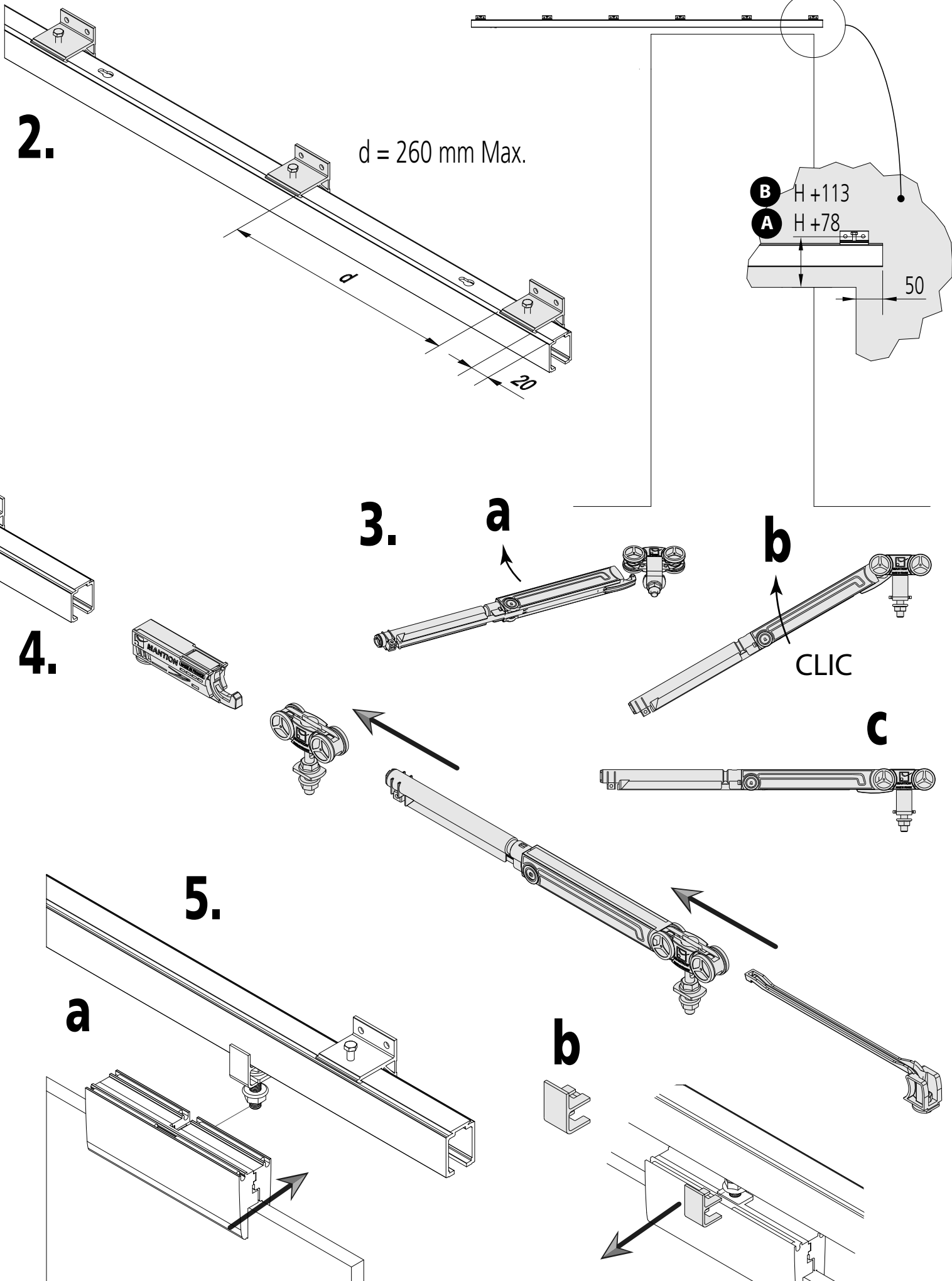

6.

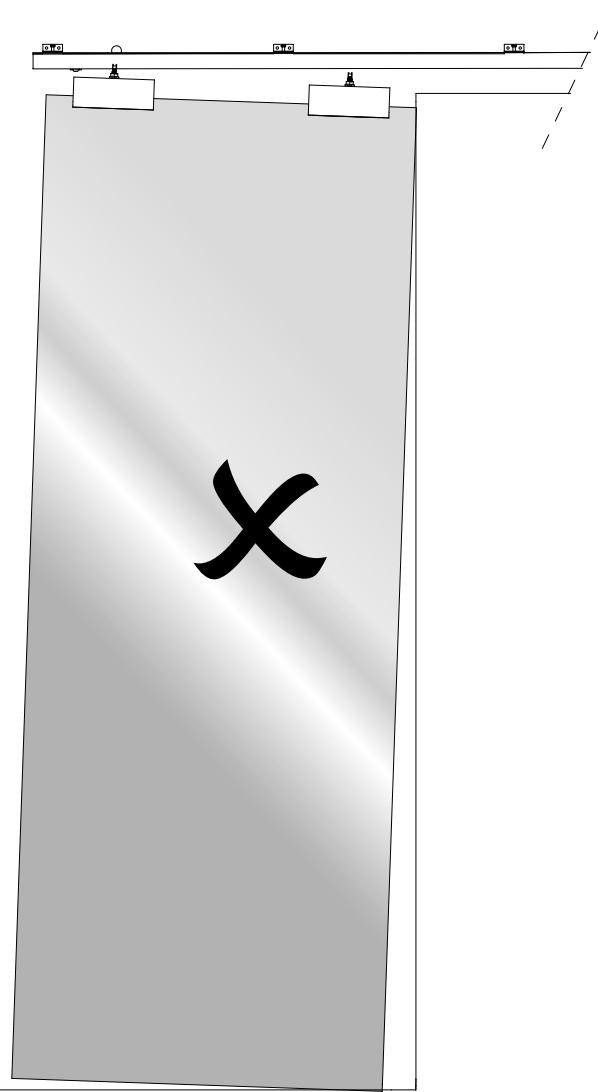
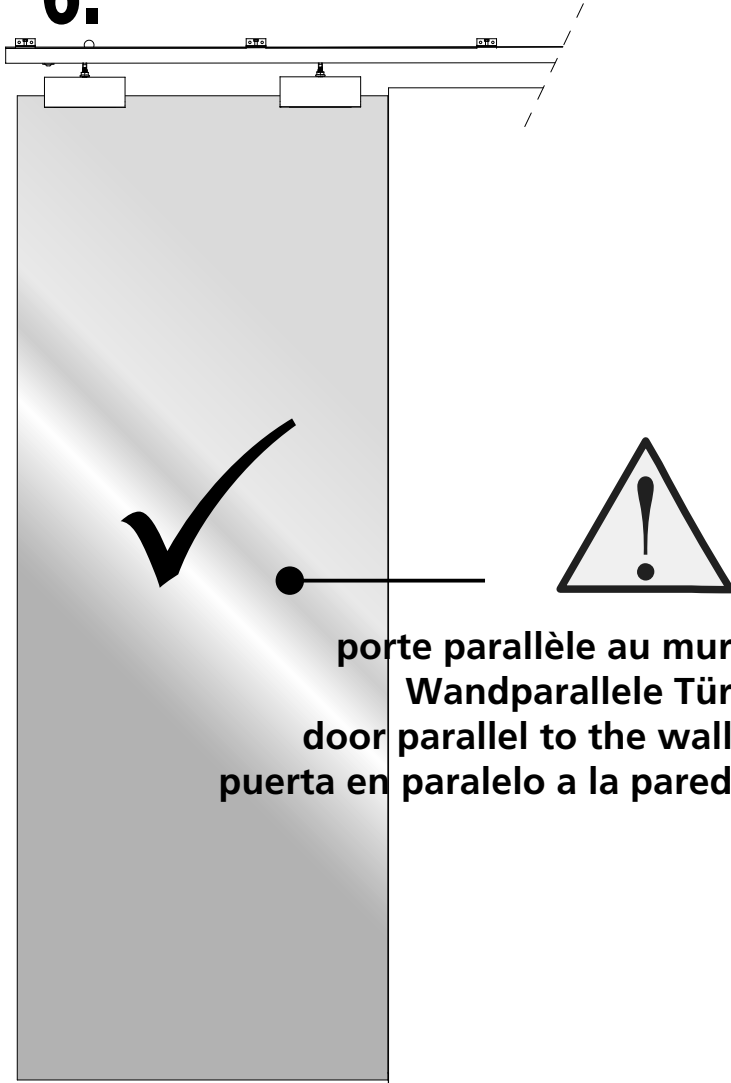

6.1 Réglage  
Einstellung  
Adjustment  
Ajuste

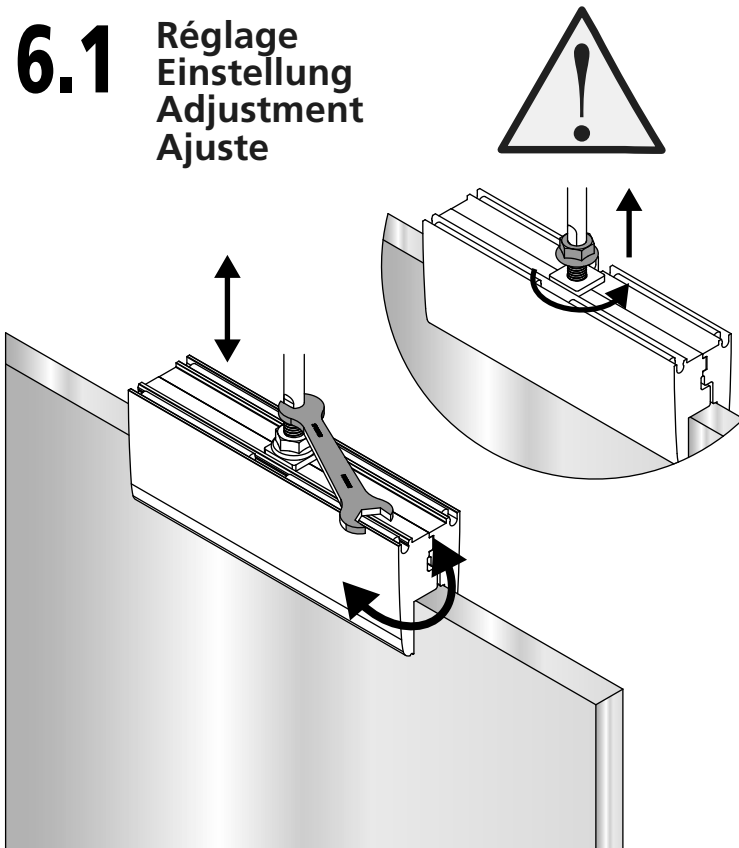

6.2 Serrage  
Klemmen  
Fitting  
Apriete

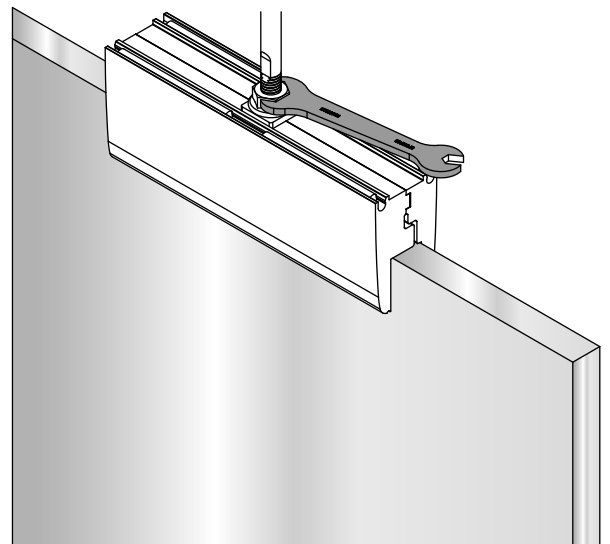

7.

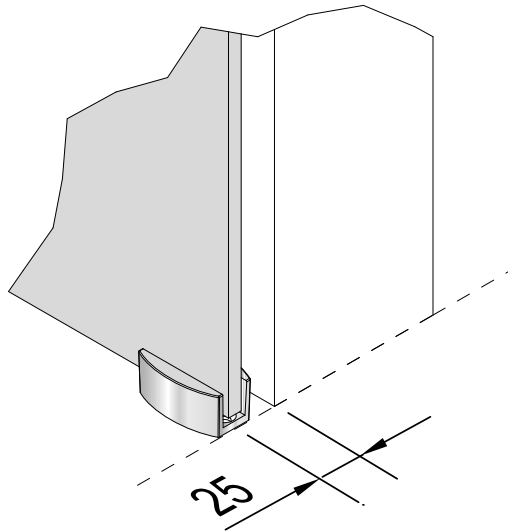

8.

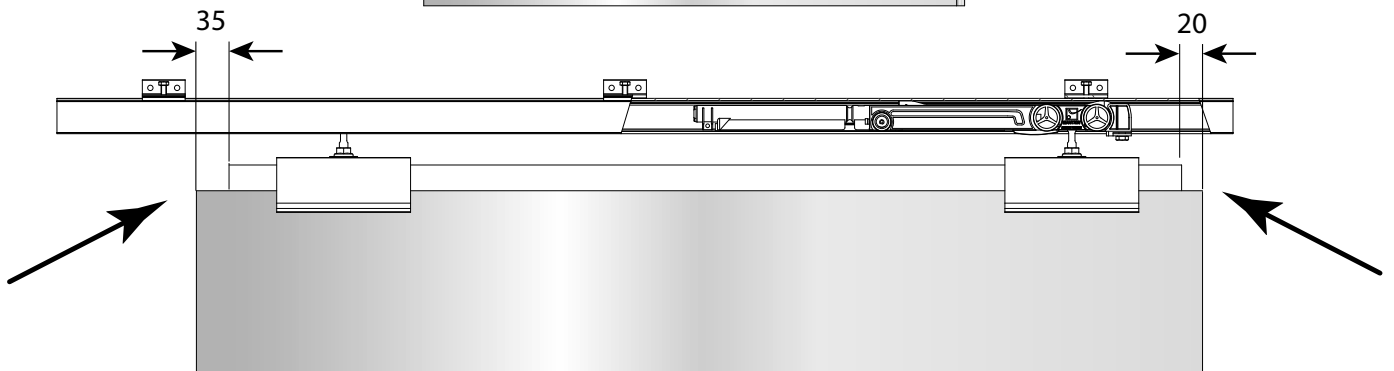
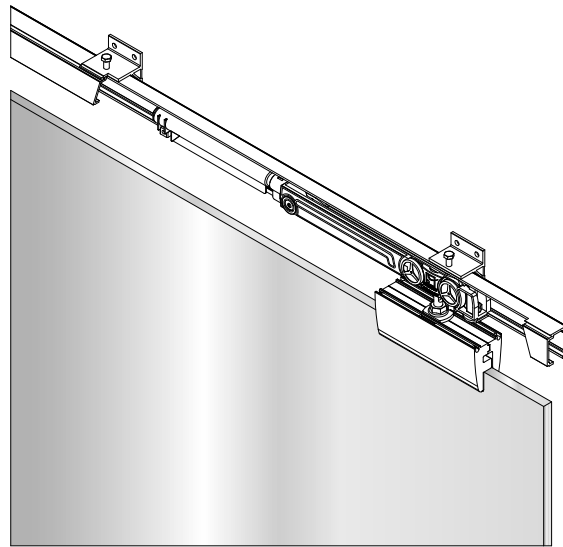
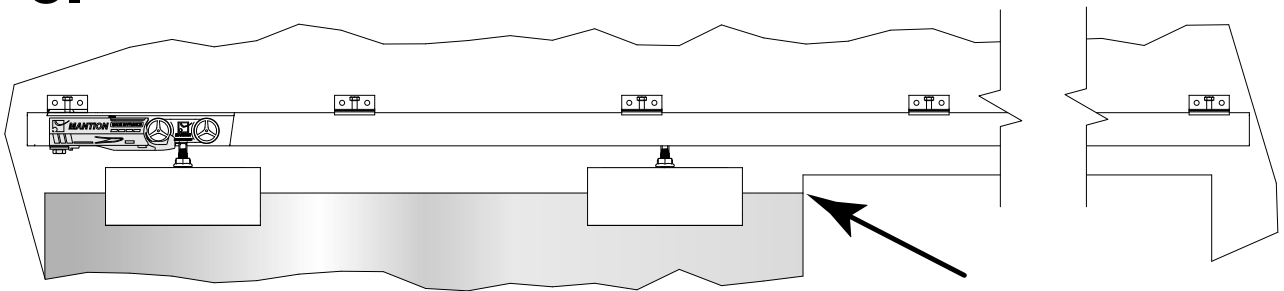

9.

ou  
oder  
or  
o

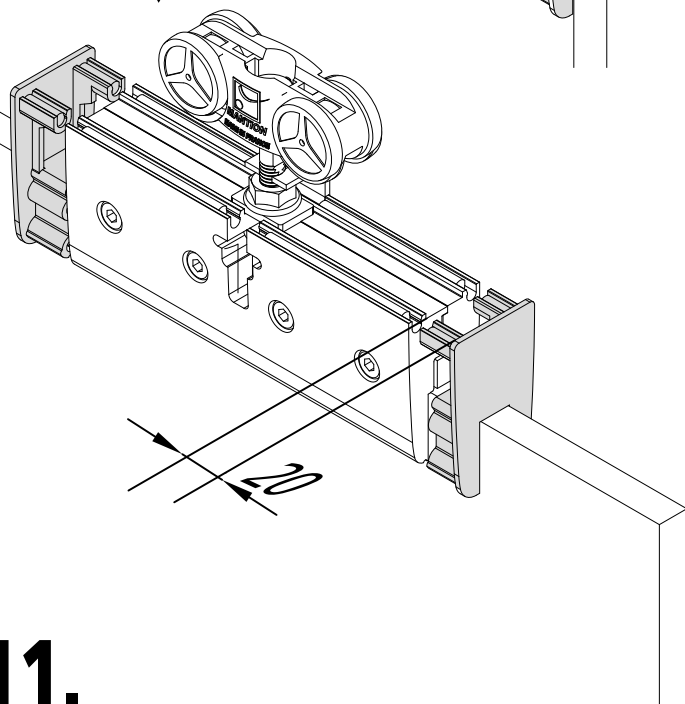
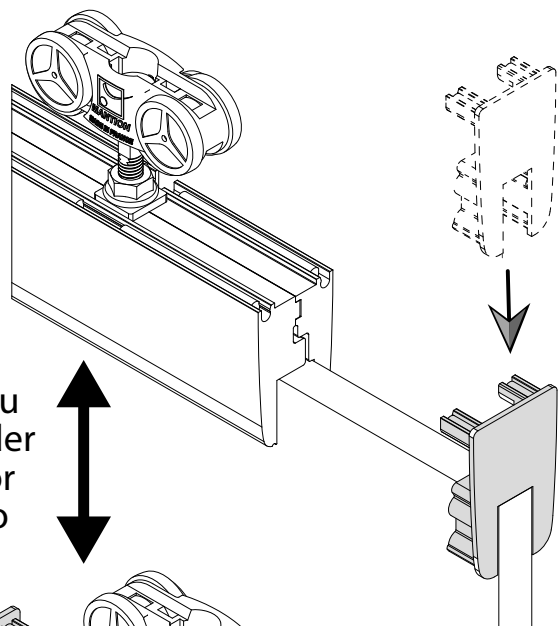

10.

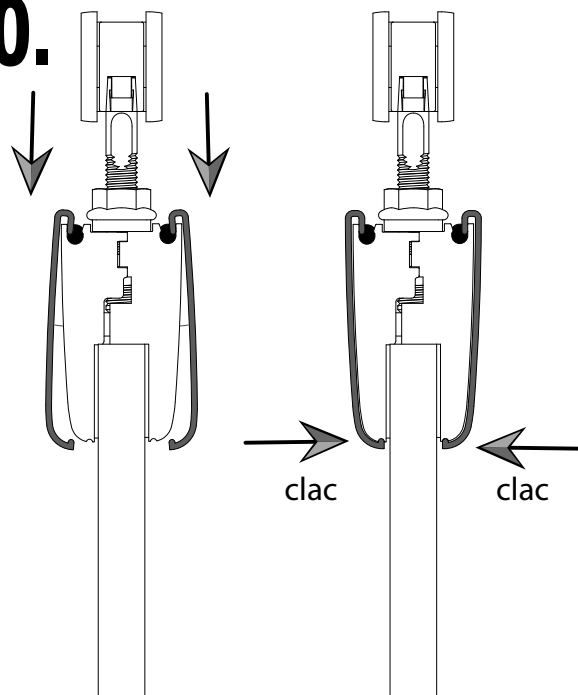

11.

